

# DEFINING RUGGED

EXCEPTIONAL ENGINEERING | ROCK SOLID | EXTENSIVE TESTING

## LOW PROFILE BRACKET

Placement	Weight	Height	Width	Depth
Any <b>Vehicle Base</b> without a welded pole	0.8 lbs	1.5"	3.0"	6.6"

### Features:

- Heavy gauge steel construction for long-term durability
- Black powdercoat finish for maximum corrosion resistance
- Positions equipment low to the floor
- Hardware for attaching to *MCS Top Plate* included
- Is not compatible with the following **Vehicle Bases** (Item No. DS-52, DS-53, DS-56, DS-57, DS-100, DS-138, 7160-0090, 7160-0116, 7160-0133, 7160-0198 or 7160-0248)

Item No. **ABF-KIT**

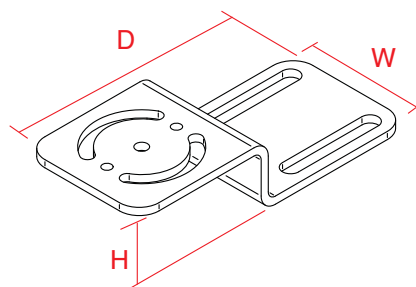

3001 Borham Ave. | Stevens Point, WI 54481, USA  
Phone: 715.344-3482 | Toll-free: 800.487-9220 | Fax: 715.344-5209  
Email: [gamberj@gamberjohnson.com](mailto:gamberj@gamberjohnson.com) | Website: [www.gamberjohnson.com](http://www.gamberjohnson.com)

This document, including images, may not be reproduced partly or fully without the expressed written consent of Gamber-Johnson's Marketing Department. © Copyright 2012 Gamber-Johnson LLC