



Very Well Connected™

# INSTALLATION INSTRUCTIONS

<b><u>Product</u></b> 7160-0397, 7160-0427, 7160-0452	<b><u>Revision</u></b> Rev. D	<b><u>Form</u></b> INST-614
<b>MONGOOSE LOCKING SLIDE ARMS - W/O CLEVIS</b> <b>Printing Spec: PS-004</b>		



## WARNING



- You must read and follow all of these installation instructions. Failure to follow all of these installation instructions may result in serious bodily injury or death.
- Do not install or use this product in the area in which the airbag on the vehicle will be deployed if it is activated. The installer and user of this product is responsible for installing and using it outside the area in which an airbag will be deployed if activated. (See Product Mounting Disclaimer Below)
- Keep these installation instructions with the product and readily available in the vehicle for future reference of other users of the product.
- Additional copies of the installation instructions can be obtained from Gamber-Johnson. If you need assistance or have any questions, call Gamber-Johnson at 1-800-456-6868.

### Installation:

The Mongoose Locking Slide Arms mount directly to a Center Upper Pole or other type of mounting equipment that contains a Gamber-Johnson swivel pattern cutout.

To mount on a Center Upper Pole or other type of mounting equipment that contains a Gamber-Johnson swivel pattern cutout, set the arm on the mount so the 1/4-20unc studs protrude through the curved cutouts. Two studs should protrude through one of the cutouts and one stud should protrude through the opposite cutout. Attach with the flanged lock nuts that are supplied. (See Figure 1.)

#### Product Mounting Disclaimer

Gamber-Johnson is not liable under any theory of contract or tort law for any loss, damage, personal injury, special, incidental or consequential damages for personal injury or other damage of any nature arising directly or indirectly as a result of the improper installation or use of its products in vehicle or any other application. In order to safely install and use Gamber-Johnson products full consideration of vehicle occupants, vehicle systems (i.e., the location of fuel lines, brakes lines, electrical, drive train or other systems), air-bags and other safety equipment is required. Gamber-Johnson specifically disclaims any responsibility for the improper use or installation of its products not consistent with the original vehicle manufactures specifications and recommendations, Gamber-Johnson product instruction sheets, or workmanship standards as endorsed through the Gamber-Johnson Certified Installer Program.

© Copyright 2019 Gamber-Johnson, LLC

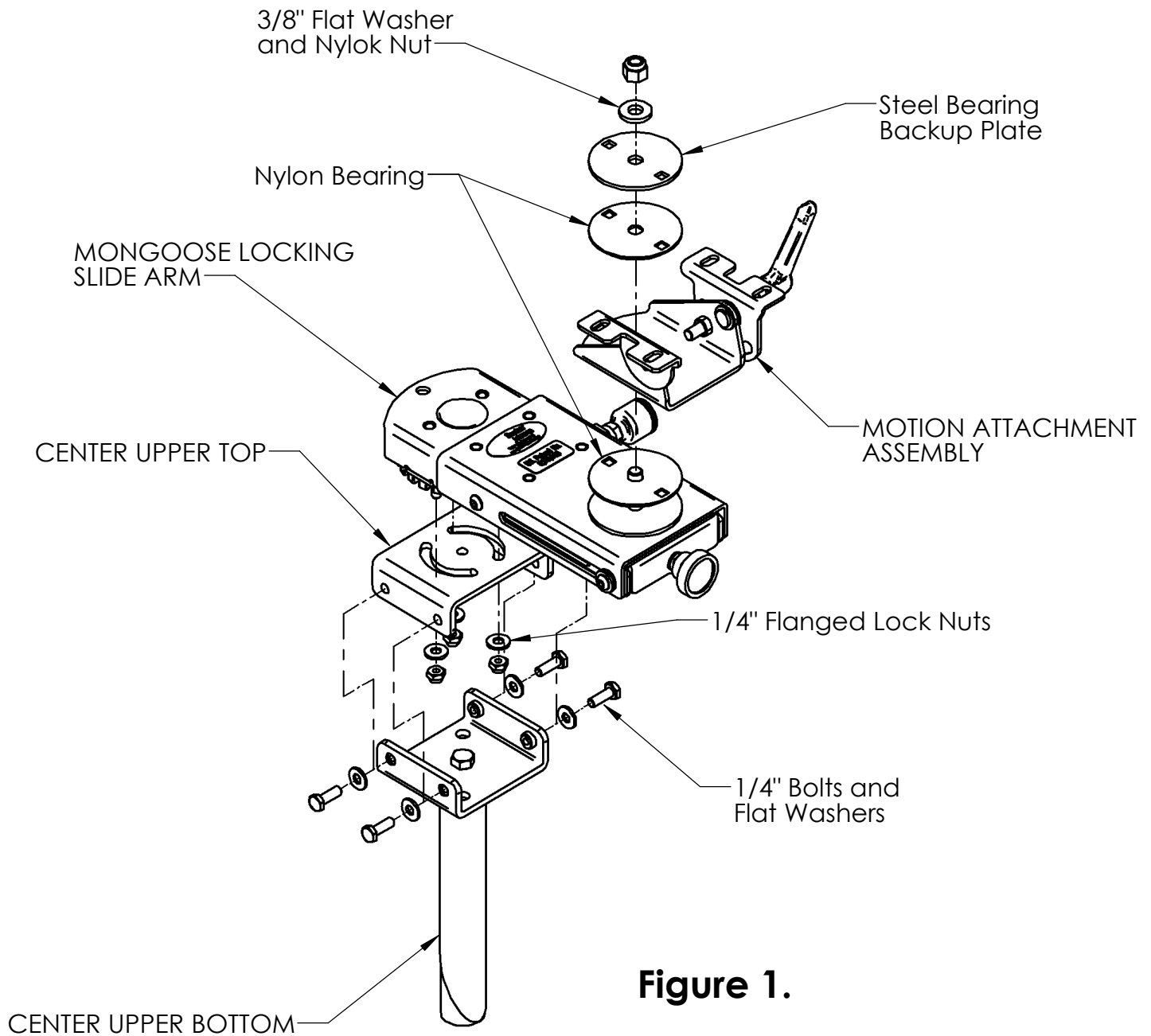

**Figure 1.**

**Attaching a Motion Attachment to the Mongoose Locking Slide Arm 7160-0397, 7160-0427, 7160-0452**

Various Motion Attachments with a .38" mounting hole can be added to the Mongoose Locking Slide Arm. To attach, place one of the bearing backup plates on the 3/8" stud. Next place the motion attachment over the stud. Place the remaining bearing, bearing backup plate and 3/8" flat washer over the stud. Apply thread locker to the stud and tighten the nylok nut until the desired friction is obtained. (See Figure 1.)

## How to use the Mongoose Locking Slide Arm:

The Mongoose Locking Slide Arm is designed to accommodate four motions of adjustment. The first being a 360 degree swivel that is actuated by the front handle. Pulling out on the handle releases the gear latch located in the base and allows the mount to swivel. To latch the arm in place, position the arm in the desired location and release the spring loaded handle. Wiggle the arm back and forth to make sure the handle has engaged the teeth on the gear.

The second motion is the slide. To actuate the slide, pull out and hold the spring loaded pin. Pull the mount forward a minimum of 1/2" before releasing the pin to ensure the mount does not latch back in the stowed position. Once you have released the pin, pull forward on the mount until it is located in the desired position.

The third motion is the motion attachment swivel. The motion attachment can swivel 360 degrees.

The fourth motion is the tilt. The amount will vary depending on the type of motion attachment.

**Note: Do not use this product if the latch mechanism is disabled or missing. The product should be out of the airbag zone with the slide in the latched position when the vehicle is in use.**

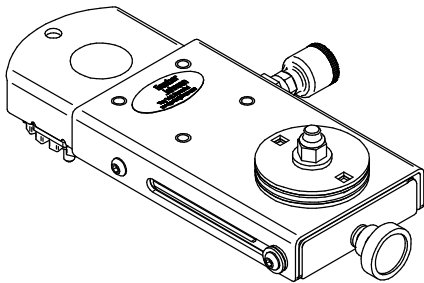

7160-0397

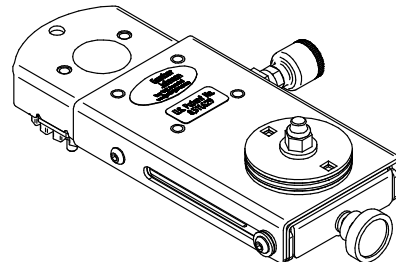

7160-0427

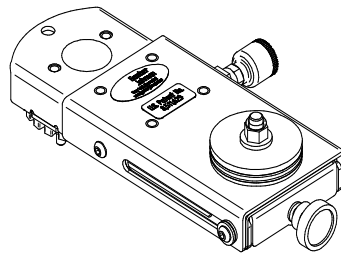

7160-0452



• This product should not be positioned in the area where the airbag will be deployed if it is activated. **DO NOT** position the equipment in front of an airbag. Equipment positioned in front of an airbag can cause serious injury or death if an airbag was activated, such as in an accident.

• If installation of the equipment requires that the equipment be placed in front of an airbag, deactivate the airbag in the vehicle so it cannot be activated in an accident. In order to secure permission for deactivating the airbag in these circumstances, contact the National Highway Traffic Safety Administration at 1-800-424-9393 to gain permission to do so. If you have any questions or need assistance, call Gamber-Johnson at 1-800-456-6868.

## Hole Template

Please use this template below when drilling to mount. Ensure that when printing it is done to a 1:1 scale.

