



# INSTALLATION INSTRUCTIONS

**Product****7160-1034, 7160-1035****Revision**

Rev.A

**Form**

INST-809

**ZIRKONA MAX3 TO GJ ADAPTERS****Printing Spec:PS-001****7160-1034, To Install:**

1. If attaching to a top plate use the 1/4-20 carriage bolts, washers and nuts included in the hardware bag. With the carriage bolts through the plate and facing upward start the nuts. Drop the carriage bolt heads through the keyhole slots in the top plate and tighten.
2. If attaching to a vehicle base or riser use the 3/8-16 carriage bolts, washers and nuts included in the hardware bag.
3. Attach the male threaded Zirkona MAX3 accessory to the adapter plate threaded coupling.

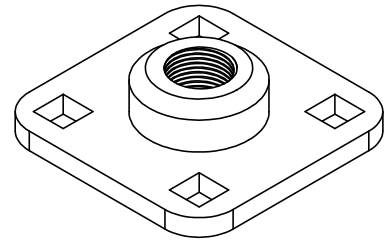
**7160-1034****ZIRKONA MAX3 TO GJ ADAPTER PLATE****7160-1035, To Install:**

1. Place the studs through the top plate or accessory that features a 3 bolt hole or 'smiley face' bolt pattern.
2. Install the washers and lock nuts included in the hardware bag and tighten.
3. Attach the male threaded Zirkona MAX3 accessory to the adapter plate threaded coupling.

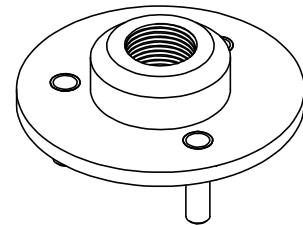
**7160-1035****ZIRKONA MAX3 TO 3 STUD GJ ADAPTER PLATE****Product Mounting Disclaimer**

Gamber-Johnson is not liable under any theory of contract or tort law for any loss, damage, personal injury, special, incidental or consequential damages for personal injury or other damage of any nature arising directly or indirectly as a result of the improper installation or use of its products in vehicle or any other application. In order to safely install and use Gamber-Johnson products full consideration of vehicle occupants, vehicle systems (i.e., the location of fuel lines, brakes lines, electrical, drive train or other systems), air-bags and other safety equipment is required. Gamber-Johnson specifically disclaims any responsibility for the improper use or installation of its products not consistent with the original vehicle manufactures specifications and recommendations, Gamber-Johnson product instruction sheets, or workmanship standards as endorsed through the Gamber-Johnson Certified Installer Program.

© Copyright 2017 Gamber-Johnson, LLC

If you need assistance or have questions, call Gamber-Johnson at 1-800-456-6868