



INSTALLATION INSTRUCTIONS

Product

7160-1566/7170-0848-XX - Standard Console
7160-1566-01/7170-0864-XX - Console with Printer Mount

Revision

D

Form

INST-1008

Printing Spec: PS-005

2021+ Chevrolet Tahoe PPV/SSV Widebody Console

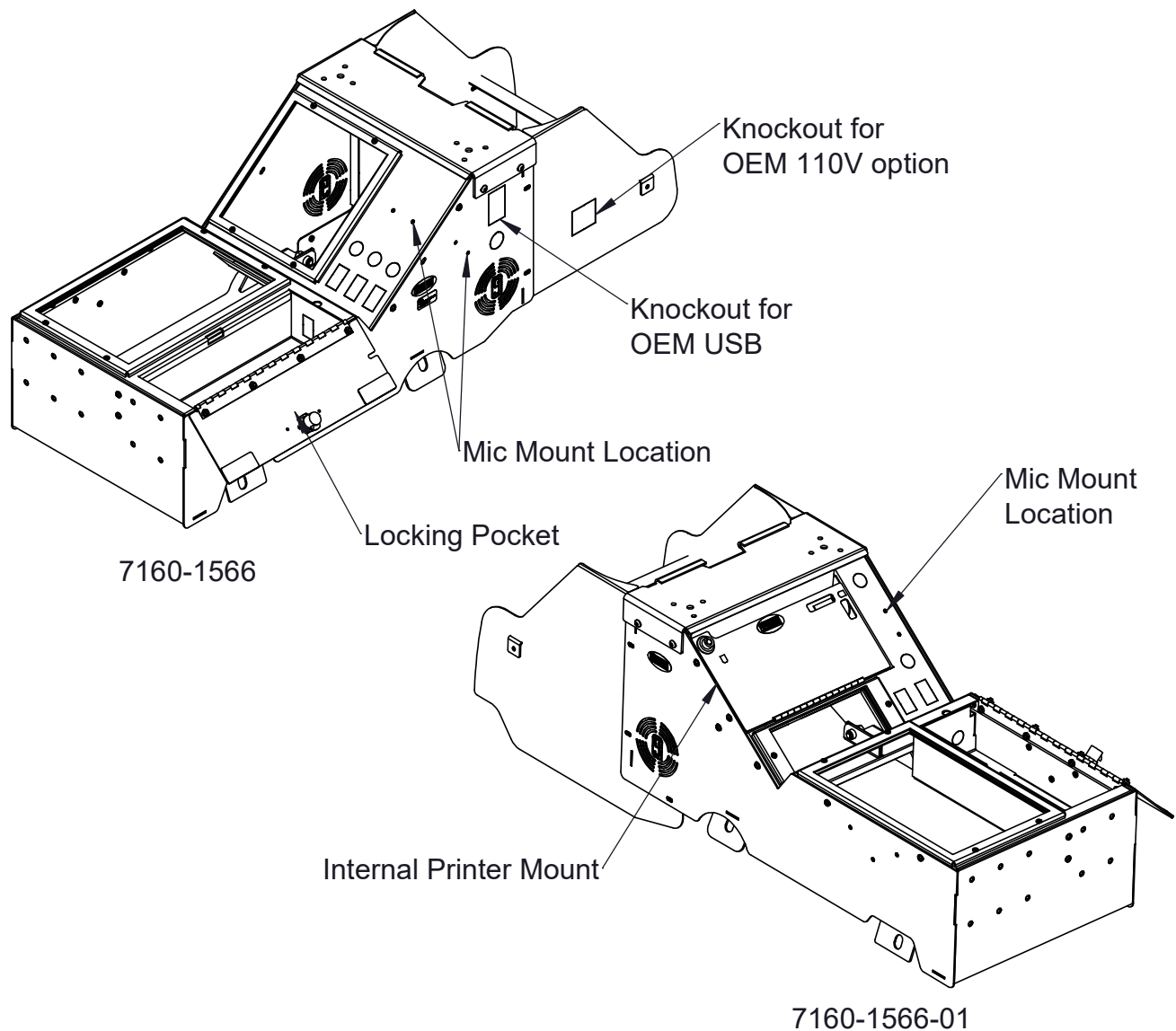

Product Mounting Disclaimer

Gamber-Johnson is not liable under any theory of contract or tort law for any loss, damage, personal injury, special, incidental or consequential damages for personal injury or other damage of any nature arising directly or indirectly as a result of the improper installation or use of its products in vehicle or any other application. In order to safely install and use Gamber-Johnson products full consideration of vehicle occupants, vehicle systems (i.e., the location of fuel lines, brake lines, electrical, drive train or other systems), air-bags and other safety equipment is required. Gamber-Johnson specifically disclaims any responsibility for the improper use or installation of its products not consistent with original vehicle manufactures specifications and recommendations, Gamber-Johnson product instruction sheets, or workmanship standards as endorsed through the Gamber-Johnson Certified Installer Program.

© Copyright 2021 Gamber-Johnson, LLC

If you need assistance or have questions, call Gamber-Johnson at 1-800-456-6868

ITEM	QTY	PartNo	DESCRIPTION
1	1	19578	CONSOLE - 2021+ TAHOE WIDEBODY
2	1	18103	F150 REAR AREA BRACKET
3	1	18104	F150 SLOPED AREA BRACKET
4	1	17080	HINGE
5	1	18116	F150 CONSOLE LID
6	1	18125	F150 REAR OPENING HOLD DOWN FRAME
7	1	18126	F150 SLOPED AREA HOLD DOWN
8	2	14710	1.00 X 2.50 X .062 THK PORON PAD
9	1	11893	LOCK - DIRAK 264-9006
10	2	9000-0043	DUAL LOCK - .50 WIDE, BLACK, HIGH DENSITY SIDE
11	1	9000-0046	DUAL LOCK - .50 WIDE, BLACK, LOW DENSITY SIDE
12	2	19594	LEG - FRONT MOUNT, 2021 TAHOE WIDEBODY CONSOLE
13	1	19605	POCKET - 2021 TAHOE WIDEBODY CONSOLE
14	1	19606	TOP PLATE - 2021 TAHOE WIDEBODY CONSOLE
15	1	19620	COVER WING - 2021+ TAHOE CONSOLE DRIVER SIDE
16	1	19665	COVER PLATE - 2021+ TAHOE CONSOLE PASSENGER SIDE
17	1	19716	BRACE - 14" WIDE CONSOLE WING SUPPORT
23	1	7120-0974	HARDWARE BAG - 2021+ CHEVY TAHOE LEG KIT
27	2	14500	EDGE TRIM - .18 GAP, BLACK RUBBER
28	1	7120-0641	HARDWARE BAG - WIRE CHASE - TAHOE CONSOLE

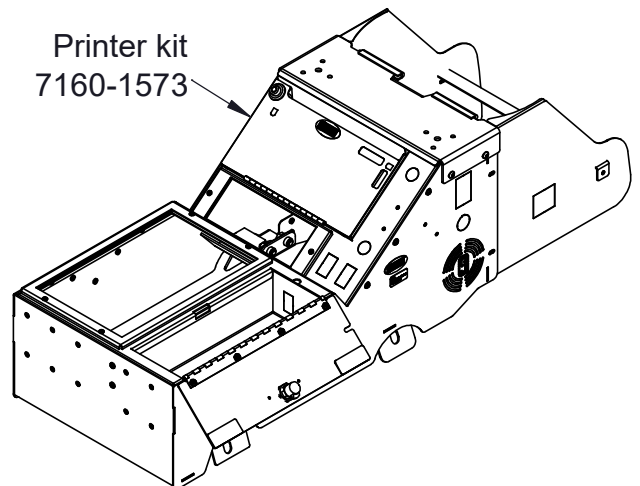
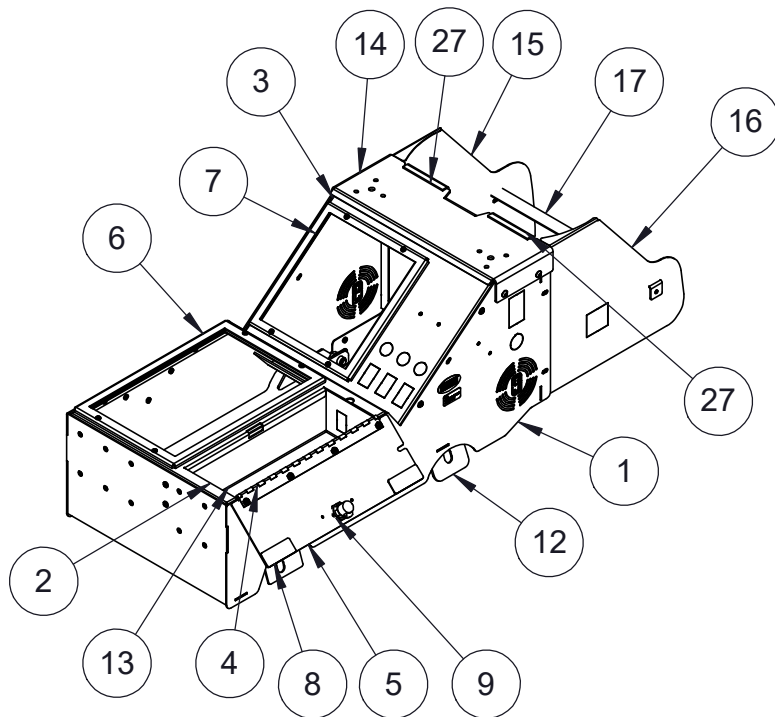

Install

1. Remove OEM center seat by removing four bolts with an 18mm socket as shown in Fig 1. Keep bolts for reuse. Disconnect any electrical harness.

*If vehicle has OEM 110V plug, it can be relocated to the passenger side wing.



Figure 1

2. Relocate OEM USB.

*Remove the lower center console trim by removing the bolt in the driver side footwell with a 7mm socket and pulling trim rearward (Figure 2).

*Remove trim on either side of the infotainment screen with a panel tool.

*Using a 7mm socket, remove bolts from behind the trim and 1 bolt by the passenger side fuse box (under side cover).

*Remove the trim panel from around the climate control (unplug ignition switch).

*Partially remove trim panel below steering wheel to expose and remove two bolts (7mm socket) retaining lower trim panel.

*Pull rearward on USB/12V trim panel to remove (trim is held on by clips).

*Disconnect the harness (Figure 2) .

Note: Gamber-Johnson does not recommend relocating the OEM 12V socket from the dash into the console due to a potential electrical short that may damage the vehicle electronics (Ref. GM TSB PIT5800)



Figure 2

3. With the trim loose, behind the trim remove the push in clips holding the harness to gain more length then reinstall the center trim pieces. Install the USB housing on passenger side of console (Figure 3).



Figure 3

4. Set the console in place and align 4 mounting holes on the console with OEM seat holes.

***If the Vehicle was specified with the OEM console or center seat delete option, mounting holes will require tapping with an M12-1.75 tap.**

*Before installing seat bolts, attach driver side wings to the console (with provided #10 hardware) (Figure 4).



Figure 4

5. With the wings in place, the console can be attached to the vehicle with the OEM hardware (Figure 5). Torque bolt to OEM specs.

*Front 2 legs in the console can be loosened for adjustment if needed. Tighten after adjustment.

6. With console in place, the passenger side wings and the wing brace can be installed with provided #10 hardware.

*If vehicle has the front 110V plug, it can be installed in knockout on the passenger side wing.



Figure 5

7. Console install is complete and it can be outfitted as required. Figure 6 shows a typical installation.



Figure 6

Optional Equipment:

7160-1573 Printer mount can be added to 7160-1566 console.

Note: 7160-1573 Printer Mount will occupy 5" of mounting space.

