



# INSTALLATION INSTRUCTIONS

## Product

7160-1433

SCANNER POCKET

## Revision

Rev B

## Form

INST-937

Printing Spec: PS-001

This instruction sheet is for mounting the Gamber-Johnson scanner (7160-1433) to a Zirkona joiner with an AMP's mounting plate (7160-1261).

## Mounting the device

1. Attach the scanner pocket to the Zirkona Joiner by removing the (2) #10 flat washers and lock nuts on the back side of the scanner pocket.
2. The scanner pocket can hold a scanner with a head thickness of 2.50" high x 4.50" wide. The pocket width is pre-set at 3.50" wide but can be adjusted to accommodate scanners up to 4.50" wide by loosening the (3) lock nuts, adjusting to the desired width and re-tightening the lock nuts.
3. Adjust the Zirkona Joiner to hold the scanner pocket in the desired location.

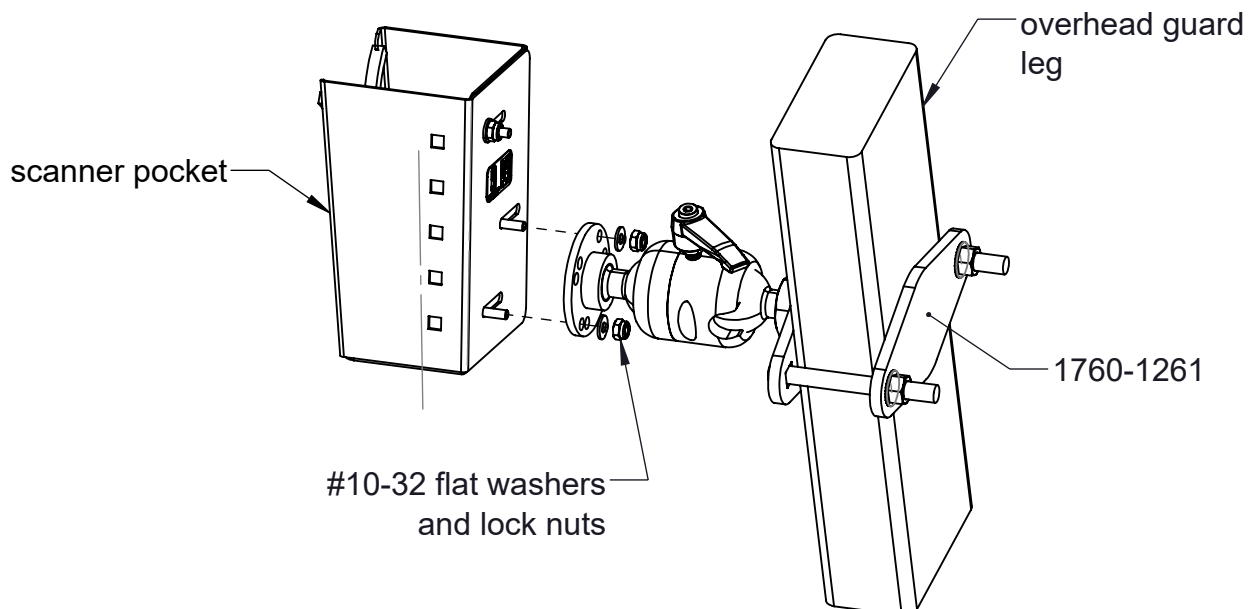

### Product Mounting Disclaimer

Gamber-Johnson is not liable under any theory of contract or tort law for any loss, damage, personal injury, special, incidental or consequential damages for personal injury or other damage of any nature arising directly or indirectly as a result of the improper installation or use of its products in vehicle or any other application. In order to safely install and use Gamber-Johnson products full consideration of vehicle occupants, vehicle systems (i.e., the location of fuel lines, brake lines, electrical, drive train or other systems), air-bags and other safety equipment is required. Gamber-Johnson specifically disclaims any responsibility for the improper use or installation of its products not consistent with original vehicle manufactures specifications and recommendations, Gamber-Johnson product instruction sheets, or workmanship standards as endorsed through the Gamber-Johnson Certified Installer Program.

© Copyright 2024 Gamber-Johnson, LLC

If you need assistance or have questions, call Gamber-Johnson at 1-800-456-6868