

INSTALLATION INSTRUCTIONS

Product

7160-0088 VEHICLE LEG KIT

DODGE CHARGER (2006+)
DODGE MAGNUM (2006-2008)

Revision

Rev B

Form

INST-347

Printing Spec: PS-001

The purpose of this instruction sheet is to illustrate the manufacturer's recommended method of installation for the Dodge Charger Mission Control System kit that includes front and rear anchor legs (p/ns 13236 & 13237) and a hardware bag.

1. If the vehicle has a top plate and anchor legs supplied by the vehicle manufacturer, begin by removing them. Keep the hardware, you will use it to attach the Gamber-Johnson Dodge Charger Front and Rear Anchor Legs (p/ns 13236 & 13237). If there is no hardware use the four M6 x 1.00 nuts for the front leg and the two 1/4-14 sheet metal screw for the rear leg. The hardware is found in hardware bag 7120-0409.

2. Next, remove the plastic console cover (see FIG. 3). Notice that there are a total of six threaded studs on the transmission hump of the vehicle (in some models the rear leg gets fastened via two threaded holes and bolts). Place the REAR ANCHOR LEG on the two rearmost threaded studs, or over the threaded holes, oriented so that the VERTICAL FLANGE (see FIG. 1) is towards the front of the vehicle. Otherwise, it will be difficult to fasten the hardware for the Gamber-Johnson Top Plate. The FRONT ANCHOR LEG will sit on the four threaded studs nearest the dashboard of the vehicle. See FIG. 2 for an illustration of how both the FRONT and REAR ANCHOR LEGS will appear when mounted correctly.

3. Place the washers and nuts on the threaded studs and tighten. This completes the installation of the Dodge Charger Leg Kit.

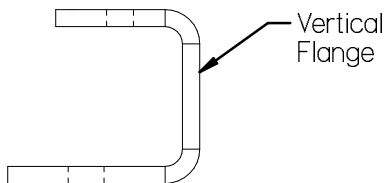

FIG. 1
Dodge Charger Rear
Anchor Leg (p/n 13236)

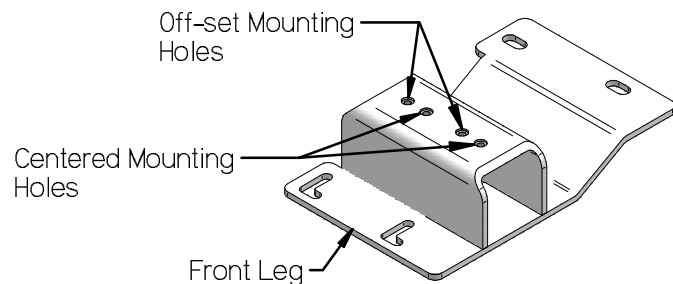
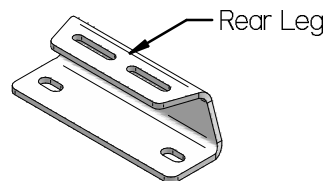

FIG. 2
Dodge Charger Leg Kit
(7160-0007)

Product Mounting Disclaimer

Gamber-Johnson is not liable under any theory of contract or tort law for any loss, damage, personal injury, special, incidental or consequential damages for personal injury or other damage of any nature arising directly or indirectly as a result of the improper installation or use of its products in vehicle or any other application. In order to safely install and use Gamber-Johnson products full consideration of vehicle occupants, vehicle systems (i.e., the location of fuel lines, brakes lines, electrical, drive train or other systems), air-bags and other safety equipment is required. Gamber-Johnson specifically disclaims any responsibility for the improper use or installation of its products not consistent with the original vehicle manufactures specifications and recommendations, Gamber-Johnson product instruction sheets, or workmanship standards as endorsed through the Gamber-Johnson Certified Installer Program.

©Copyright 2012 Gamber-Johnson, LLC

If you need assistance or have questions, call Gamber-Johnson at 1-800-456-6868

4. Notice that there are four self-clinching nuts on the Front Leg. There is a sensor that is mounted between the Front and Rear Legs. The mounting holes nearest the passenger's side of the vehicle are centered which are designed to fit the GJ Wide Top Plate (p/n 7160-0085 or 7160-0086). The off-centered holes are designed to fit the standard Top Plate (p/n MCS-PLATE-S or MCS-PLATE-L). Use the hardware bag included (p/n 7120-0409) to attach the Top Plate.

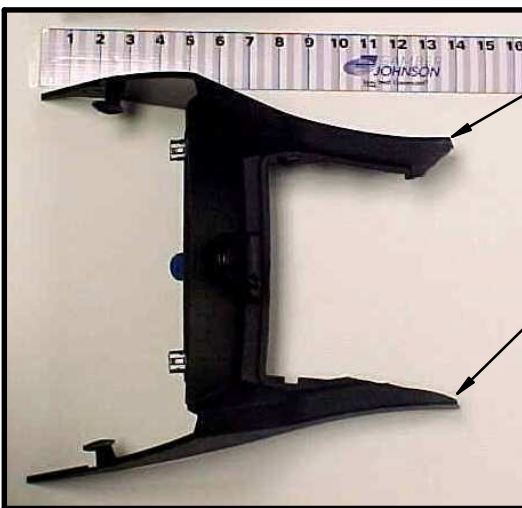

FIG. 3
Dodge Charger Plastic Console Cover
before and after modification

5. It will be necessary to modify the Plastic Console Cover removed in Step 1 before replacing it in the vehicle. Cut the cover just in front of the opening as shown in FIG. 3.

6. The overall length of the modified Plastic Console cover should be approximately 14 inches (see FIG. 4).

7. Trim the edge of the Plastic Console cover in one of the suggested ways in FIG. 4.



If edge is trimmed like this it will align on top of the Top Plate

If edge is trimmed like this it will align next to the Top Plate

FIG. 4
Modified Dodge Charger Plastic Console Cover