



# INSTALLATION INSTRUCTIONS

## Product

7160-1854

CONSOLE, FORD LIGHTNING 2022+

## Revision

Rev B

## Form

INST-1137

Printing Spec: PS-001

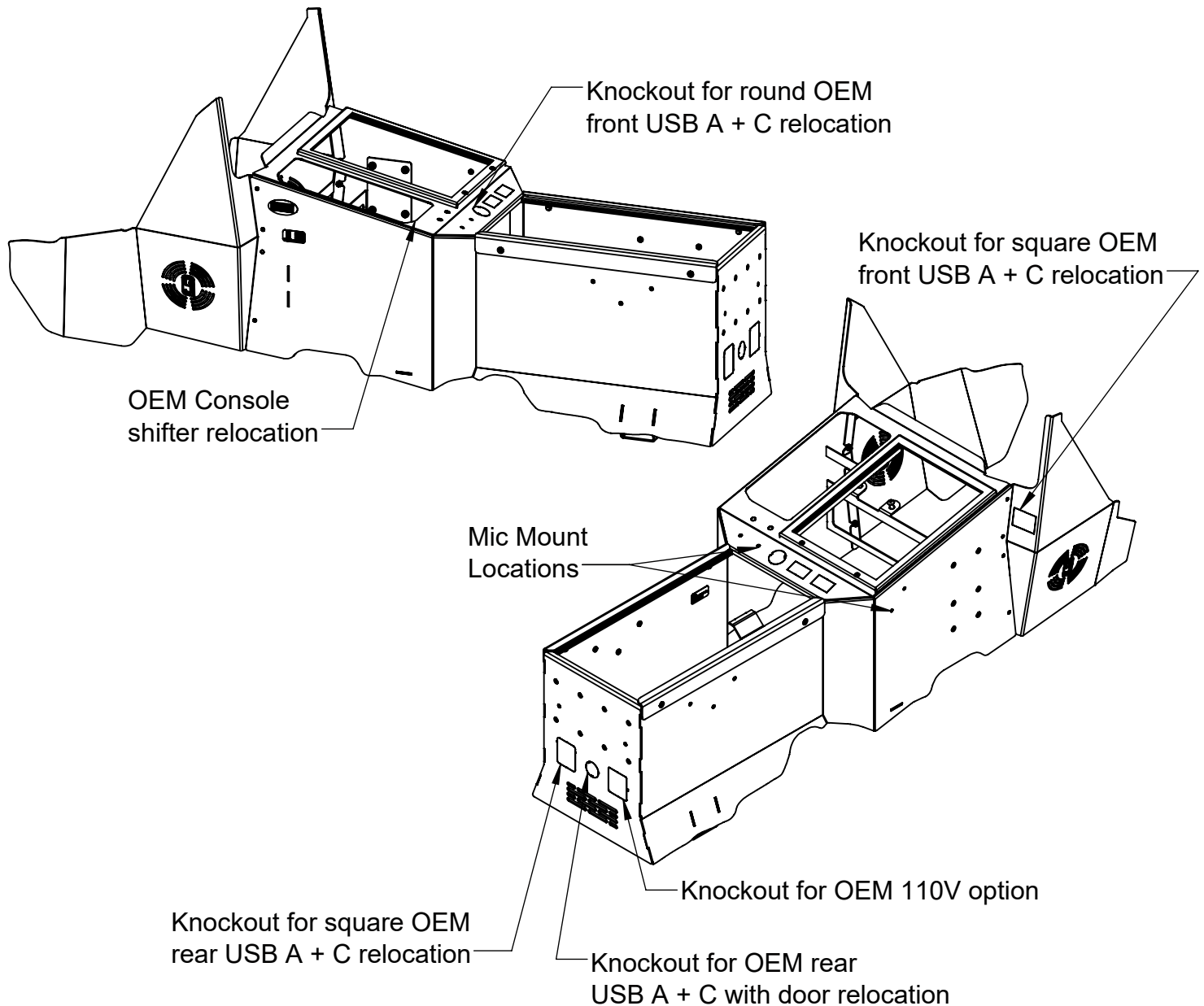

### Product Mounting Disclaimer

Gamber-Johnson is not liable under any theory of contract or tort law for any loss, damage, personal injury, special, incidental or consequential damages for personal injury or other damage of any nature arising directly or indirectly as a result of the improper installation or use of its products in vehicle or any other application. In order to safely install and use Gamber-Johnson products full consideration of vehicle occupants, vehicle systems (i.e., the location of fuel lines, brake lines, electrical, drive train or other systems), air-bags and other safety equipment is required. Gamber-Johnson specifically disclaims any responsibility for the improper use or installation of its products not consistent with original vehicle manufactures specifications and recommendations, Gamber-Johnson product instruction sheets, or workmanship standards as endorsed through the Gamber-Johnson Certified Installer Program.

© Copyright 2023 Gamber-Johnson, LLC

If you need assistance or have questions, call Gamber-Johnson at 1-800-456-6868

| ITEM | QTY | PartNo     | DESCRIPTION                                       |
|------|-----|------------|---|
| 1    | 1   | 20880      | CONSOLE WELDMENT LIGHTNING 2022+                  |
| 2    | 21  | 9000-0043  | DUAL LOCK - .50 WIDE, BLACK, HIGH DENSITY SIDE    |
| 3    | 32  | 9000-0043  | DUAL LOCK - .50 WIDE, BLACK, HIGH DENSITY SIDE    |
| 4    | 21  | 9000-0046  | DUAL LOCK - .50 WIDE, BLACK, LOW DENSITY SIDE     |
| 5    | 32  | 9000-0046  | DUAL LOCK - .50 WIDE, BLACK, LOW DENSITY SIDE     |
| 6    | 1   | 20881      | HOLDDOWN PICTURE FRAME                            |
| 7    | 2   | 14738      | HOLDDOWN - 16.5"                                  |
| 8    | 4   | 10016-0002 | #10-32 x .375 PFH82MS FS-014                      |
| 9    | 2   | 1163-0808  | #8-32 x 0.500 PPHMS FS-014                        |
| 10   | 1   | 7120-1126  | HARDWARE BAG, CONSOLE FORD LIGHTNING              |
| 11   | 1   | 20886      | COVER PANEL FWD DS FORD LIGHTNING 2022            |
| 12   | 1   | 20889      | COVER PANEL FWD PS FORD LIGHTNING 2022            |
| 13   | 8   | 1503-0800  | #8-32 NUT NYLOK FS-014                            |
| 18   | 1   | INST-1117  | INSTRUCTION SHEET - QR CODE INST SHEET DIRECTIONS |

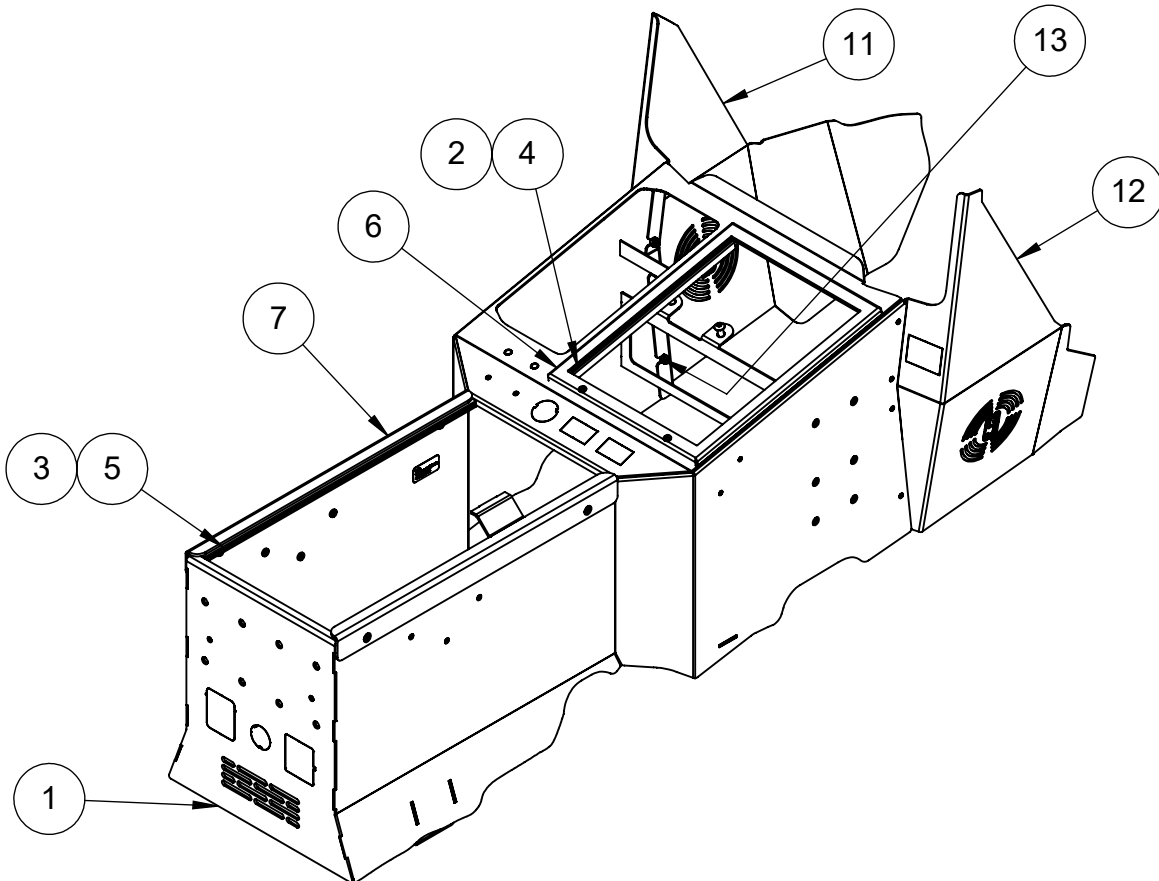



Note:

- i. Disconnect battery and all electrical power before starting
- ii. Passenger seat may be removed to aid in console removal

1. Remove Center Console and Mounting Brackets:

- a. Unplug two harness connections on the passenger's side (PS) between console and PS seat.
- b. On both the driver's side (DS) and the PS of the console, remove silver upper console-to-dash trim panels (Fig 1a). Remove 7mm screw (present only on DS; see blue rectangle Fig 1b.).



Figure 1a.



Figure 1b.

- c. Remove lower gray panels from both PS and DS (Fig 1c.) This will expose six (6) M6 OEM mounting screws (Fig 1d. shows (2) on DS; not shown are (1) on DS in the rear, and (3) on PS).
- d. Remove (6) M6 screws, slide the console back slightly, and disconnect remaining 2 harness plugs at front of console. Console can now be removed from vehicle.
- e. Remove (2) OEM mounting brackets, but retain the (4) M12 screws as they will be reused.

\*\*If vehicle is equipped with a center HVAC vent it is recommended that this vent be covered using aluminum flashing tape.



Figure 1c.

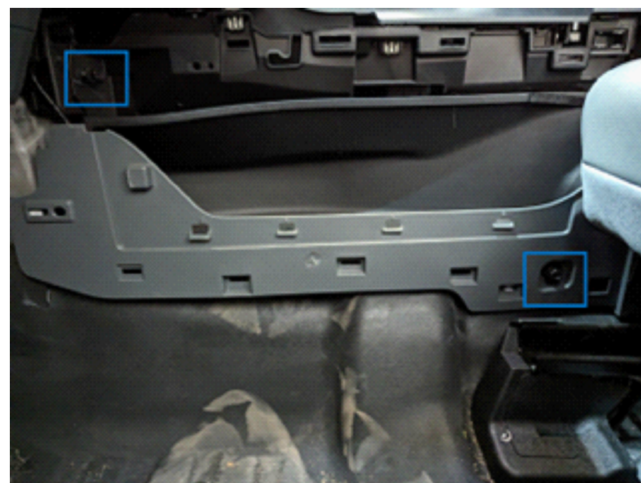

Figure 1d.

2. Remove OEM console shifter from console:

- a. Remove rubber tray liner and small plastic access panel from bottom of shifter garage, exposing 1 of 4 mounting screws.
- b. Remove trim panel from top of shifter and cupholder, exposing 3 remaining shifter mounting screws, and remove 4 mounting screws, gently remove shifter, and unplug from harness (Fig 2a, 2b, 2c)
- c. Remove (2) nuts securing key transponder module to underside of cupholder (Fig 2d).
- d. Remove OEM harness from console. The LED light strips may remain installed, as they will not be reused. If any plugs are desired to be relocated in GJ console, remove those as well.



Figure 2a.



Figure 2b.



Figure 2c.

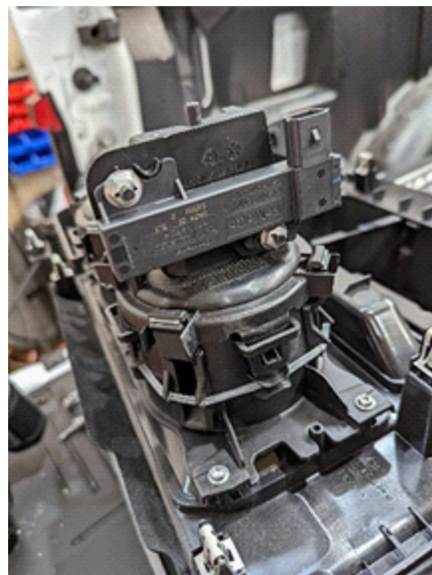

Figure 2d.



3. Console Installation:

- a. Pull OEM wiring harness plugs toward the center of the transmission hump so they terminate inside the console when installed (Fig 3a.)
- b. Loosely install shifter mounting bracket (20890) to console using (2) 1/4-20 nylock nuts from hardware bag.
- c. Set the console in place and align 4 mounting holes on the console with center console bracket holes. Thread, but do not tighten (4) M12 screws removed in step 1e.
- d. Plug in OEM wiring harness and plug shifter in prior to installing.

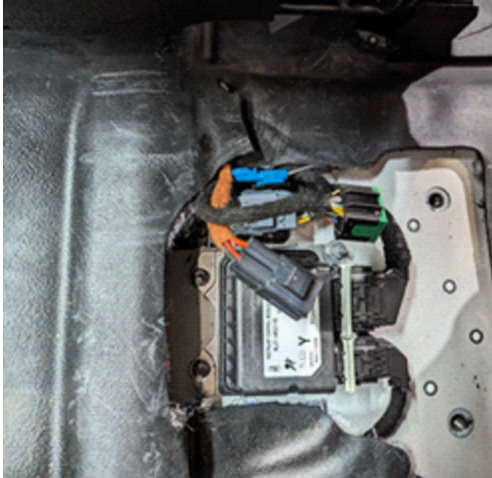

Figure 3a.



Figure 3b.

- e. Gently slide shifter onto front mounting bracket; align with cutout on top plate and secure using (4) 1/4 - 20 button head screws from hardware bag.
- f. Install key transponder using VHB (21249) from hardware bag to front of shifter housing (Fig 3b/3c).
- g. Install OEM USB and 110V module in appropriate knockouts if desired.
- h. Align slots on wings with studs on console, setting wings into approximate position
- i. Align console and wings to best fit vehicle trim, tighten (4) M12 mounting bolts, and tighten (8) #8 nylock nuts to secure the console and wings (Fig 3d).
- j. Reconnect all installed OEM USB/Power modules to wiring harness.
- k. Ensure all mounting points are tightened and electrical connections are remade.
- l. Console installation is complete, and the console can be outfitted as required.



Figure 3c.



Figure 3d.