



# INSTALLATION INSTRUCTIONS

**Product**

7160-1035  
ZIRKONA TO GJ ADAPTER

**Revision**

REV. D

**Form**

INST-809

Printing Spec: PS-001

**To Install:**

1. Place the studs through the top plate or accessory that features a 3 bolt hole or 'smiley face' bolt pattern.
2. Install the included flanged lock nuts and tighten.
3. Attach the male threaded Zirkona accessory to the adapter plate threaded coupling.

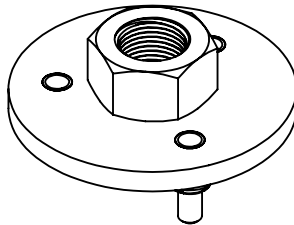

**7160-1035**  
ZIRKONA TO 3 STUD GJ ADAPTER PLATE

**Product Mounting Disclaimer**

Gamber-Johnson is not liable under any theory of contract or tort law for any loss, damage, personal injury, special, incidental or consequential damages for personal injury or other damage of any nature arising directly or indirectly as a result of the improper installation or use of its products in vehicle or any other application. In order to safely install and use Gamber-Johnson products full consideration of vehicle occupants, vehicle systems (i.e., the location of fuel lines, brakes lines, electrical, drive train or other systems), air-bags and other safety equipment is required. Gamber-Johnson specifically disclaims any responsibility for the improper use or installation of its products not consistent with the original vehicle manufactures specifications and recommendations, Gamber-Johnson product instruction sheets, or workmanship standards as endorsed through the Gamber-Johnson Certified Installer Program.

© Copyright 2017 Gamber-Johnson, LLC

If you need assistance or have questions, call Gamber-Johnson at 1-800-456-6868