



INSTALLATION INSTRUCTIONS

Product

7160-1634
7160-1633/7170-0893-XX
7160-2038/7170-1164-XX

Revision

D

Form

INST-1038

Printing Spec: PS-005

Description: 2021+ Chevrolet Tahoe PPV/SSV
Standard Width Console

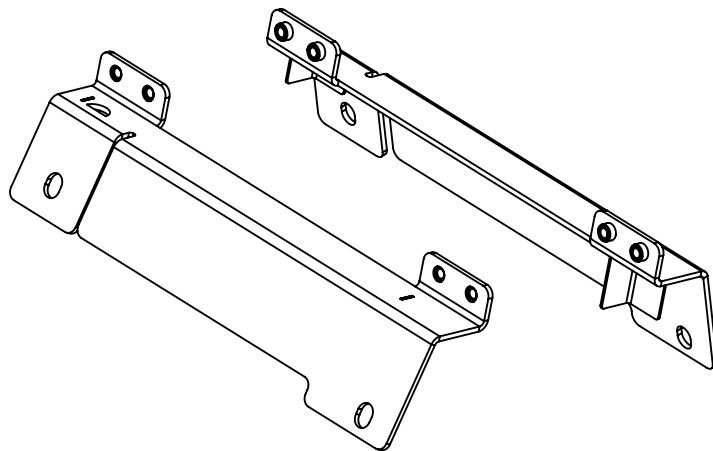

7160-1634 Leg Kit

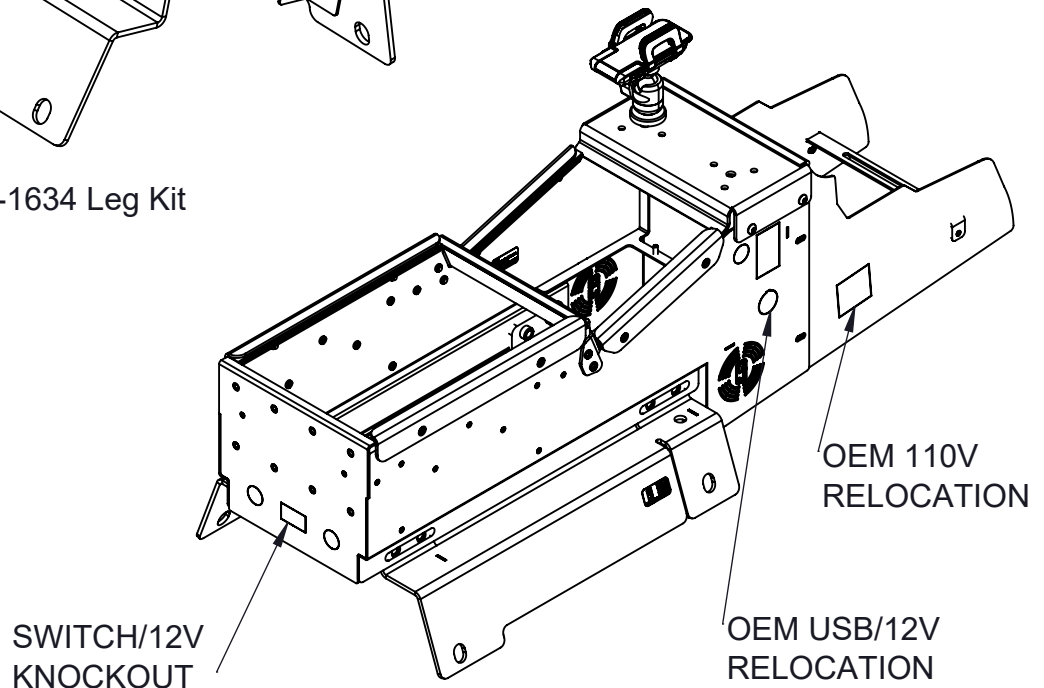

7170-0893-00 Kit

Product Mounting Disclaimer

Gamber-Johnson is not liable under any theory of contract or tort law for any loss, damage, personal injury, special, incidental or consequential damages for personal injury or other damage of any nature arising directly or indirectly as a result of the improper installation or use of its products in vehicle or any other application. In order to safely install and use Gamber-Johnson products full consideration of vehicle occupants, vehicle systems (i.e., the location of fuel lines, brake lines, electrical, drive train or other systems), air-bags and other safety equipment is required. Gamber-Johnson specifically disclaims any responsibility for the improper use or installation of its products not consistent with original vehicle manufactures specifications and recommendations, Gamber-Johnson product instruction sheets, or workmanship standards as endorsed through the Gamber-Johnson Certified Installer Program.

© Copyright 2021 Gamber-Johnson, LLC

If you need assistance or have questions, call Gamber-Johnson at 1-800-456-6868

ITEM	QTY	PartNo	DESCRIPTION
1	1	19092	PLATE - 2021+ TAHOE LEG KIT DRIVER SIDE
2	1	19090	LEG - 2021+ TAHOE PASSENGER SIDE
4	1	7120-0974	HARDWARE BAG - 2021+ CHEVY TAHOE LEG KIT
5	1	7120-0039	HARDWARE BAG - LEG KIT
6	1	INST-1117	INSTRUCTION SHEET - QR CODE INST SHEET DIRECTIONS
7	1	PL-0002	LABEL - QR CODE INST SHEET

ITEM	QTY	PartNo	DESCRIPTION
1	1	19116	CONSOLE - 2021+ TAHOE STD WIDTH
2	1	15224	TOP PLATE - TAHOE CONSOLE BOX
3	1	19941	PLATE - SPREADER 2021+ TAHOE STD WIDTH CONSOLE
4	15	9000-0043	DUAL LOCK - .50 WIDE, BLACK, HIGH DENSITY SIDE
5	24	9000-0046	DUAL LOCK - .50 WIDE, BLACK, LOW DENSITY SIDE
6	2	11482	HOLDDOWN - 7.38"
7	2	12991	HOLDDOWN 12.25"
8	8.5	14500	EDGE TRIM - .18 GAP, BLACK RUBBER
9	1	19945	WING - 2021+ TAHOE STD CONSOLE PASSENGER SIDE
10	1	19946	COVER WING - 2021+ TAHOE STD WIDTH CONSOLE DRIVER SIDE
11	1	16105	WINGS, TAHOE 2015+ SUPPORT BRACE
12	1	15081	LABEL - PATENT NO. & ASSEMBLY DATE
13	4	12305-0001	1/4-20 x .500 SBHS-NP FS-014
14	8	10016-0002	#10-32 x 0.375 PFH82MS FS-014
15	4	1122-1006	#10-32 x 0.375 PPHMS FS-014
17	1	7120-1153	HARDWARE BAG - 2021+ TAHOE STD WIDTH CONSOLE
20	1	16828	LABEL - GJ and GAMBER-JOHNSON LOGO, 2.25" x 0.75"
21	1	PL-0002	LABEL - QR CODE INST SHEET
22	1	INST-1117	INSTRUCTION SHEET - QR CODE INST SHEET DIRECTIONS

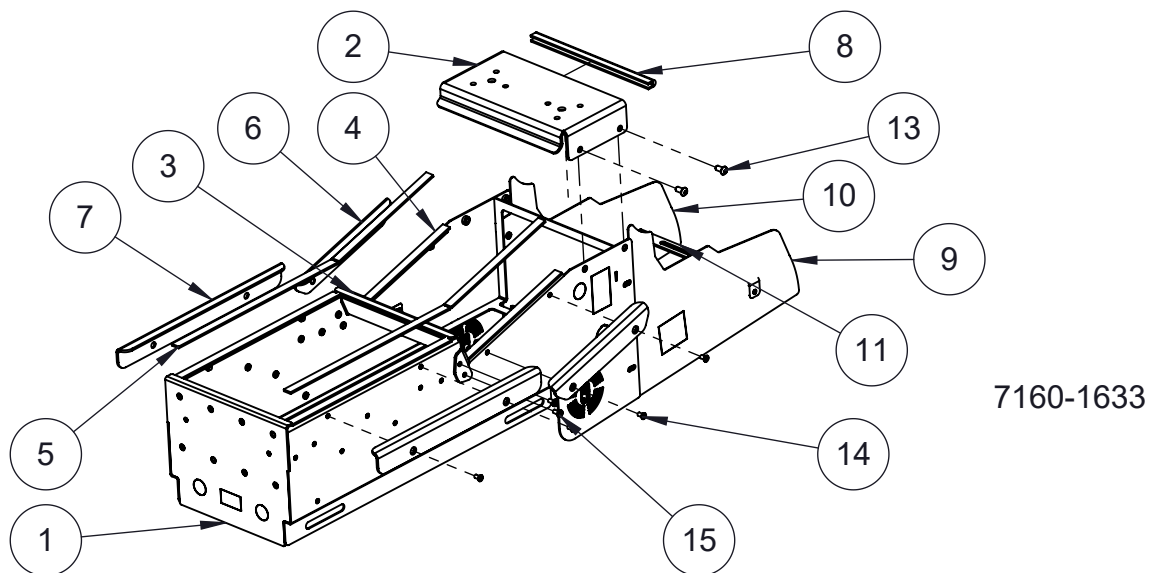

7160-1634 LEG KIT INSTALL:

1. Remove OEM center seat by removing four bolts with an 18mm socket as shown in Figure1. Keep bolts for reuse. Disconnect any electrical harnesses.



Figure 1

2. Relocate OEM USB & 12V. Remove the lower center console trim by removing the bolt in the driver side footwell with a 7mm socket and pulling trim rearward (Figure 2). Remove trim on either side of the infotainment screen with a panel tool. Using a 7mm socket, remove bolts from behind the trim and 1 bolt by passenger side fuse box (under side cover). Remove the trim panel from around the climate control (unplug ignition switch). Partially remove trim panel below steering wheel to expose and remove two bolts (7mm socket) retaining lower trim panel. Pull rearward on USB/12V trim panel to remove (trim is hold on by clips). Disconnect the harnesses (Figure 2).



Figure 2

3. Place leg kit on the transmission tunnel and attach with OEM seat bolts, (if vehicle is not equipped with OEM center seat, leg kit can be attached with provided M12 hardware) torque bolts to OEM spec. Depending on trim level, OEM mounting holes may come unthreaded. In this case use a 12mm x 1.75 tap to thread holes.

Note: For easier installation, do not tighten leg kit to vehicle hardware until top plate or console has been installed.

Figure 3

4. If installing Tahoe specific consoles, see page 5. If installing a universal console, attach top plate to the leg kit with provided 3/8" hardware. Then attach the universal console to the top plate as specified in the installation instructions provided with the console box.

Figure 4

5. Once the leg kit is installed, place the Tahoe specific console over the leg kit and attach with provided 3/8" hardware.

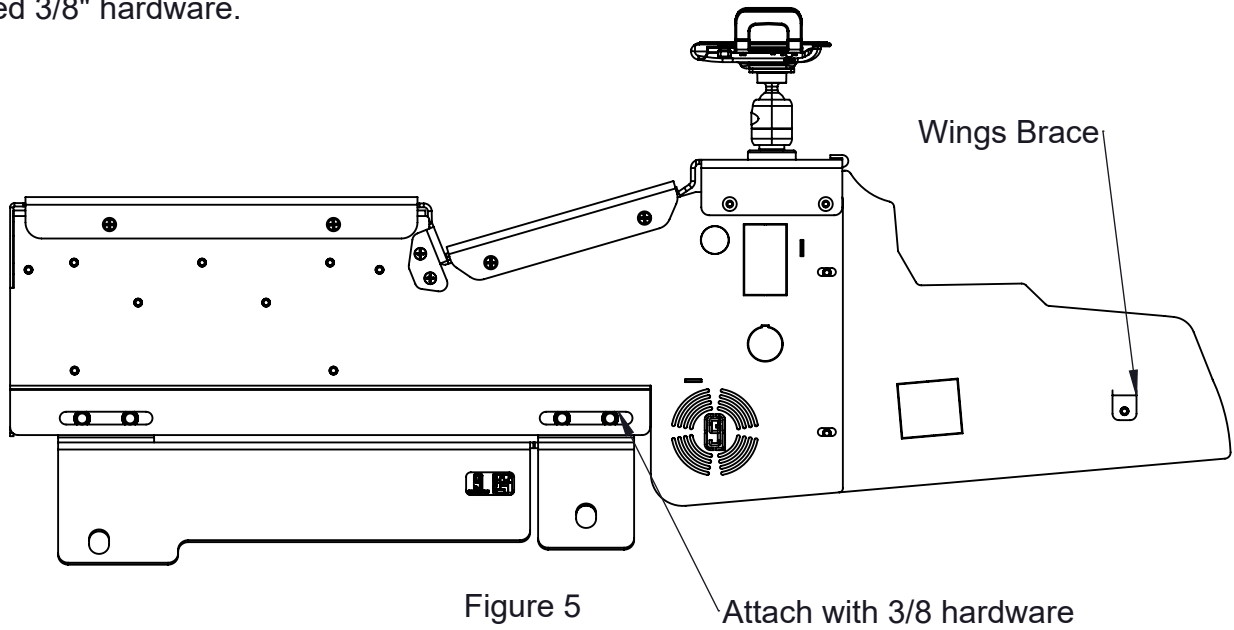

6. Install the cover wings and support brace with provided #10 hardware.

Figure 6

Optional - 7160-1010 can be installed on the console to support a tablet and keyboard setup.

Figure 7