



INSTALLATION INSTRUCTIONS

Product

7170-0942, 7170-0942-01

SUCTION CUP MOUNT WITH DASH SUPPORT AND DOGBONE

Revision

Rev A

Form

INST-1083

Printing Spec: PS-001



WARNING

- You must read and follow all of these installation instructions. Failure to follow the installation instructions may result in serious bodily injury or death.
- DO NOT install or use the 7170-0942 assemblies in the area in which the airbag on the vehicle may be deployed. The installer and user of the 7170-0942 assemblies are responsible for installing and using the 7170-0942 assemblies outside the area in which an airbag may be deployed. (See Product Mounting Disclaimer Below)
- High speed vehicle turns may cause parts of the assembly to swivel, interfering with the driver or other equipment.
- If installation of the equipment requires that the equipment be placed in front of an airbag, the airbag should be deactivated. In order to secure permission for deactivating the airbag you must contact the National Highway Traffic Safety Administration at 1-800-424-9393 to gain permission to do so.
- Keep these installation instructions with the product and readily available in the vehicle for future reference of the users of the product.
- Additional copies of the installation instructions can be obtained from Gamber-Johnson. If you need assistance or have any questions, call Gamber-Johnson at 1-800-456-6868.



Product Mounting Disclaimer

Gamber-Johnson is not liable under any theory of contract or tort law for any loss, damage, personal injury, special, incidental or consequential damages for personal injury or other damage of any nature arising directly or indirectly as a result of the improper installation or use of its products in vehicle or any other application. In order to safely install and use Gamber-Johnson products full consideration of vehicle occupants, vehicle systems (i.e., the location of fuel lines, brake lines, electrical, drive train or other systems), air-bags and other safety equipment is required. Gamber-Johnson specifically disclaims any responsibility for the improper use or installation of its products not consistent with original vehicle manufactures specifications and recommendations, Gamber-Johnson product instruction sheets, or workmanship standards as endorsed through the Gamber-Johnson Certified Installer Program.

© Copyright 2021 Gamber-Johnson, LLC

If you need assistance or have questions, call Gamber-Johnson at 1-800-456-6868

Assembling the kit

7170-0942 ships with the round AMPs mounting plate
7170-0942-01 ships with the 75mm Vesa mounting plate

The kit is shipped unassembled. The kit has multiple extensions to vary the length of the mount. Attach the components by screwing each piece together as shown below. The 150mm (6") and 100mm (4") extensions are optional. You can use neither, one, or both of these extensions based on the vehicle you are mounting into. The length from the windshield to the front of the dash will determine which extensions (if any) you will need. A spanner wrench has been included with the kit to help tighten the extensions if needed. Slide the grommet stanchion (found in hardware bag 7120-1011) onto the extensions before attaching the dogbone to the end. Once the length of the mount is determined Gamber-Johnson suggests using thread locking epoxy (loctite #EA9460 or equivalent) to lock the components in place.

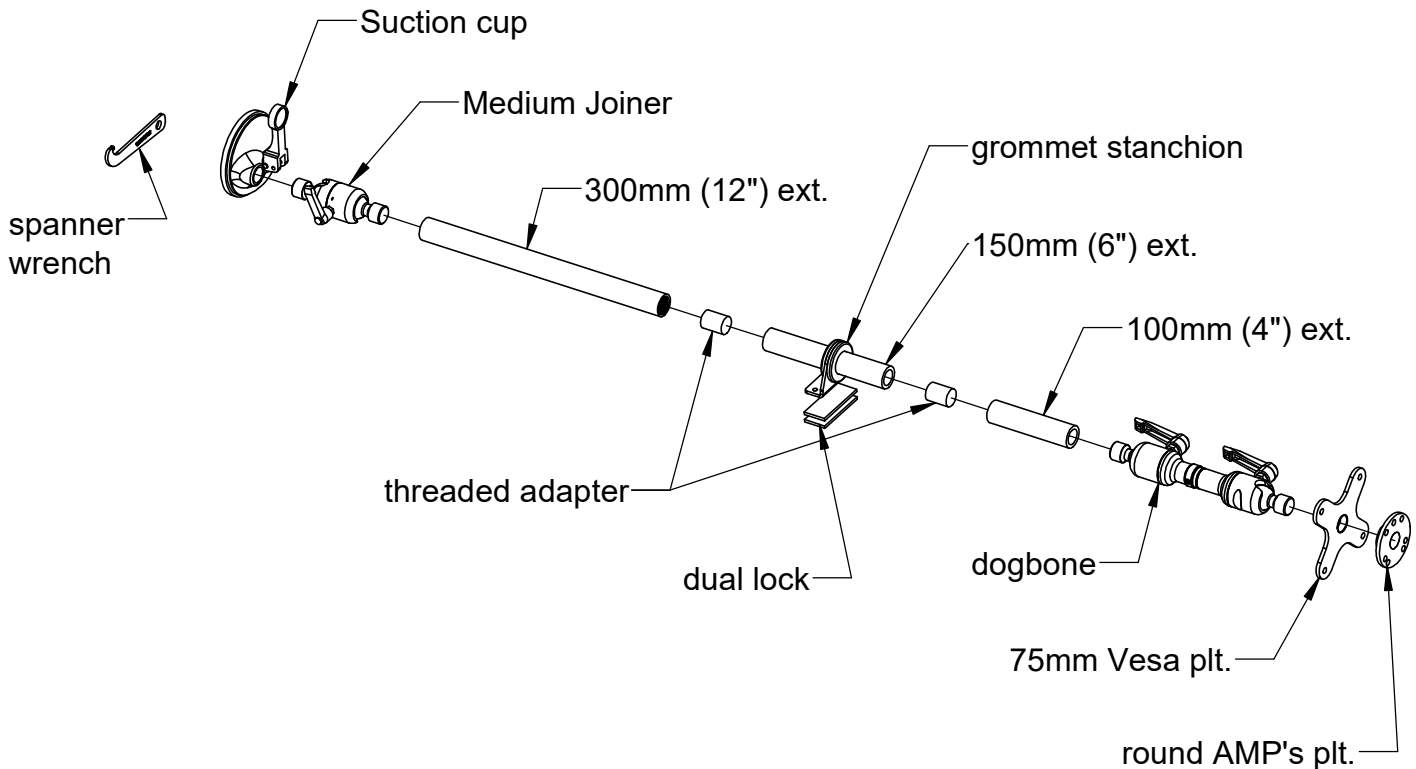

Mounting the device

1. Use the hardware supplied with the device being mounted to attach the AMP's or 75mm Vesa mounting plate to the device.
2. Position the mount in the desired location and attach the suction cup to the windshield.
3. Tighten the lever on the medium joiner attached to the suction cup and the levers on the dogbone which is holding the device in the desired location.
2. With the device rotated in the desired location, tighten the set screw at the center swivel location on the dogbone to lock it in place. This will require a 3mm hex wrench.
3. Attach 1 piece of the dual lock adhesive (found in hardware bag 7120-1011) to the bottom side of the grommet stanchion by removing the release liner and sticking it to the bottom of the stanchion. Snap the second piece of dual lock to the first piece and stick it to the dash as close to the front of the dash as possible to hold the stanchion in the desired location.
4. Optional - the stanchion has 2 holes in the base of the bracket. The customer can attach it to the dash with self drilling screws if desired, in lieu of the dual lock adhesive.

