



INSTALLATION INSTRUCTIONS

Product

7160-1035

ZIRKONA TO GJ ADAPTER

Revision

REV. D

Form

INST-809

Printing Spec: PS-001**To Install:**

1. Place the studs through the top plate or accessory that features a 3 bolt hole or 'smiley face' bolt pattern.
2. Install the included flanged lock nuts and tighten.
3. Attach the male threaded Zirkona accessory to the adapter plate threaded coupling.

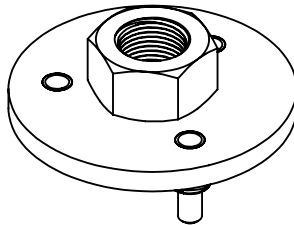
**7160-1035****ZIRKONA TO 3 STUD GJ ADAPTER PLATE****Product Mounting Disclaimer**

Gamber-Johnson is not liable under any theory of contract or tort law for any loss, damage, personal injury, special, incidental or consequential damages for personal injury or other damage of any nature arising directly or indirectly as a result of the improper installation or use of its products in vehicle or any other application. In order to safely install and use Gamber-Johnson products full consideration of vehicle occupants, vehicle systems (i.e., the location of fuel lines, brakes lines, electrical, drive train or other systems), air-bags and other safety equipment is required. Gamber-Johnson specifically disclaims any responsibility for the improper use or installation of its products not consistent with the original vehicle manufactures specifications and recommendations, Gamber-Johnson product instruction sheets, or workmanship standards as endorsed through the Gamber-Johnson Certified Installer Program.

© Copyright 2017 Gamber-Johnson, LLC

If you need assistance or have questions, call Gamber-Johnson at 1-800-456-6868



INSTALLATION INSTRUCTIONS

Product**Zirkona Mounting System****Revision****Rev K****Form****INST-494****Printing Spec: PS-001**

These general instructions are intended to cover most of the components of the Zirkona product line.

!Warning!

-Always apply thread locker on all M20 threads of the Zirkona product line. Loctite EA 9460, EA 9461 or EA 9466 EPOXY is the recommended thread locker for all these threaded joints.

-Do not exceed maximum payload weight. See charts below:

	<u>Dynamic load</u>	<u>Static load</u>
Small Joiners(7110-1234, -1237, -1239)	3 lbs. (1.4kg)	22 lbs. (10kg)
Medium Joiners(7110-1235, -1222, -1259, -1406, -1407)	6 lbs. (2.8kg)	33 lbs. (15kg)
Large Joiners(7110-1236, -1260)	11 lbs. (5kg)	55 lbs. (25kg)
Large Short Joiner(7110-1416)	30 lbs. (13.6kg)	145 lbs. (65.7kg)

*Extension tubes will lower the overall payload rating of the mount. The longer the extension, the lower the maximum payload of the mount. As a general rule, lower the maximum payload 20% for every 50mm of extension (Ex: 100mm extension = reduces the payload by 40%)

-The suction cup bases require a smooth flat surface to affix to. Both the surface and the rubber of the base should be cleaned with water and/or a mild cleaner. Press the base hard against the surface and pull down the locking lever. Repeat this procedure at least once a month.

Pat.: www.gamberjohnson.com/patents <<http://www.gamberjohnson.com/patents>>

Product Mounting Disclaimer

Gamber-Johnson is not liable under any theory of contract or tort law for any loss, damage, personal injury, special, incidental or consequential damages for personal injury or other damage of any nature arising directly or indirectly as a result of the improper installation or use of its products in vehicle or any other application. In order to safely install and use Gamber-Johnson products full consideration of vehicle occupants, vehicle systems (i.e., the location of fuel lines, brakes lines, electrical, drive train or other systems), air-bags and other safety equipment is required. Gamber-Johnson specifically disclaims any responsibility for the improper use or installation of its products not consistent with the original vehicle manufacturers specifications and recommendations, Gamber-Johnson product instruction sheets, or workmanship standards as endorsed through the Gamber-Johnson Certified Installer Program.

© Copyright 2017 Gamber-Johnson, LLC

If you need assistance or have questions, call Gamber-Johnson at 1-800-456-6868
gamberjohnson.com/zirkona
5001 Joerns Drive, Stevens Point, WI 54481, USA

Use of the Zirkona product line.

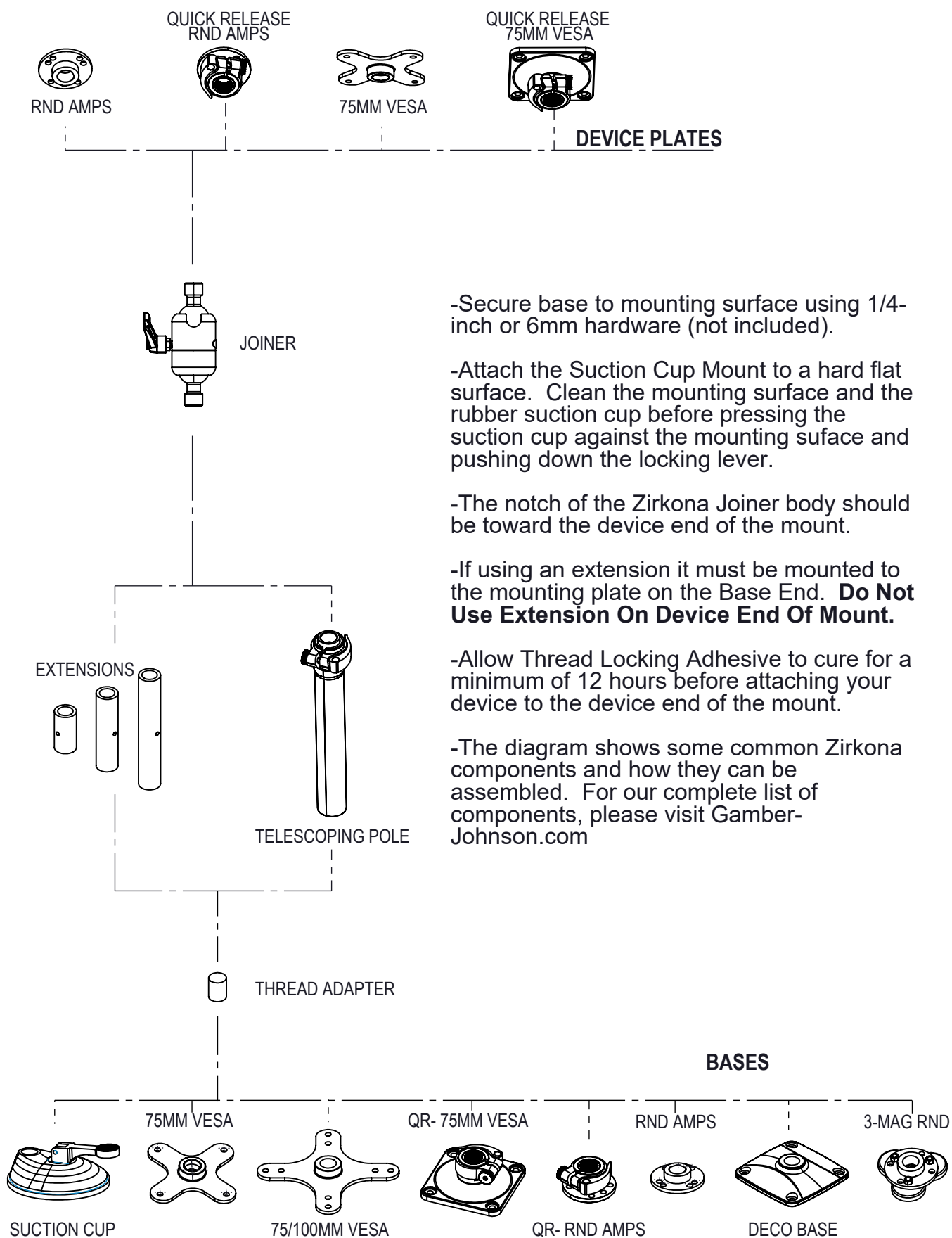

SPANNER WRENCH
(p/n 19511)

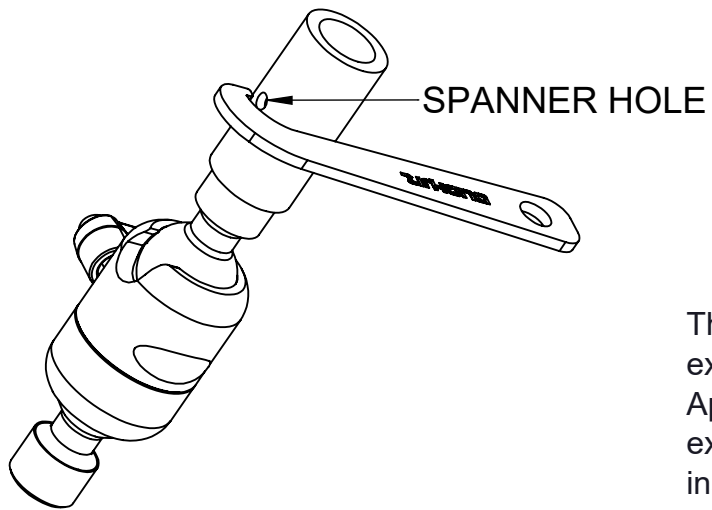

The spanner wrench is used to tighten extension tubes onto the joiner bodies. Apply epoxy thread locker EA 9460 on external and internal M20 threads, then insert the hook end of the spanner wrench into the hole of the extension tube to tighten the joint.