



INSTALLATION INSTRUCTIONS

Product

7160-2094

CONSOLE - CHEVY BLAZER EV 2025+

Revision

Rev A

Form

INST-1245

Printing Spec: PS-001

ITEM	QTY.	PartNo	DESCRIPTION
1	1	22059	CONSOLE WELDMENT - CHEVY EV BLAZER 2025+
2	1	22067	DS WING - CONSOLE - CHEVY EV BLAZER 25+
3	1	22060	PS WING - CONSOLE - CHEVY EV BLAZER 25+
4	2	22158	BRACKET - GM CHEVY MODULE USB A + USB C
5	1	22069	ELECTRONICS TRAY - CONSOLE - CHEVY EV BLAZER 25+
6	1	22581	TOP PLATE - CONSOLE MAIN WELDMENT - CHEVY EV BLAZER 25+
7	1	22254	AIR DEFLECTOR, CONSOLE EV BLAZER 25+
8	1	7120-1264	HARDWARE BAG, CONSOLE, CHEVY EV BLAZER 25+

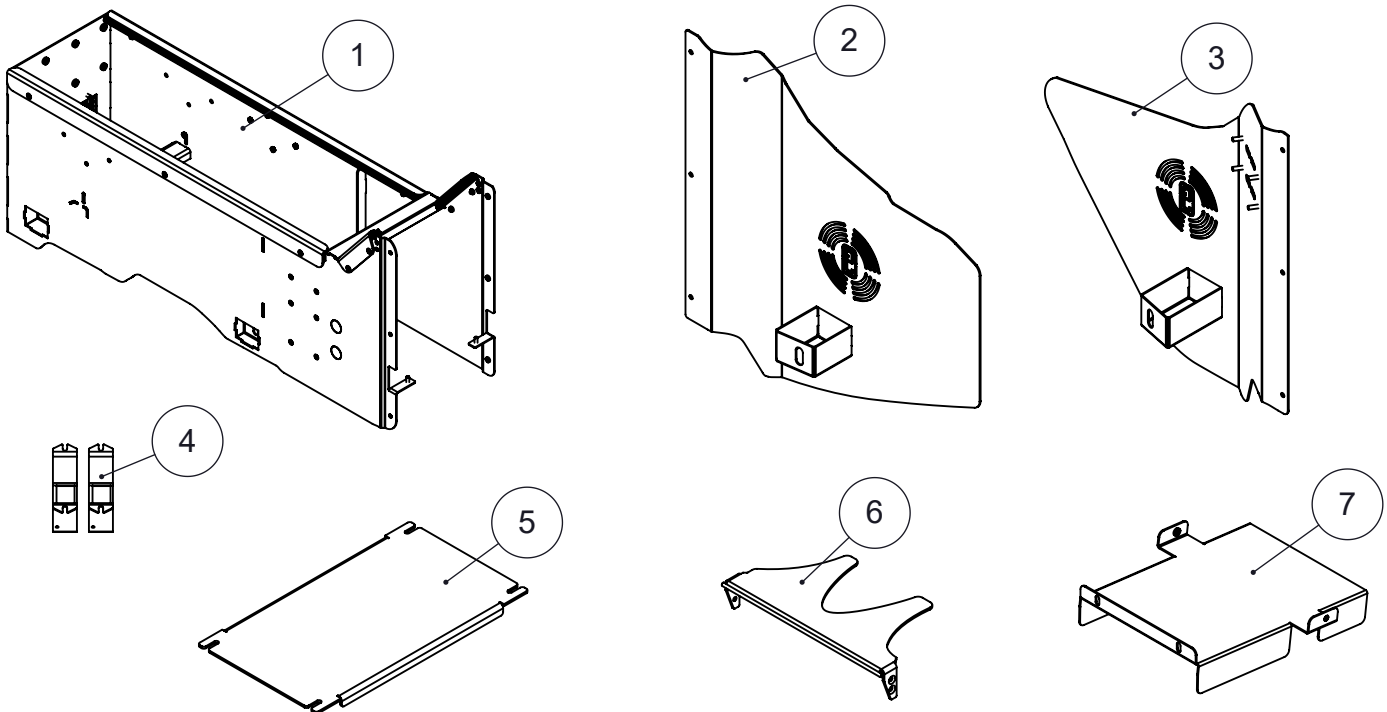

Product Mounting Disclaimer

Gamber-Johnson is not liable under any theory of contract or tort law for any loss, damage, personal injury, special, incidental or consequential damages for personal injury or other damage of any nature arising directly or indirectly as a result of the improper installation or use of its products in vehicle or any other application. In order to safely install and use Gamber-Johnson products full consideration of vehicle occupants, vehicle systems (i.e., the location of fuel lines, brake lines, electrical, drive train or other systems), air-bags and other safety equipment is required. Gamber-Johnson specifically disclaims any responsibility for the improper use or installation of its products not consistent with original vehicle manufactures specifications and recommendations, Gamber-Johnson product instruction sheets, or workmanship standards as endorsed through the Gamber-Johnson Certified Installer Program.

© Copyright 2025 Gamber-Johnson, LLC

If you need assistance or have questions, call Gamber-Johnson at 1-800-456-6868



Vehicle Preparation

1. Start by removing the factory console or wiring cover (shown below). Instructions provided in the vehicle specific Factory Service Manual (FSM)



2. Detach console HVAC duct and set aside. (If also installing American Aluminum K9 Unit consult related instructions for alternative HVAC steps)



Console Installation

3. (Optional) Remove the two twin USB C modules from the factory console. Use provided mounting locations on **PS Wing** as shown below

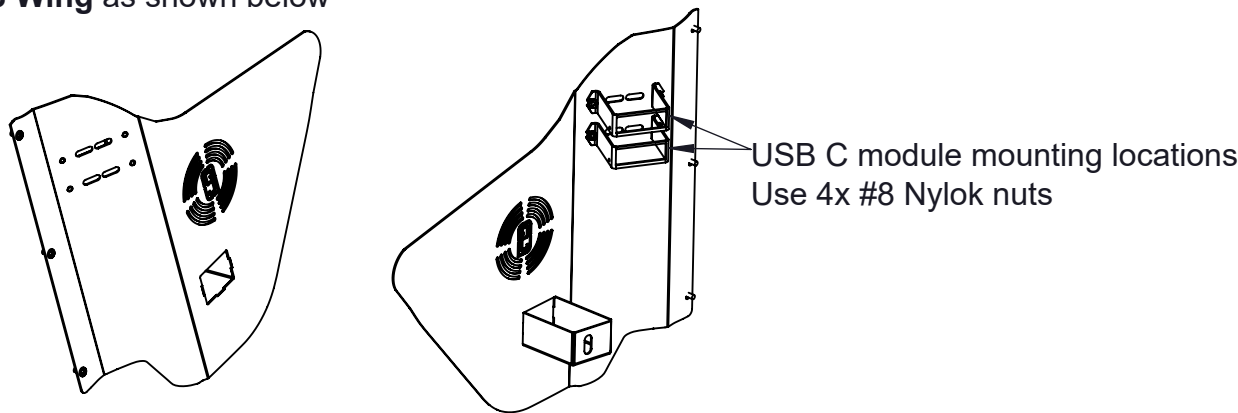

4. Place console in vehicle and use four of the factory console mounting bolt to install console

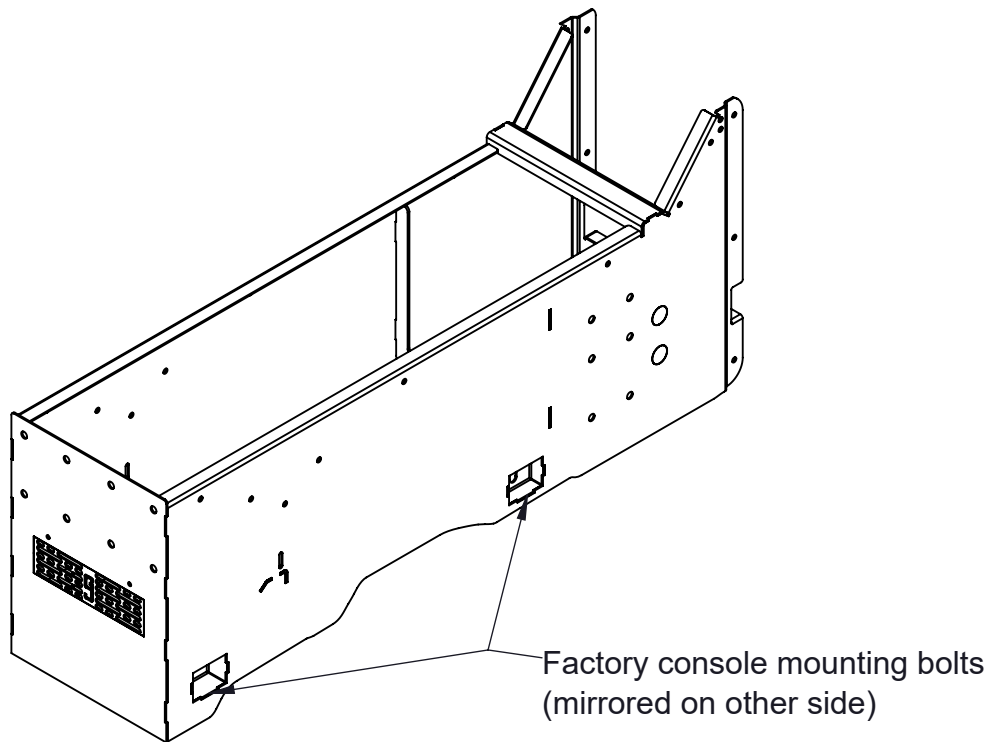

5. Install **Air Deflector** so it rests on top of the HVAC duct using the screws on the sides of the console box

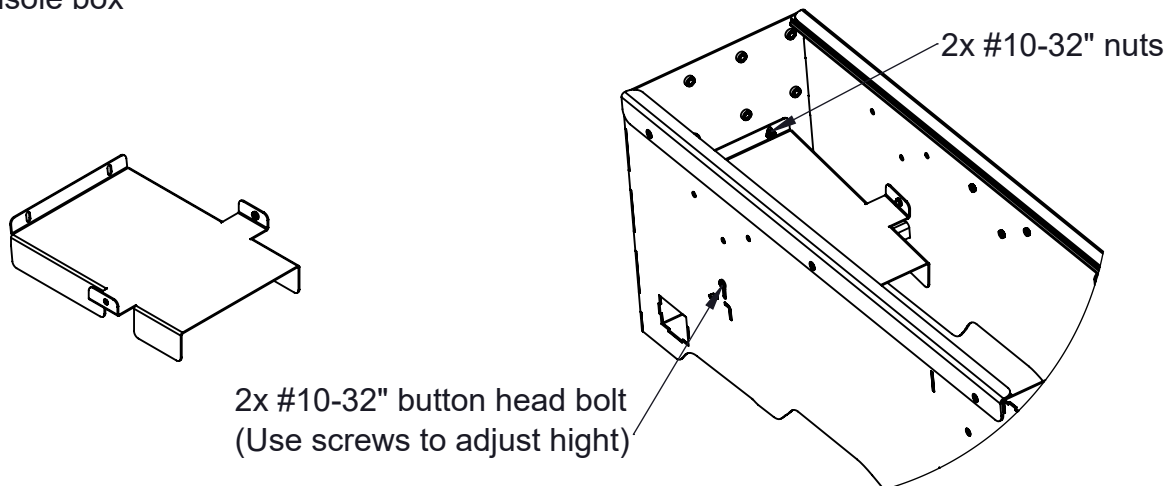

6. Electronics Tray

- The included **Electronics Tray** can be populated outside of console installation
- Once ready to install the **Electronics Tray**, place into console as shown below

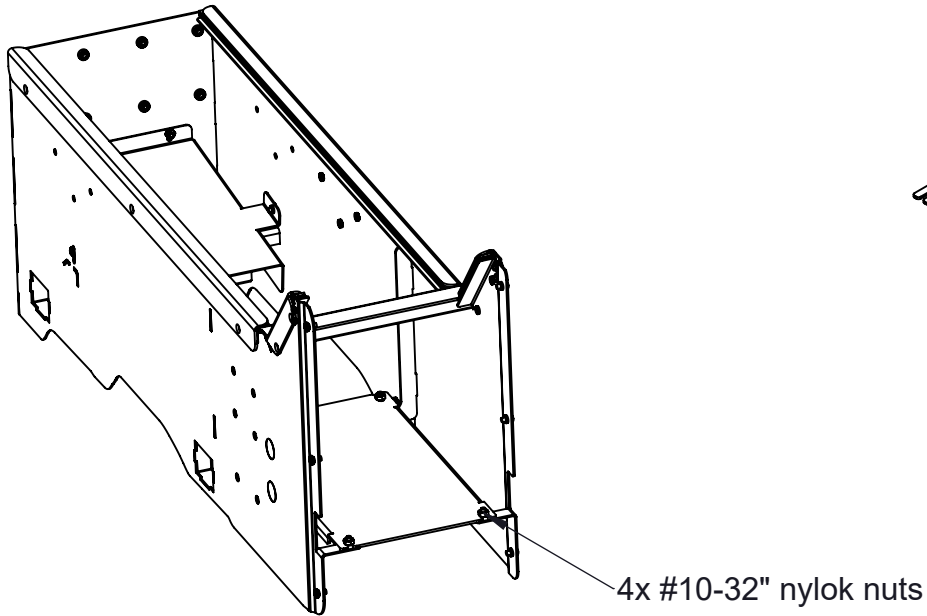

7. Install **Top Plate** using (4) #10-32" counter sink bolts

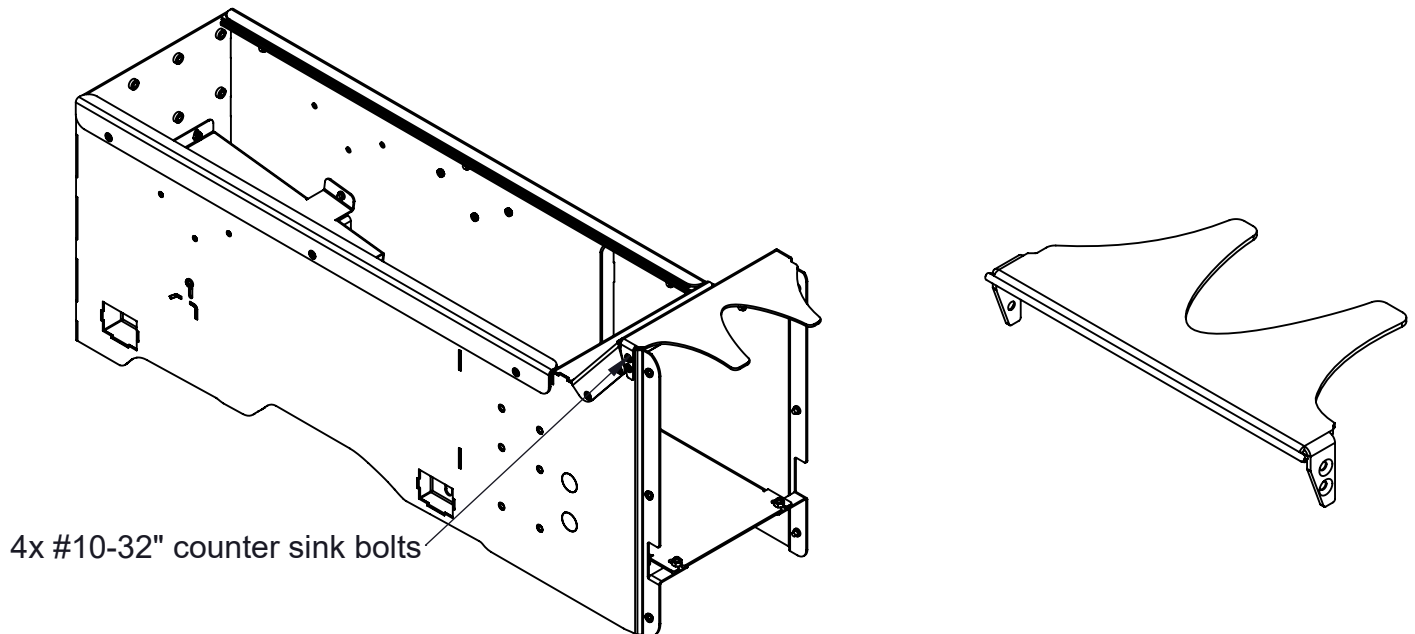

8. The driver and passenger side wings can now be installed (Items 4 and 5)

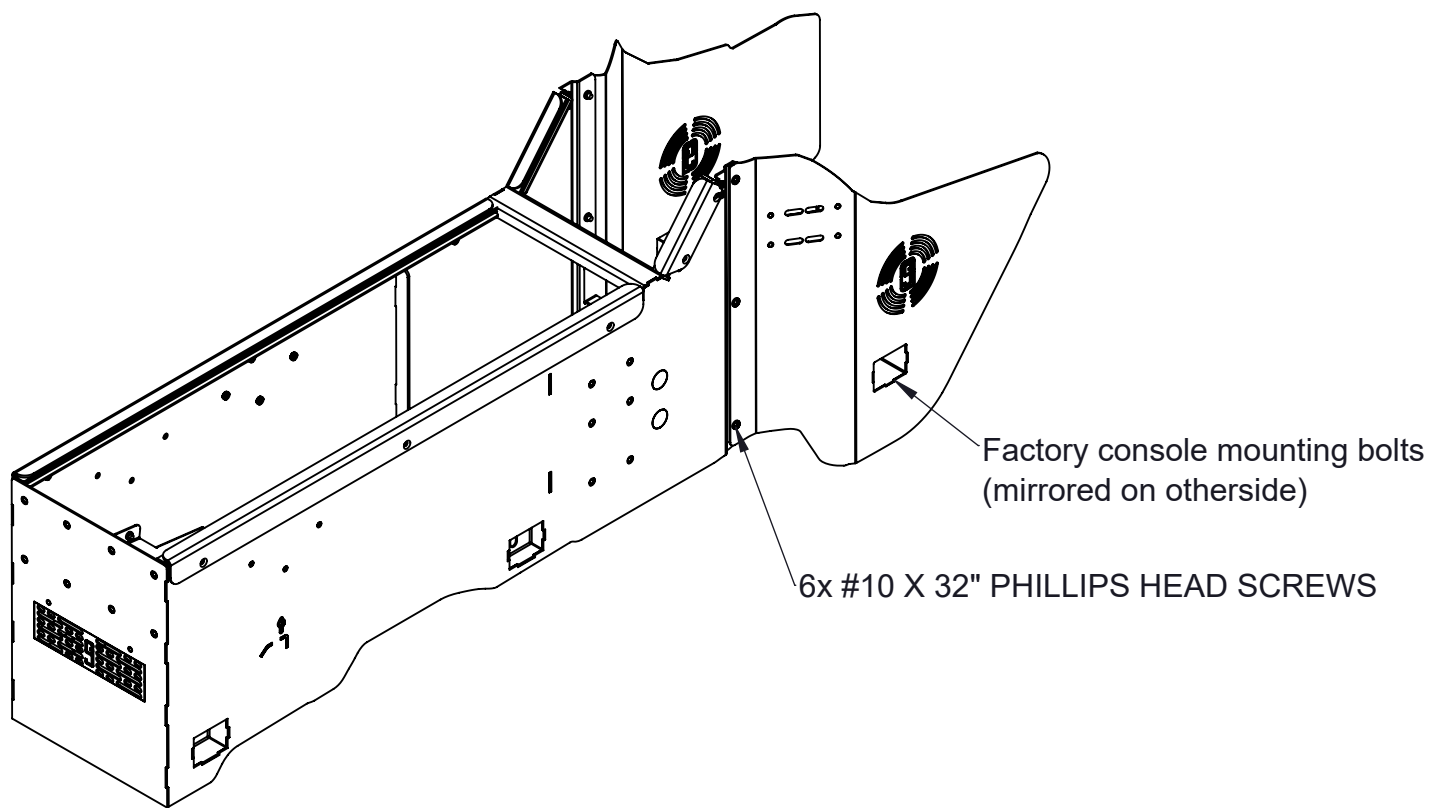

9. Console install is complete and it can be outfitted with faceplates as needed

