



INSTALLATION INSTRUCTIONS

Product

7170-1252

KIT - PASSENGER PARTITION REDESIGN - DODGE DURANGO 2021+

Revision

Rev A

Form

INST-1300

Printing Spec: PS-001

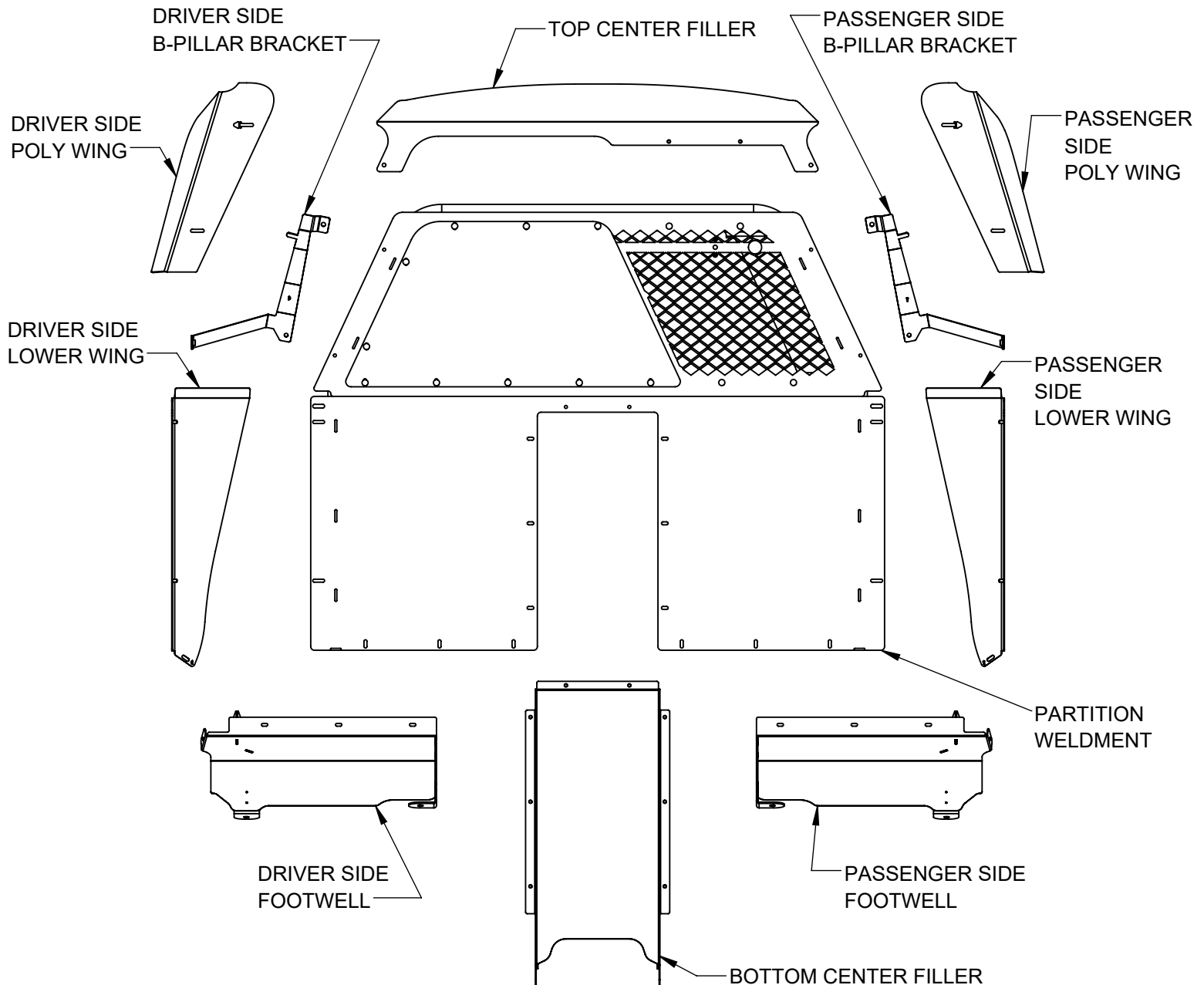

Product Mounting Disclaimer

Gamber-Johnson is not liable under any theory of contract or tort law for any loss, damage, personal injury, special, incidental or consequential damages for personal injury or other damage of any nature arising directly or indirectly as a result of the improper installation or use of its products in vehicle or any other application. In order to safely install and use Gamber-Johnson products full consideration of vehicle occupants, vehicle systems (i.e., the location of fuel lines, brake lines, electrical, drive train or other systems), air-bags and other safety equipment is required. Gamber-Johnson specifically disclaims any responsibility for the improper use or installation of its products not consistent with original vehicle manufactures specifications and recommendations, Gamber-Johnson product instruction sheets, or workmanship standards as endorsed through the Gamber-Johnson Certified Installer Program.

© Copyright 2025 Gamber-Johnson, LLC

If you need assistance or have questions, call Gamber-Johnson at 1-800-456-6868

1. Begin by removing trim covers and loosening the front pair of seat bolts. Then slide & lean both front seats fully forward.

2. Pull weather stripping away from front and rear sections surrounding the B-pillar

3. Remove lower B-pillar trim to expose the factory fastener holding upper B-pillar trim. Remove the fastener and upper B-pillar trim piece

4. Unfasten remove grab handle and replace with provided B-PILLAR BRACKET using factory hardware

5. Re-install all B-pillar trim and weather stripping

6. Remove rear interior facing seat rail trim and rear seat bolts , slide FOOTWELLS under seat rails and reinstall seat bolts, leave only hand tight.

TO EASE INSTALLATION, ITS ADVISED THAT ALL FASTENERS AFTER THIS STEP BE HAND TIGHT UNTIL ALL PEICES ARE INSTALLED

7. Hoist PARTITION WELDMENT into vehicle and set on alignment pins of the installed footwells. Fasten PARTITION WELDMENT to B-PILLAR BRACKETS using 5/16 bolt and washer.

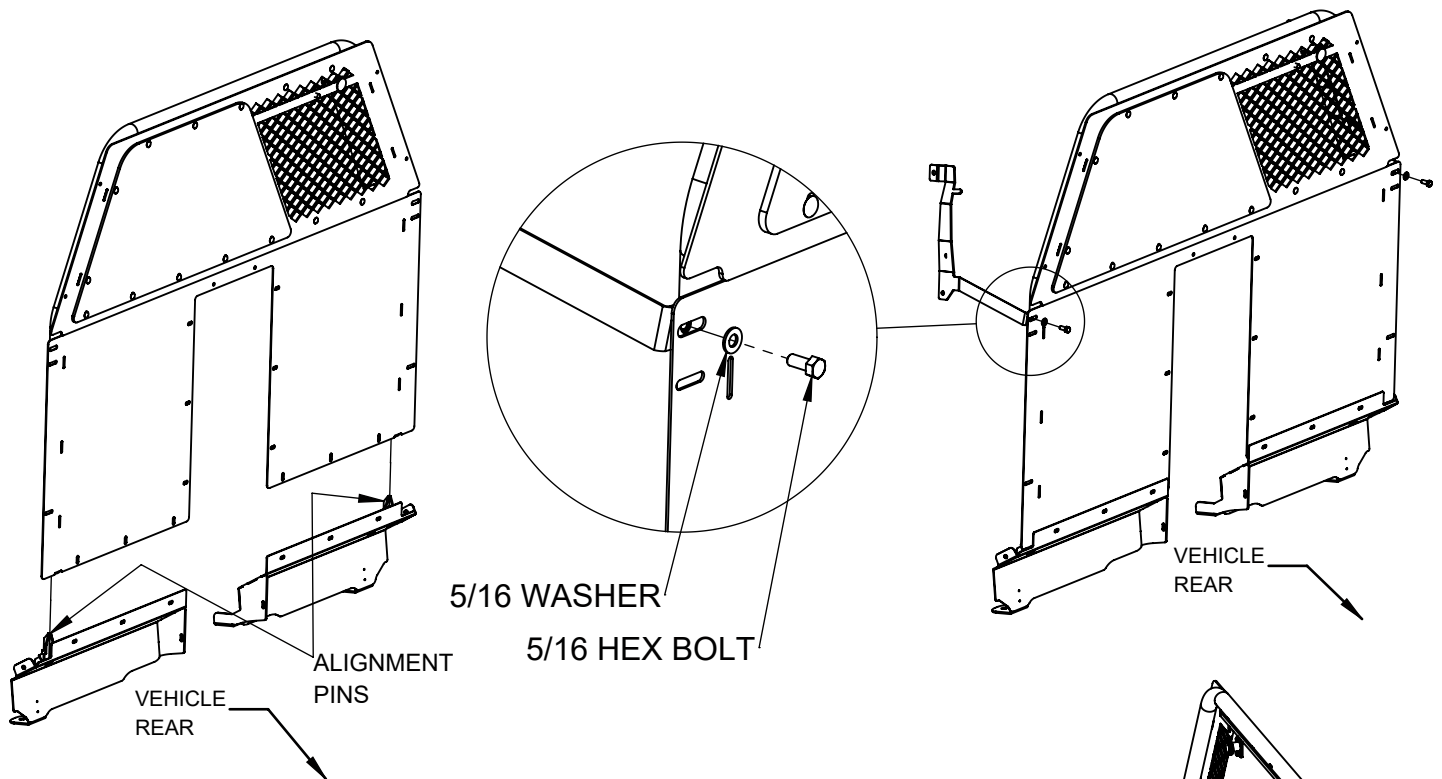

8. Fasten FOOTWELL to MAIN WELDMENT using 1/4 carriage bolts and flange nylock

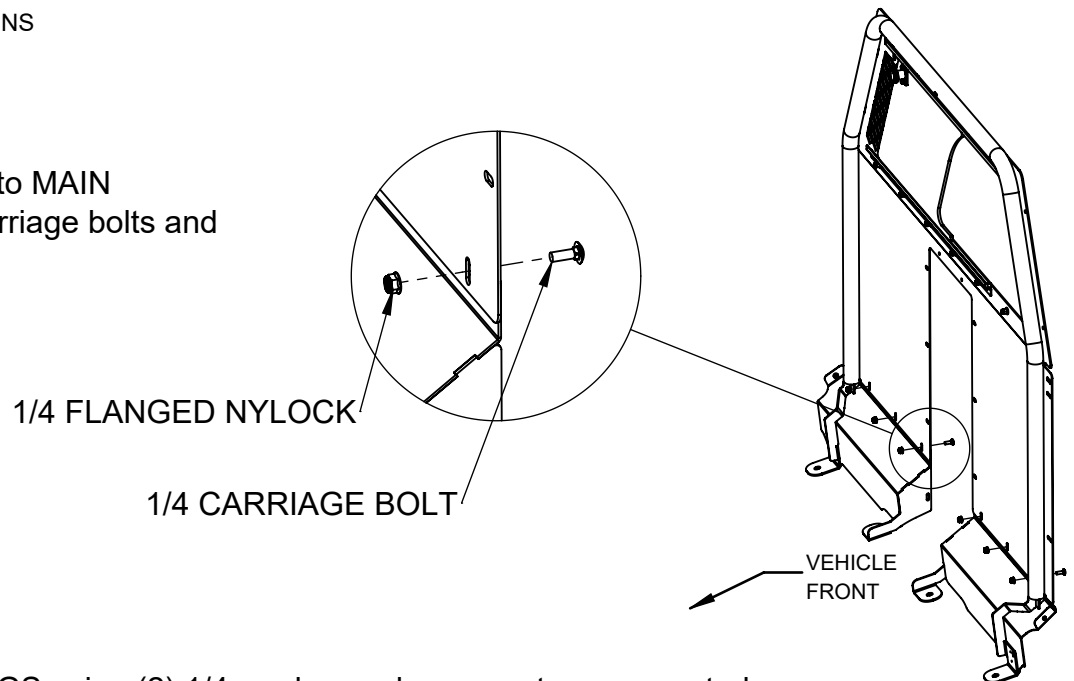

9. Install LOWER WINGS using (2) 1/4 washer and acorn nut on upper studs and (1) 1/4 washer and 1/4-20 x .5" button head screw on lower slotted hole

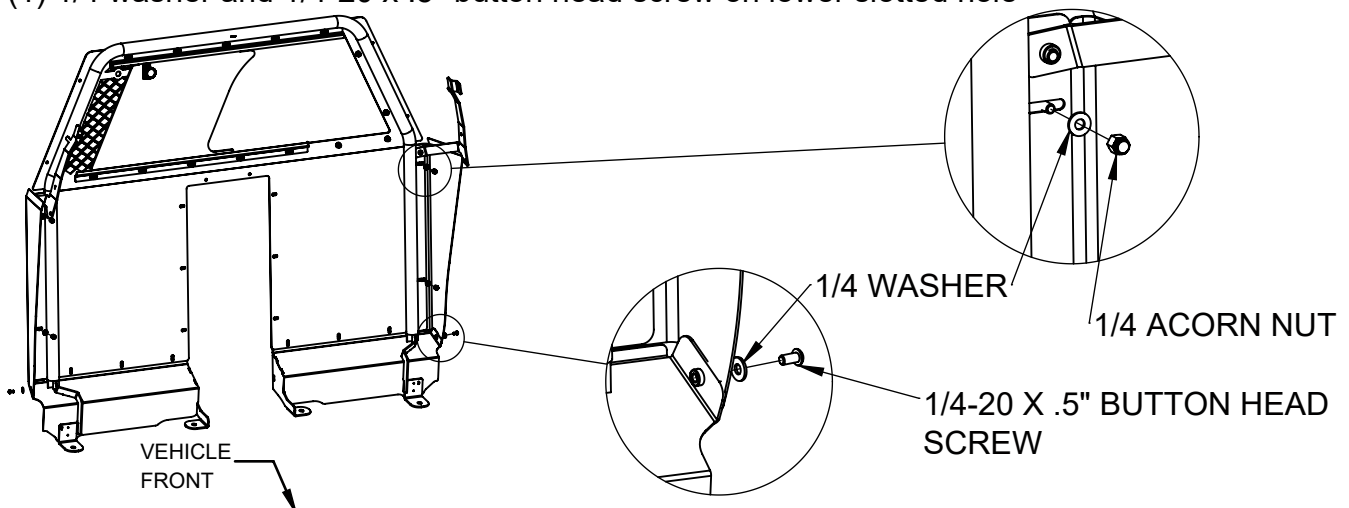

10. Remove the (2) 1/4 hardware from upper passenger side of main weldment window. Reusing (1) 1/4 wahser and acorn nut per stud, install TOP CENTER FILLER

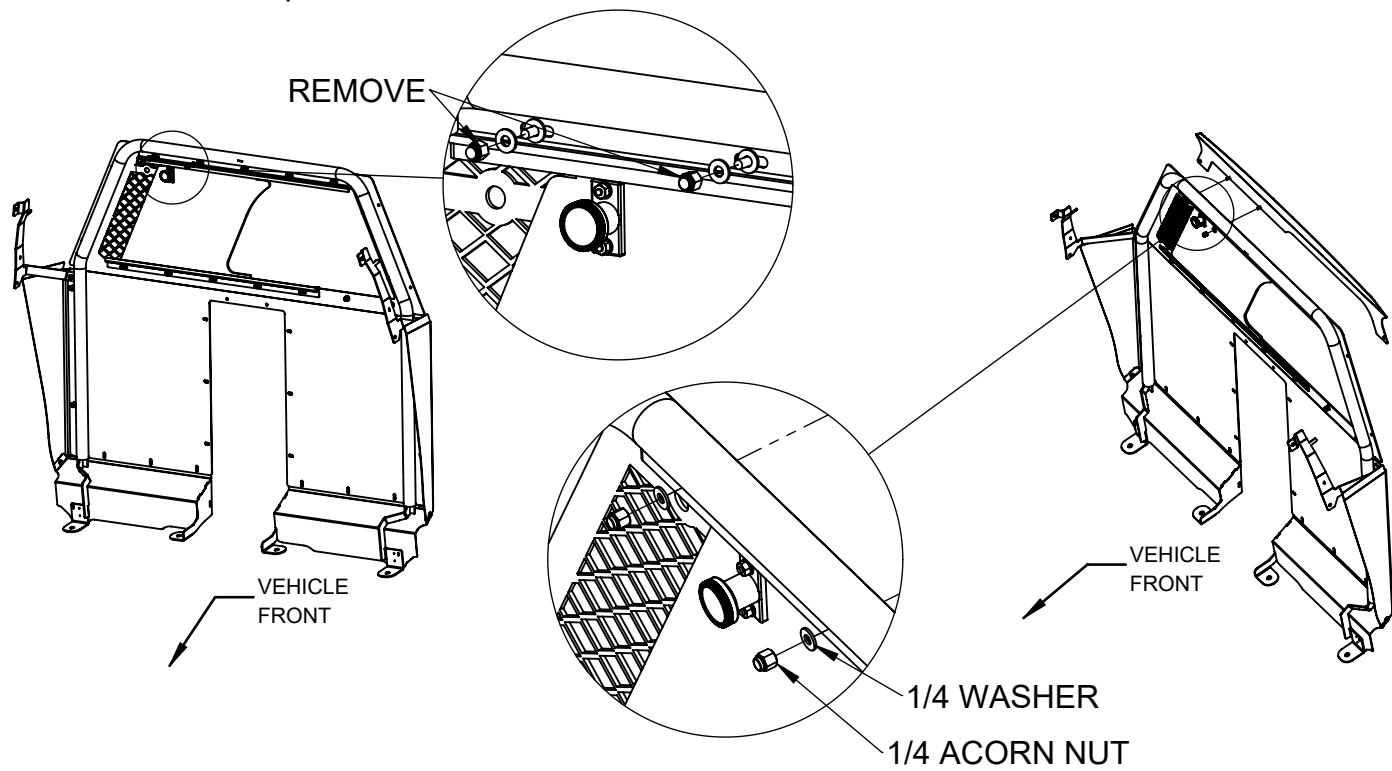

11. Install POLY WINGS using 1/4-20 x .875" button head screw, nylon washer, flat washer, and acron nut

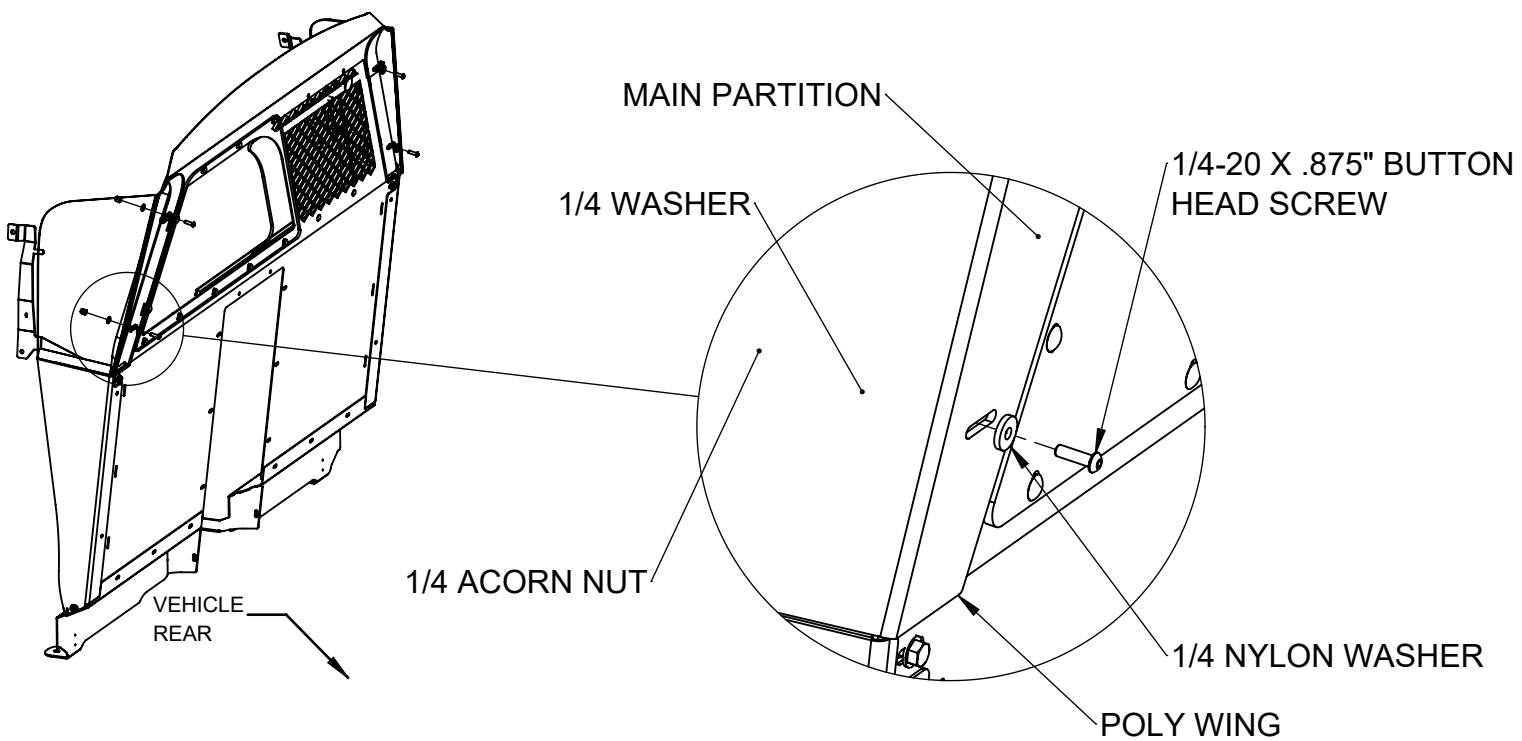

12. Install BOTTOM CENTER FILLER aligning studs it's studs with the coorespnding holes in the MAIN PARTITION. Fasten using (8) 1/4 washerS and acorn nutS on upper studs and (2) 1/4 washer and 1/4-20 x .5" button head screw on lower slotted hole

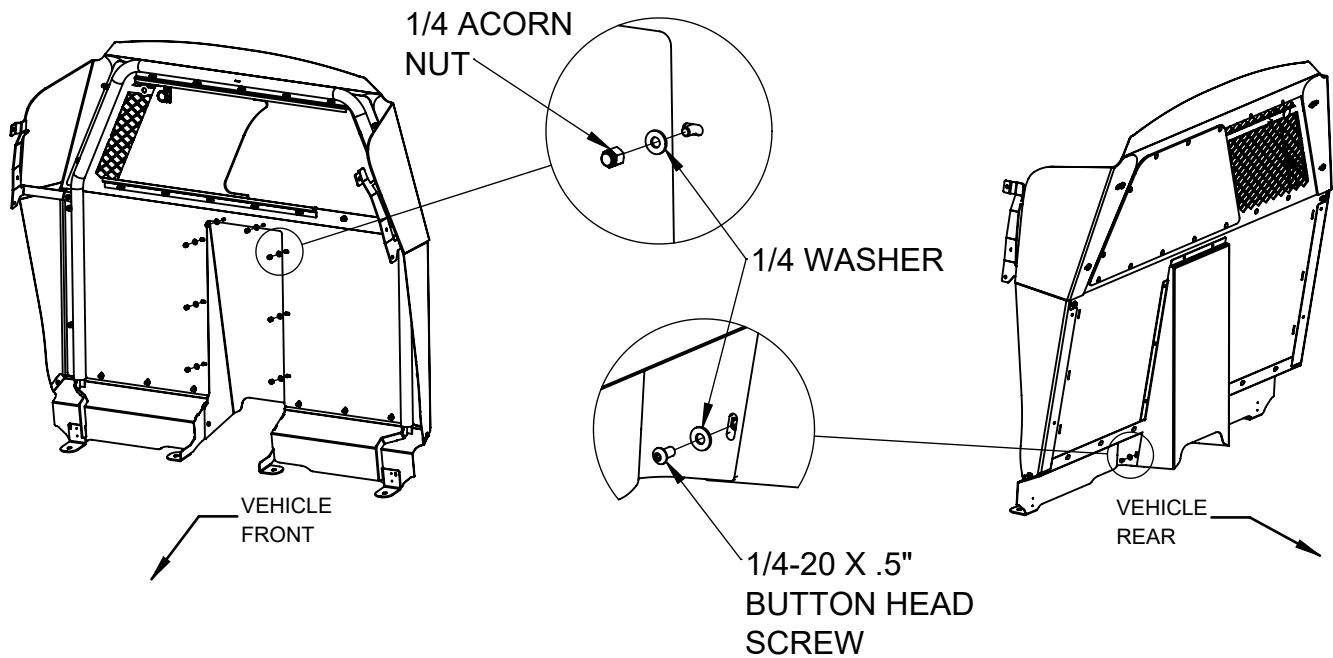

13. All fasteners can now be fully tightened. Ensure front driver and passenger seat bolts are tightened to factory specification.

INSTALLATION IS COMPLETE