



INSTALLATION INSTRUCTIONS

Product

7160-1838-XX, 7160-2173

Cargo Window Guards - 2nd Gen Ford PIU

Revision

Rev C

Form

INST-1215

Printing Spec: PS-001

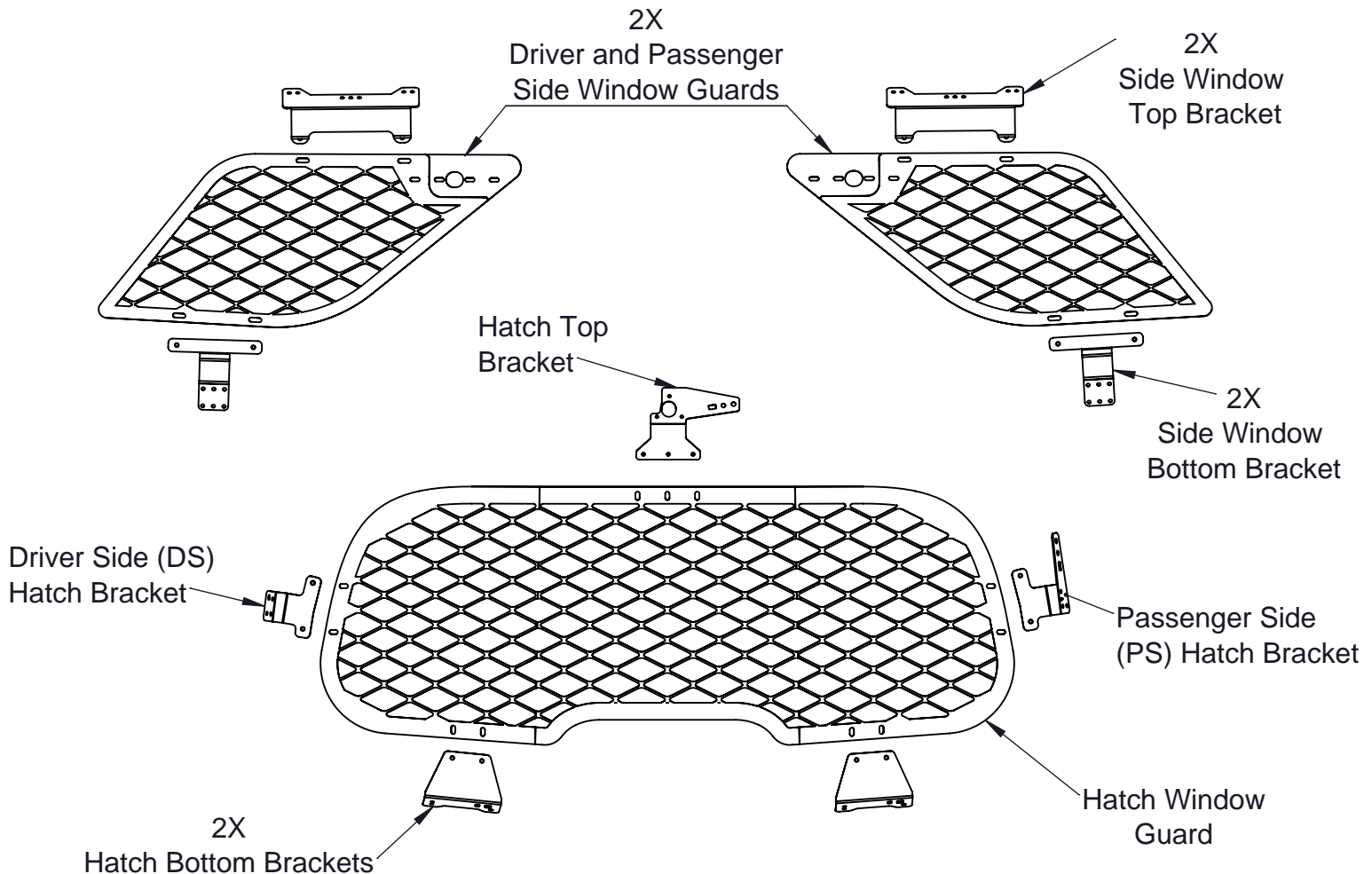

This assembly uses hardware bag 7120-1243 to mount the guards to the brackets.

To secure brackets to vehicle:

7160-1838-XX Assembly uses Hardware Bag 7120-1295

7160-2173 Assembly uses Hardware Bag 7120-1184

*Diamond mesh window guards shown

Product Mounting Disclaimer

Gamber-Johnson is not liable under any theory of contract or tort law for any loss, damage, personal injury, special, incidental or consequential damages for personal injury or other damage of any nature arising directly or indirectly as a result of the improper installation or use of its products in vehicle or any other application. In order to safely install and use Gamber-Johnson products full consideration of vehicle occupants, vehicle systems (i.e., the location of fuel lines, brake lines, electrical, drive train or other systems), air-bags and other safety equipment is required. Gamber-Johnson specifically disclaims any responsibility for the improper use or installation of its products not consistent with original vehicle manufactures specifications and recommendations, Gamber-Johnson product instruction sheets, or workmanship standards as endorsed through the Gamber-Johnson Certified Installer Program.

© Copyright 2025 Gamber-Johnson, LLC

If you need assistance or have questions, call Gamber-Johnson at 1-800-456-6868



Removing vehicle trim:



Remove both floor trim panels to gain access to the spare tire and foam support.



Remove the OEM fasteners and remove the foam.

Removing vehicle trim:



For best access to the mounting areas, remove the bottom trim and upper cargo area trim, as well as the C and D Pillar trim on both sides. However, the installation can be completed without fully removing the upper cargo trim as shown below:



Installing Side Window Guards:

Driver Side

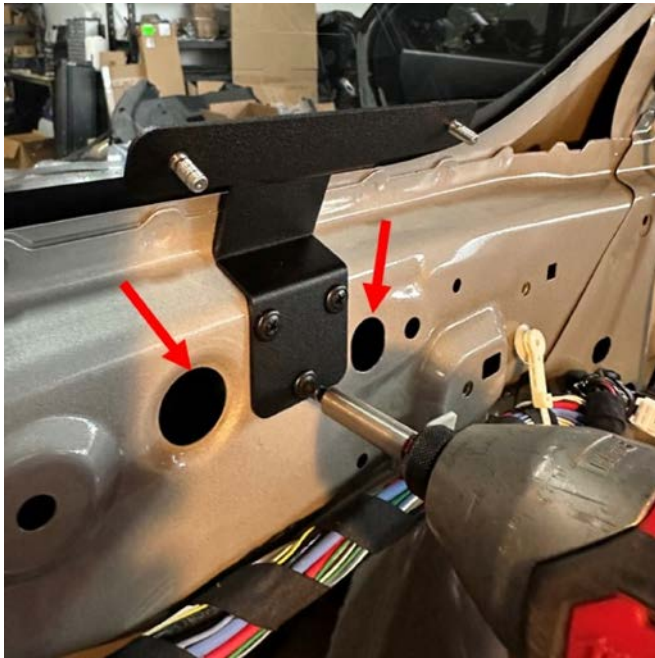

On the driver side, align the Side Window Bottom Bracket centered between the two OEM holes and fasten using the self-drilling screws.

Passenger Side



On the passenger side, align the Side Window Bottom Bracket 3/4" from the edge of the OEM slot as shown. Fasten using the self-drilling screws.

NOTE 1: Use at least three fasteners per bracket. Extra fasteners are provided. Take caution not to strip the fasteners by overtightening. It is helpful to finish fastening by hand with a #2 phillips head screwdriver

NOTE 2: If the vehicle is equipped with the "Ready for the Road" package. Carefully break-away the corner of each Side Window Guard

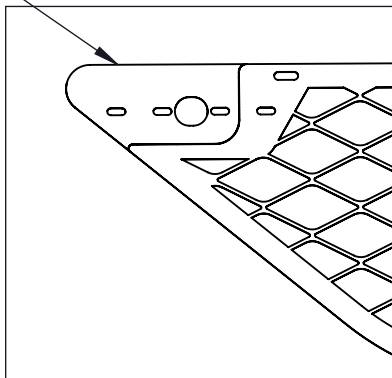

Top Bracket,
centered within the
Passenger Side
Window Guard slots

Fasten the Top Bracket to each Side Window Guard using the supplied Nylock nuts and washers. Center the studs of the brackets within the slots and ensure that the fasteners are tight for this step.

Installing Side Window Guards:

Passenger Side



- 1) Pull down the headliner to gain access to the vehicle body.
- 2) Center the bottom studs in the slots and fasten the Side Window Guard (with the Top Bracket attached) to the Bottom Bracket.
- 3) Press the Top Bracket against the vehicle as close to the vehicle window as possible. While holding, mount bracket with the self-drilling screws.
- 4) Tuck the headliner above the bracket as shown below:

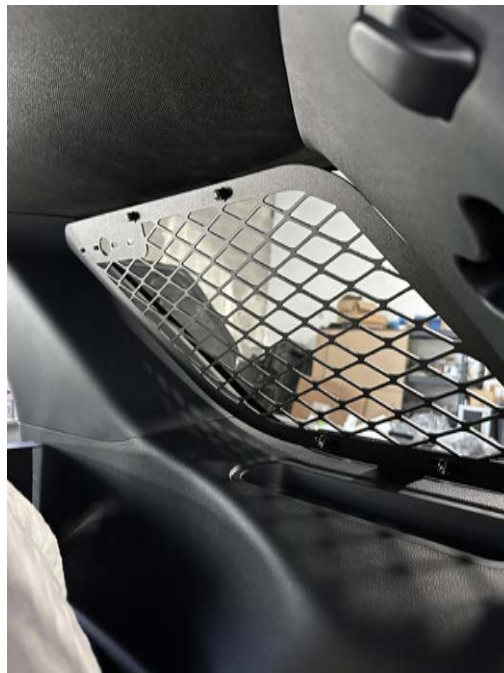

After installing the Side Window Guards on each side of the vehicle, re-install all OEM trim panels in the cargo area.

Removing Hatch Trim:



Remove the two fasteners near the grab handle as shown above, then remove all other trim panels from the hatch (main hatch trim/lower, two side pieces, and one upper piece).

Installing Hatch - Top and Driver Side Bottom Brackets:

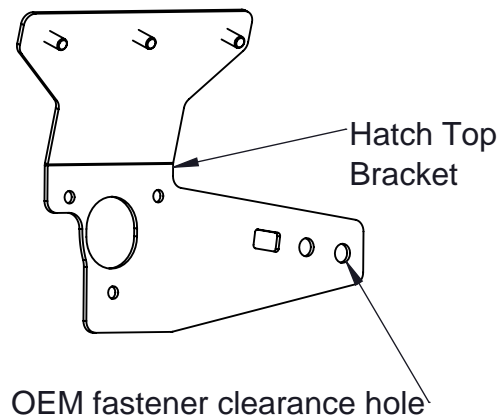

Centered at the top of the hatch, remove the OEM fastener as shown above. Align the large hole in the Hatch Top Bracket with the OEM hole on the hatch as shown. Place the OEM module onto the Hatch Top Bracket and secure the bracket to the hatch using the OEM fastener. Make sure the large hole is still aligned and use the three self-drilling screws to finish securing bracket to the vehicle.

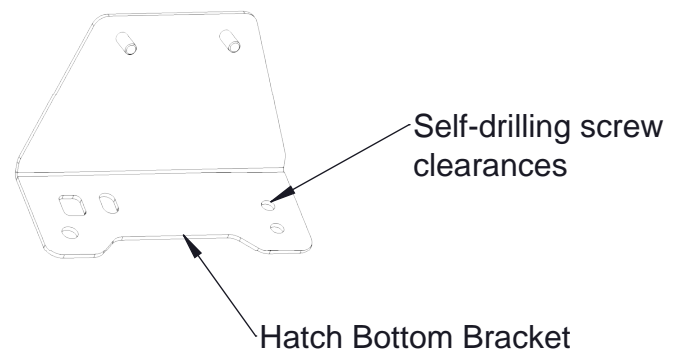
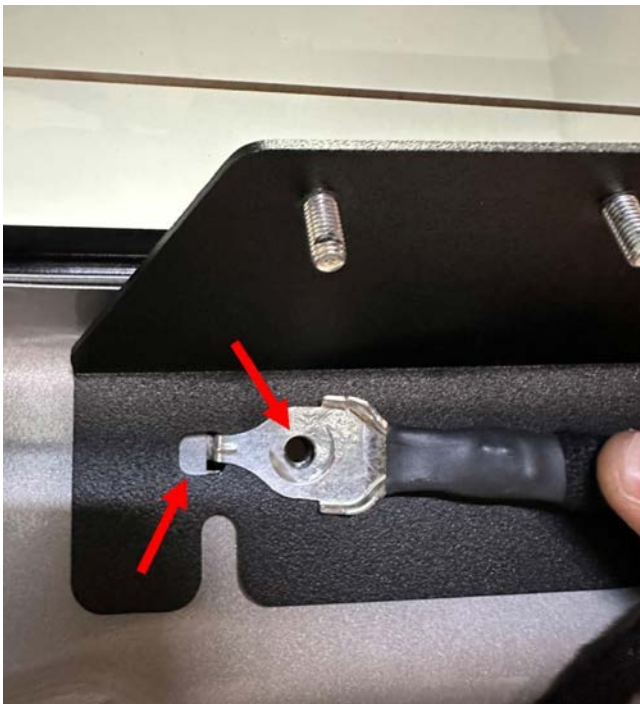

At the bottom of the hatch window on the driver side, remove the OEM fastener from the grounding cable. Align the cable to the Hatch Bottom Bracket as shown and re-fasten the OEM bolt through the cable and bracket. Use a self-drilling screw into the clearance hole indicated above.

NOTE: Use at least 1 self-drilling screw on this bracket

Installing Hatch - Passenger Side Bracket:



Passenger Side Bracket (indicated by "P")

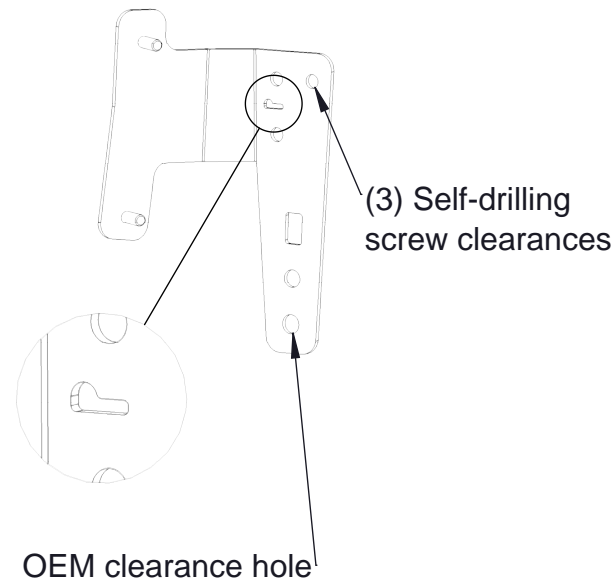

On the passenger side of the hatch, remove the OEM fastener from the module shown above, place the bracket onto vehicle, place the module onto the bracket and loosely secure using the OEM fastener.

With the OEM fastener in place, press the Passenger Side Bracket into the corner (shown below) as much as possible, then fasten using the self-drilling screws. **Use at least two screws here.**

Hatch Glass

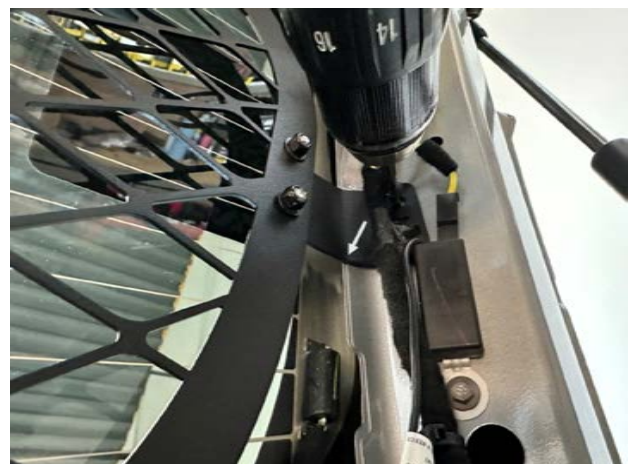
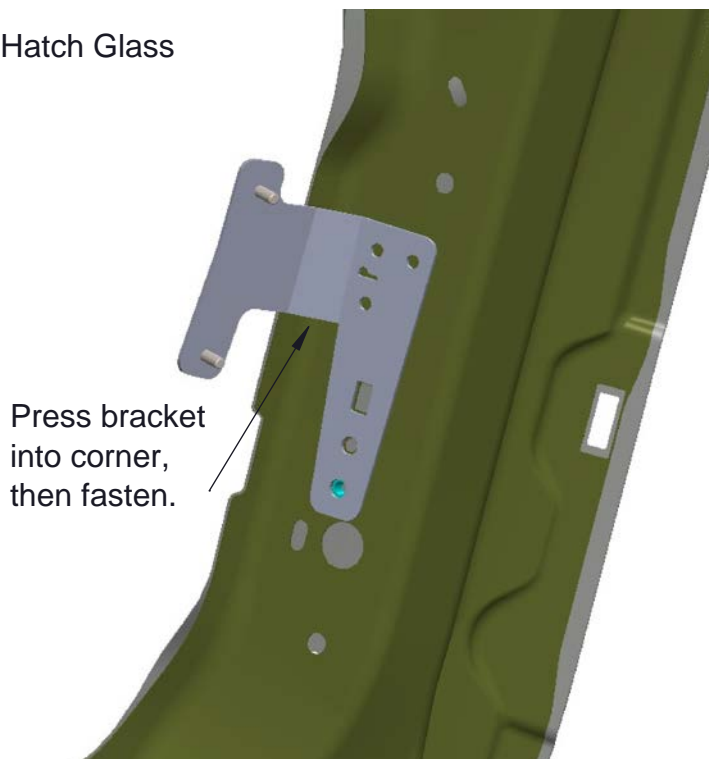

Installing Hatch - Driver Side Bracket:

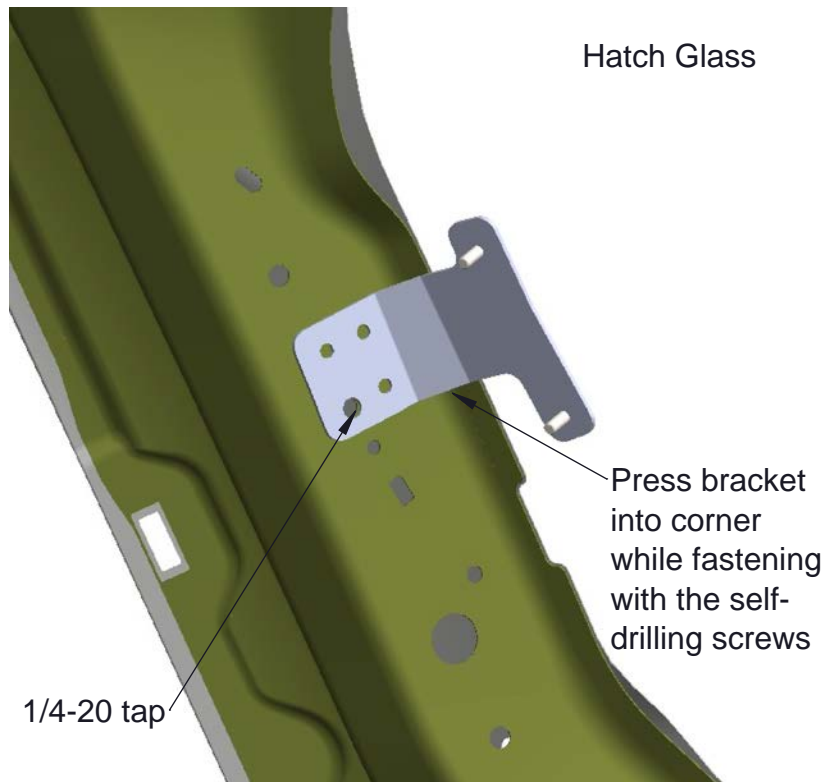
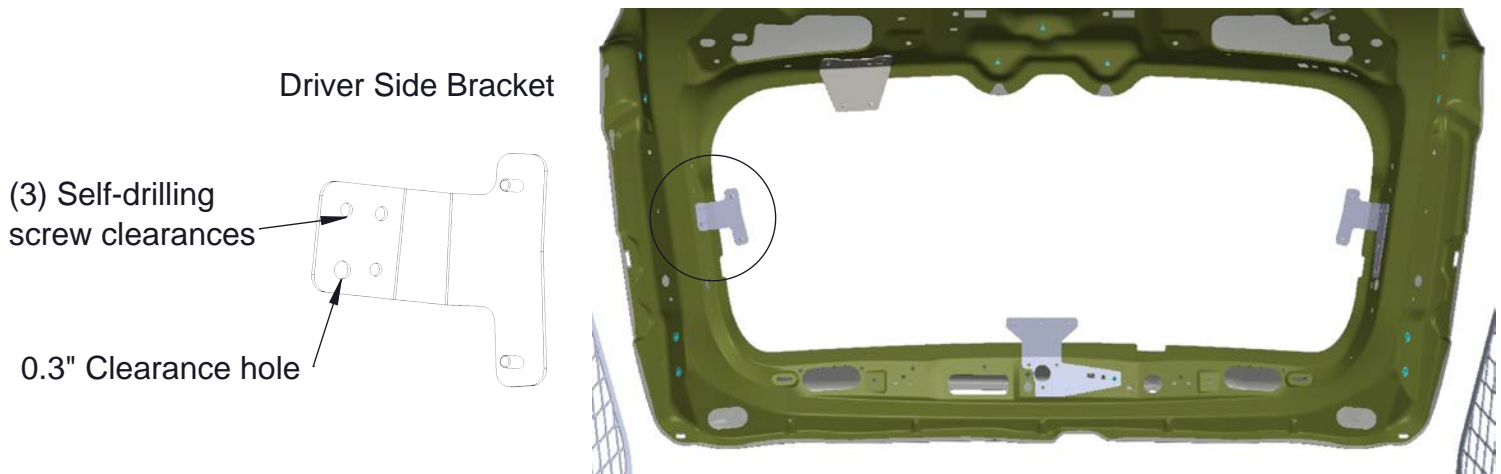

On the Driver Side of the hatch body, locate the unthreaded hole and tap using a 1/4-20 tap.

Align the OEM clearance hole of the bracket to the now threaded hole in the vehicle and loosely secure using the provided 1/4-20 fastener. Press the bracket into the corner and secure using the self-drilling screws. **Use at least two screws here.**

Installing Hatch Window Guard:

Loosely attach remaining bracket to the Hatch Window Guard

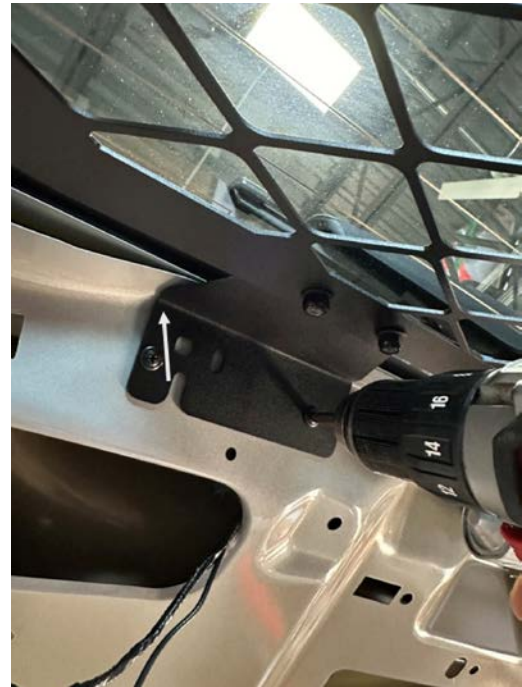
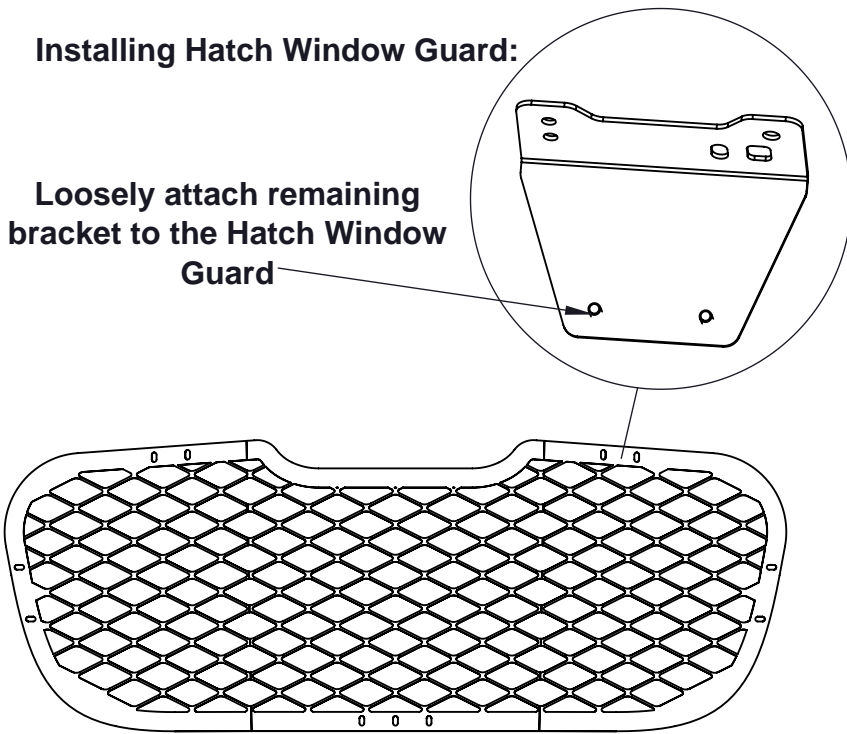

Passenger side
Bottom Bracket

Using the provided hardware, loosely fasten the remaining Passenger Side Bottom Bracket to the Hatch Guard as shown. Place and fasten the Hatch guard with the bracket attached onto all the already mounted brackets in the vehicle. Press the Passenger Side Bottom Bracket into the corner of the hatch body (shown above) and secure using at least two self-drilling screws. Tighen all hardware at this point.

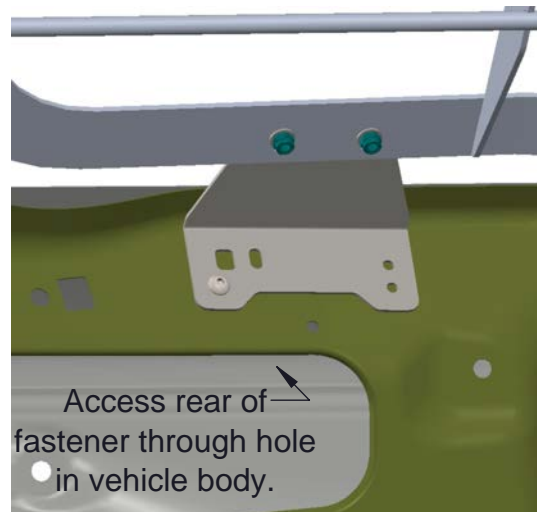
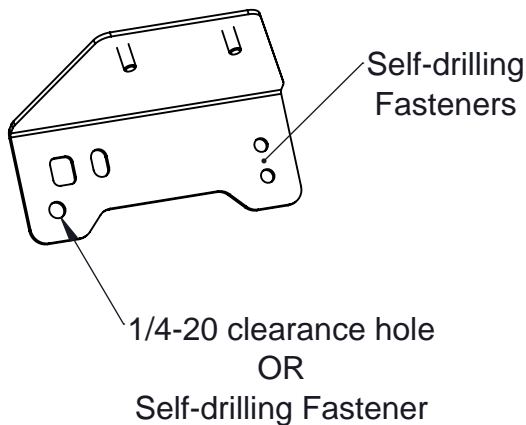

NOTE: If preferred, a 1/4-20 fastener and nut is provided in the hardware bag for mounting this bracket in the area shown above.

After the bracket has been mounted using the self drilling fastener(s) shown above, use the bracket as a template to drill through the vehicle and fasten with the provided nylok flange nut from the back-side.

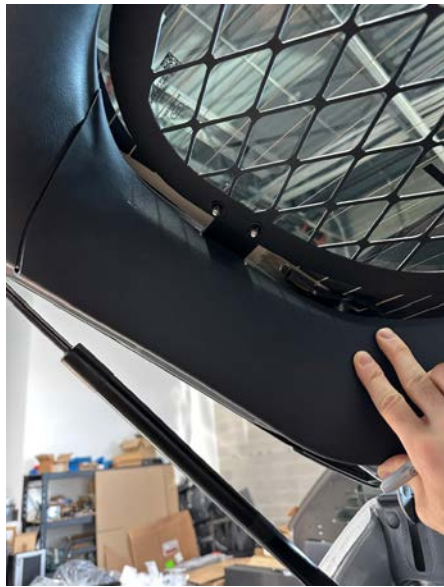

Re-install the main portion of the hatch trim. Re-install OEM fasteners near the handle. Align each side trim pieces and mark each piece to clear the Side Brackets. Only the side trim needs to be cut. Cut each piece on the marked lines approx. 7/8" in from the edge to clear the brackets when installed.

Reinstall the side trim pieces followed by the top center piece.

Installation is complete