



PRODUCT GUIDE

Getac F120 Tablet Dock

PRODUCT NUMBER(S)

7160-2127 Series



For more language options and/or questions, please contact a Gamber-Johnson representative at **+1 800.756.9198**

Since 1954, we have been dedicated to providing **RUGGED**, **RELIABLE**, and **RESPONSIVE** solutions that empower professionals in the field.

Thank you for choosing Gamber-Johnson.

Welcome to your new **Gamber-Johnson Docking Station**—engineered for **mission-critical reliability** in the toughest environments. At Gamber-Johnson, we understand that your technology is more than a tool; it's a lifeline. That's why our rugged mounting solutions and docking stations are designed to integrate seamlessly with your equipment, ensuring **secure connections** and **reliable performance** wherever your job takes you.

This guide will walk you through the safe and effective installation of your **Docking Station**.

Inside, you'll find:

- Inventory list of what's included
- Step-by-step installation instructions
- Images for easy reference
- Essential safety information to ensure proper setup and operation

Our commitment to **quality**, **durability**, and **rugged reliability** is built into every product we make.

Important: Before you begin, please carefully review all safety instructions provided in this guide. For vehicle applications, we recommend professional installation by qualified technicians with experience in automotive electrical systems and aftermarket vehicle equipment installation.

For additional product information, installation tips, or support, please contact your Gamber-Johnson representative at **+1 800.756.9198** or visit **www.gamberjohnson.com**.

PAGE	SECTION
1	Cover Page
2	Introduction
3	Table Of Contents
4	Components Included
5	Notes
6	Feature Identification
7	Port Identification
8-9	Safety Information
10	Installation
11	Docking & Undocking
12	Product Care
13	Specifications
14	Regulatory
15	Warranty

COMPONENTS INCLUDED



QTY	P/N	DESCRIPTION
1	7160-2127-XX	Docking Station



QTY	P/N	DESCRIPTION
1	7120-0430	Hardware Bag 1/4"-20 Nut and Washer

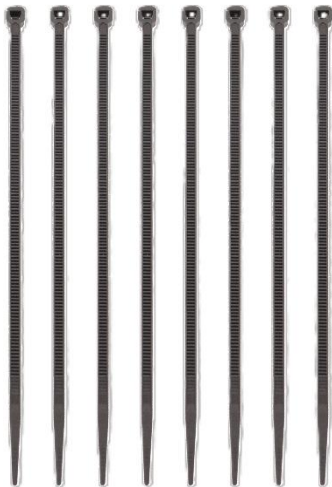

QTY	P/N	DESCRIPTION
1	7120-0542	Hardware Bag Cable Ties (5.6")



QTY	P/N	DESCRIPTION
1	N/A	Keys

This Product Guide is for the **Getac F120 Tablet Docking Station**.

Before you begin installation, please review all safety instructions to ensure proper setup. For instructions on computer features, setup, and operation, refer to your device’s manual.

This docking station is designed to work seamlessly with Gamber-Johnson’s extensive line of rugged mounting systems. Visit www.gamberjohnson.com/products to explore our full range of solutions and accessories. Installation instructions for additional Gamber-Johnson products are included with each individual product.

Important: Before installation, ensure you have the recommended power adapters to power the docking station. These can be ordered separately from Gamber-Johnson. Please refer to the list of compatible power supplies included below.

PRODUCT SELECTION	
MODEL NUMBER	DESCRIPTION
7300-0413	Lind Power Supply – Isolated, 12-32 Vdc Input, Bare Wire
7300-0412	Lind Power Supply – Isolated, 20-60 Vdc Input, Bare Wire
7300-0416	Lind Power Supply – Isolated, 72-110 Vdc Input, Bare Wire
7300-0471	Getac Power Supply – Auto, 12-32 Vdc Input, 19 Vdc 120-Watt Output, Cig Adapter
7300-0516	Getac Power Supply – Auto, 12-32 Vdc Input, 19 Vdc 120-Watt Output, Bare Wire

For additional product information, installation tips, or support, please contact your Gamber-Johnson representative at **+1 800.756.9198**.

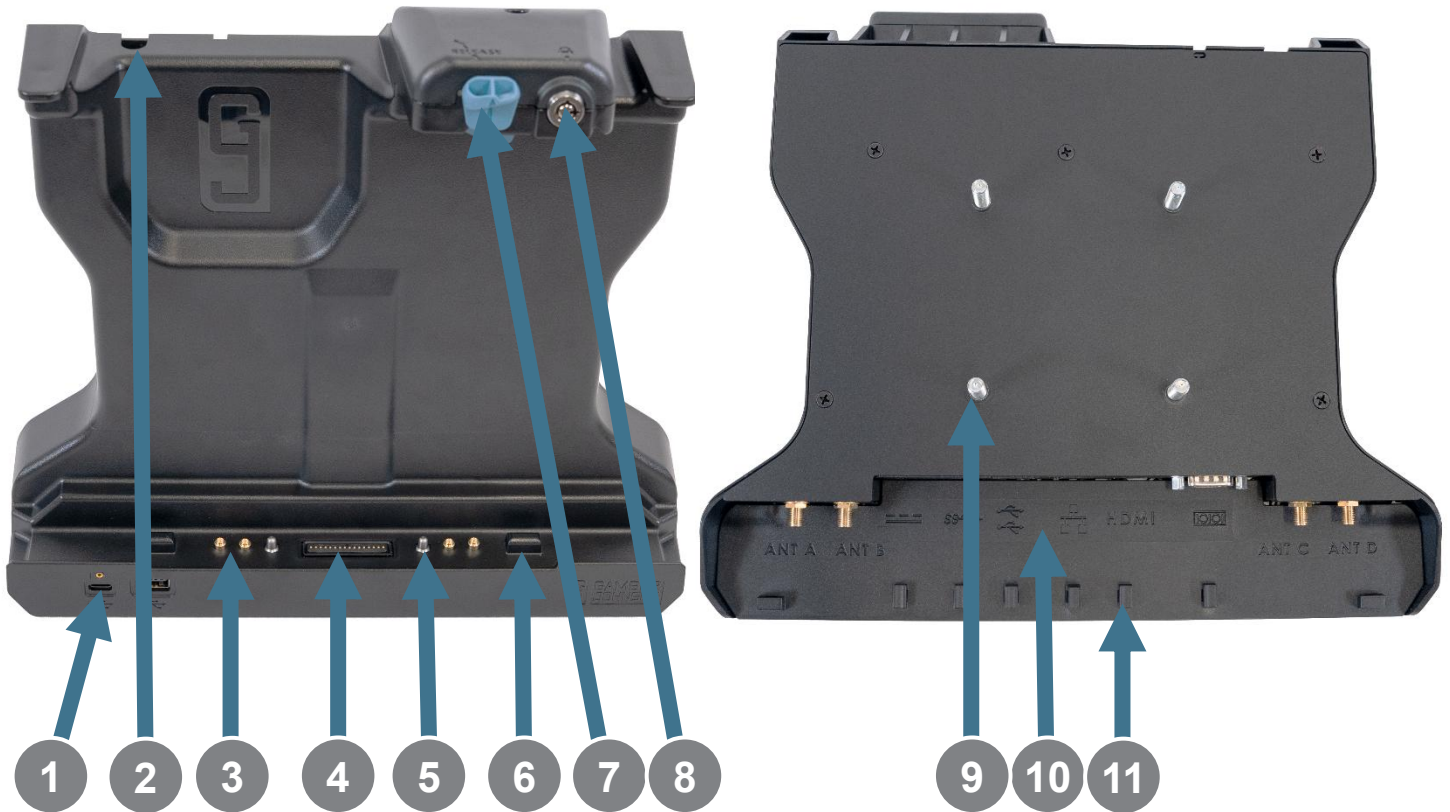

	DESCRIPTION
1	Front USB Ports
2	Stylus Holder
3	Quad Pass-through Antenna's (Optional, -04 and -14 Sku's only)
4	Floating Docking Connector
5	Guide Pins
6	Locating Guides
7	Thumb Latch
8	Keyed Lock
9	1/4"-20 Mounting Studs- VESA Pattern
10	Port Identification
11	Cable Restraints

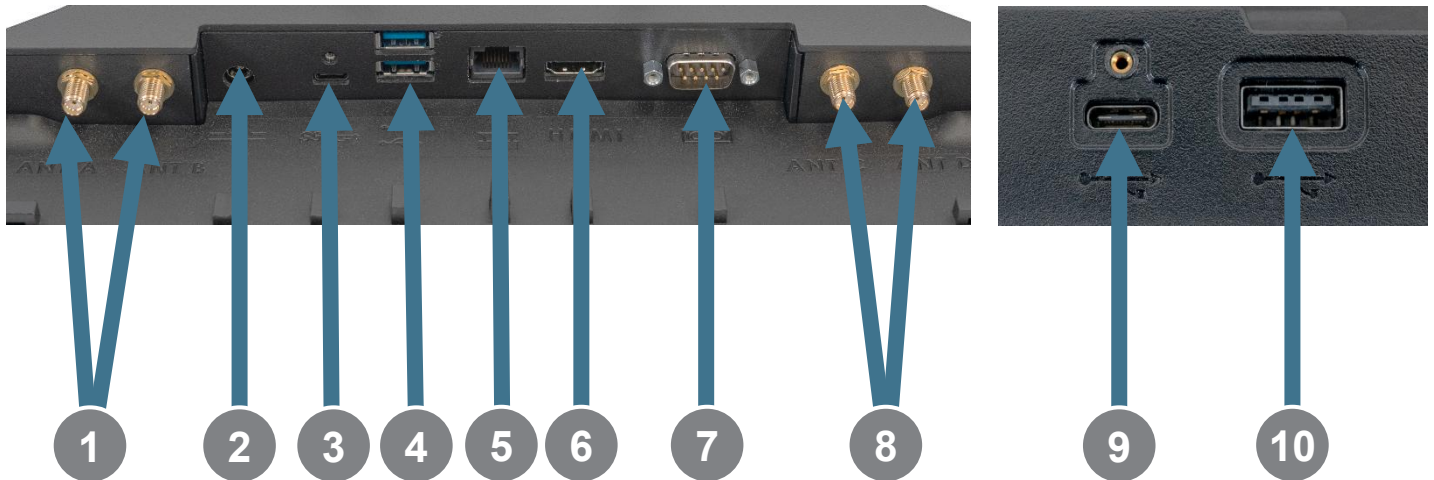

	DESCRIPTION
1	Pass-through SMA RF; Default Configuration: Ant A-WWAN MIMO, ANT B-WWAN Main (Optional, -04 and -14 Sku's only)
2	DC Power In – 19 Vdc, 120 Watt
3	USB-C 3.2
4	(2) USB-A 3.2
5	RJ45 Ethernet
6	HDMI (Optional, -00 and -04 Sku's only)
7	RS232 Serial (5V Powered On Pin 9)
8	Pass-through SMA RF; Default Configuration: ANT C-WLAN or WWAN Aux, ANT D-GPS (Optional, -04 and -14 Sku's only)
9	USB-C 2.0 (Front)
10	USB-A 2.0 (Front)

Safety is dependent on the proper installation and servicing of this docking station. It is important to read and follow all instructions before installing this product.

To properly install a Gamber-Johnson docking station you must have a good understanding of automotive electrical procedures and systems, along with proficiency in the installation and service of aftermarket vehicle equipment.

There are no adjustments required at any time of the electrical components within the docking station.

Opening the docking station will void the product warranty.

During Installation:

- Do not connect this docking station to the vehicle battery until:
 - All other electrical connections are made
 - Mounting of all components is complete
 - Verification that no shorts exist in the entire system

After Installation:

- Test the docking station to ensure that it is working properly.

General Safety Notes:

- Do not install equipment or route wires or cords in the deployment path of any air bag.
- When drilling into the vehicle, DO make sure that both sides of the surface are clear of anything that could be damaged.

CAUTION

If wiring is shorted to the frame, high current conductors can cause hazardous sparks resulting in electrical fires or flying molten metal.

WARNING

Failure to follow all safety precautions and instructions may result in property damage, serious injury, or death.

File these instructions in a safe place and refer to them when performing maintenance or reinstalling.

Conduct a "Bench Test"

Gamber-Johnson strongly advises a "bench test" be conducted to verify all electronic and software issues are resolved prior to installation:

Before Installation:

- Make sure the computer is operational by itself.
- Insert computer into the docking station and verify that the computer is operating in the dock.
- Interconnect entire assembly and verify start-up of all components, including other equipment (printers, modems, scanners, etc.)

Gamber-Johnson recommends positioning of all mounts and equipment in the vehicle prior to the actual install to verify that mounting locations are safe and practical.

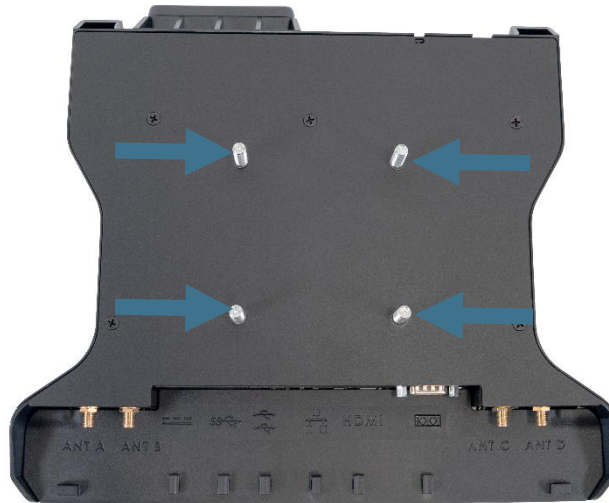

Figure 1

1. A mount with a VESA 75 pattern is required to mount the dock using the 1/4"-20 mounting studs on the rear of the dock. (Figure 1)
2. Attach the dock to the selected mount using the 1/4"-20" hardware from the 7120-0430 Hardware Bag.



Figure 2

1. Use cable ties provided in hardware bag 7120-0542 to secure each port cable to the specific strain relief feature on the dock. (Figure 2)
2. Route the cables in the direction providing the least strain on them.
3. Use cable ties to secure bundled cables for improved routing.

Operation: Docking

1. Insert the bottom of the tablet into the docking station. (Figure 1)
2. Rotate the top of the tablet under the top latch until the tablet is resting inside the main housing. The latch will spring down in front of the tablet to hold it in place. (Figure 2)
3. (Optional) Turn the lock 90 degrees CCW to lock the tablet in dock. (Figure 3)



Figure 1



Figure 2

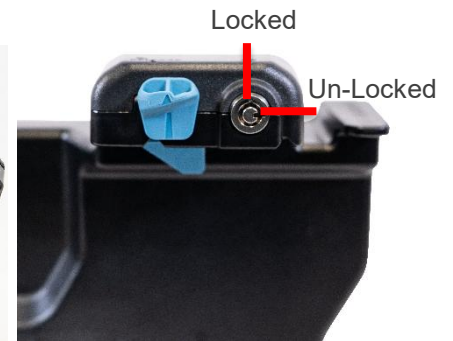

Figure 3

Operation: Un-Docking

1. Unlock the dock if previously locked. Turn the lock 90 degrees CW.
2. Push upward on the thumb latch and pull outward on the top of the tablet until it clears the latch. (Figures 4 and 5)
3. Lift the tablet up and out of the docking station. (Figure 6)



Figure 4



Figure 5



Figure 6

Recommended Supplies:

Compressed Air (Canned or Low-Pressure Compressor)

Electronics Cleaner

ESD Swabs

Anti-static Soft Bristle Brush

70% Isopropyl Alcohol Solution

Soft Cleaning Cloth

1. In order to prevent electronic shorts, always disconnect power and devices from the docking station before cleaning.
2. Use compressed air to blow any excess dust from connector area. Use an anti-static brush to gently brush away dirt from connector area.
3. If the docking station has caked on dirt/dust, use Electronics Cleaner and an ESD Swab to gently clean connector. **Always disconnect power and devices from dock when using electronics cleaner to prevent shorts.**
4. The body of the docking station may be cleaned with a soft cleaning cloth dampened slightly with Isopropyl Alcohol solution. Use caution to not contact the electrical connector or any other electronic connections. Do not use other chemicals or abrasives.
5. Let the docking station dry completely before reconnecting power and devices.

WEIGHT

2.6 lbs

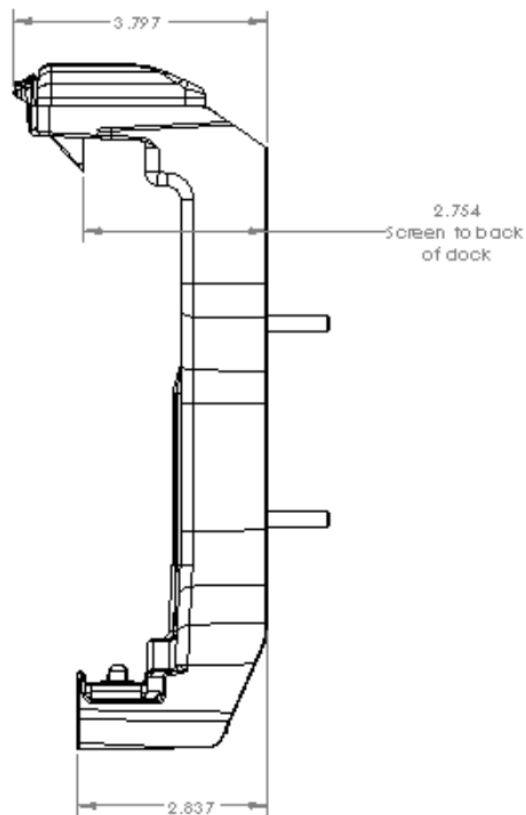
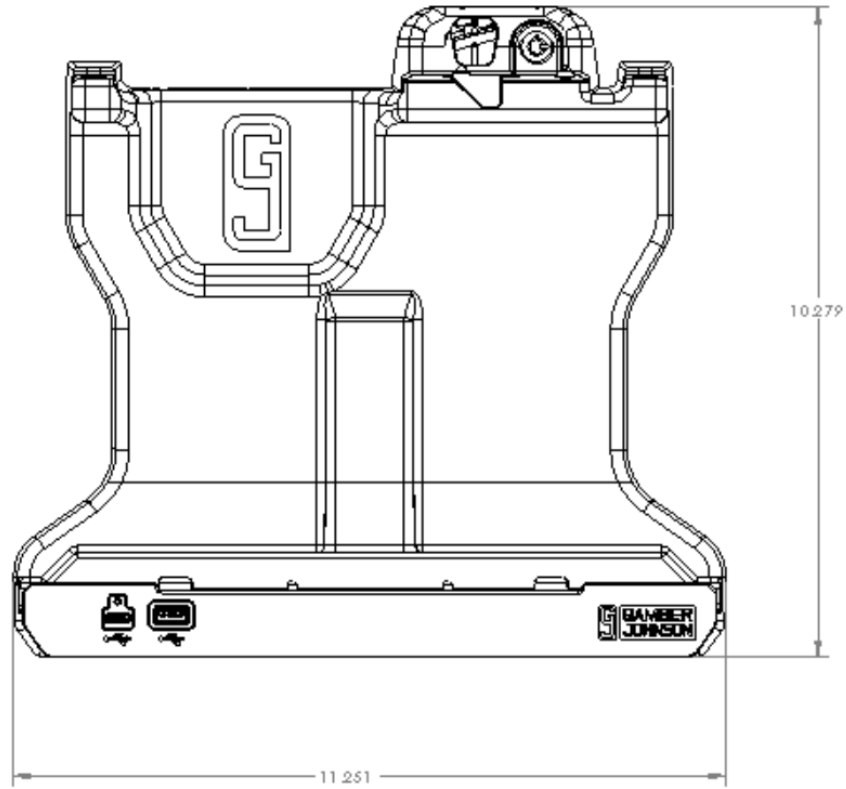

REGULATORY MODEL #: 7160-2127

GAMBER JOHNSON MODEL #'s & DESCRIPTION:

- 7160-2127-00 DOCK – GETAC F120 - NO RF
- 7160-2127-04 DOCK – GETAC F120 - QUAD RF
- 7160-2127-10 DOCK – GETAC F120 - LITE - NO RF
- 7160-2127-14 DOCK – GETAC F120 - LITE - QUAD RF

CERTIFICATIONS

- EN 50498:2010
- EN 55032:2015/A11:2020
- AS/NZS CISPR 32:2015
- FCC 47 CFR Part 15 Subpart B
- ICES-003, Issue 7:2020 Class B



10R-06-15905

This device complies with Part 15 of the FCC Rules. Operation is subject to the following two conditions. (1) this device may not cause harmful interference, and (2) this device must accept any interference received, including interference that may cause undesired operation.



SCAN HERE TO VIEW WARRANTY INFORMATION

www.gamberjohnson.com/product-services/warranty-information

Product Mounting Disclaimer

Gamber-Johnson is not liable under any theory of contract or tort law for any loss, damage, personal injury, special, incidental or consequential damages for personal injury or other damage of any nature arising directly or indirectly as a result of the improper installation or use of its products in vehicle or any other application. In order to safely install and use Gamber-Johnson products full consideration of vehicle occupants, vehicle systems (i.e., the location of fuel lines, brake lines, electrical, drive train or other systems), air-bags and other safety equipment is required. Gamber-Johnson specifically disclaims any responsibility for the improper use or installation of its products not consistent with original vehicle manufactures specifications and recommendations, Gamber-Johnson product instruction sheets, or workmanship standards as endorsed through the Gamber-Johnson Certified Installer Program.

© Copyright 2025 Gamber-Johnson, LLC

QUESTIONS OR NEED MORE INFORMATION?

NO PROBLEM, WE'RE HERE TO HELP!

Call us at: **+1 800.756.9198**

Email us at: sales@gamberjohnson.com

Visit www.gamberjohnson.com to see our complete line of solutions and hang with us on social media at [@gamberjohnson](https://www.instagram.com/gamberjohnson)