



# PRODUCT GUIDE

## RIVIAN R1S AND R1T PUSH BUMPER

### PRODUCT NUMBER(S)

7170-1189

7160-2220

7160-2221



For more language options and/or questions, please contact a Gamber-Johnson representative at **+1 800.756.9198**

Since 1954, we have been dedicated to providing **RUGGED**, **RELIABLE**, and **RESPONSIVE** solutions that empower professionals in the field.

## Thank you for choosing Gamber-Johnson.

Welcome to your new **Gamber-Johnson Push Bumper**—engineered for **mission-critical reliability** in the toughest environments. At Gamber-Johnson, we understand that your technology is more than a tool; it's a lifeline. That's why our rugged mounting solutions and docking stations are designed to integrate seamlessly with your equipment, ensuring **secure connections** and **reliable performance** wherever your job takes you.

This guide will walk you through the safe and effective installation of your **Push Bumper**.

Inside, you'll find:

- Inventory list of what's included
- Step-by-step installation instructions
- Images for easy reference
- Essential safety information to ensure proper setup and operation

Our commitment to **quality**, **durability**, and **rugged reliability** is built into every product we make.

**Important:** Before you begin, please carefully review all safety instructions provided in this guide. For vehicle applications, we recommend professional installation by qualified technicians with experience in automotive electrical systems and aftermarket vehicle equipment installation.

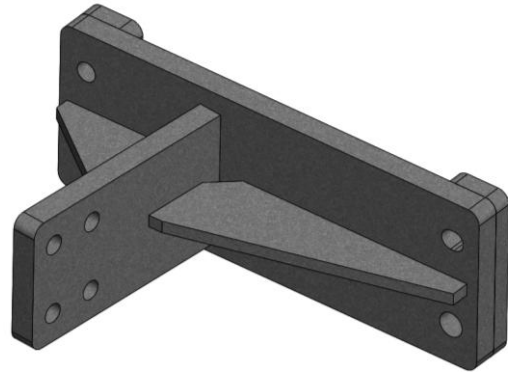
For additional product information, installation tips, or support, please contact your Gamber-Johnson representative at **+1 800.756.9198** or visit **[www.gamberjohnson.com](http://www.gamberjohnson.com)**.

<b>PAGE</b>	<b>SECTION</b>
1	<b>Cover Page</b>
2	<b>Introduction</b>
3	<b>Table Of Contents</b>
4	<b>Components Included</b>
5	<b>Optional Accessories</b>
6	<b>Safety Information</b>
7-19	<b>Installation</b>
20	<b>Use</b>
21	<b>Warranty</b>

# COMPONENTS INCLUDED



QTY	P/N	DESCRIPTION
1	7160-2210	Push Bumper Main Weldment



QTY	P/N	DESCRIPTION
2	22638	Bumper Bracket



QTY	P/N	DESCRIPTION
2	22082	Joiner Bracket



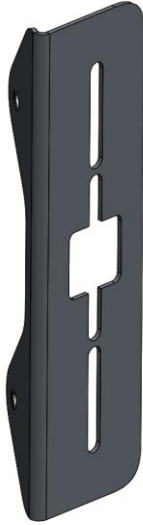
QTY. 16

QTY. 16

QTY. 8

QTY	P/N	DESCRIPTION
1	7120-1307	Push Bumper Hardware Bag

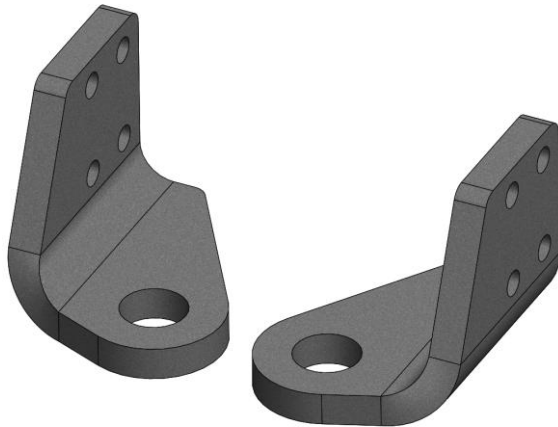
## 7160-2221 SIDE LIGHT BRACKET KIT



QTY	P/N	DESCRIPTION
2	22641	Side Light Bracket

QTY	P/N	DESCRIPTION
1	7120-1314	Side Light Bracket Hardware Bag

## 7160-2220 TOW HOOK KIT



QTY	P/N	DESCRIPTION
1	22660	Passenger Side Tow Hook
1	22661	Driver Side Tow Hook

QTY	P/N	DESCRIPTION
1	7120-1313	Tow Hook Hardware Bag

## NOTICE

The images and instructions in this guide are for the Gen 2 Rivian R1 Series vehicles. When installing this product on a Gen 1 vehicle there may be some differences.

## WARNING

You must read and follow all of these installation instructions. Failure to follow the installation instructions may result in serious bodily injury or death

DO NOT install or use this assembly in the area in which the airbag on the vehicle may be deployed. The installer and user of this assembly are responsible for installing and using this assembly outside the area in which an airbag may be deployed. (See Product Mounting Disclaimer Below)

If the installation of the equipment requires that the equipment (or any additional equipment that is added to the installation) be placed in front of an airbag, the airbag should be deactivated. In order to secure permission for deactivating the airbag you must contact the National Highway Traffic Safety Administration at 1-800-424-9393 to gain permission to do so. If you have any questions or need assistance, call Gamber-Johnson at **+1 800-456-6868**.

High speed vehicle turns may cause parts of the assembly to swivel, interfering with the driver or other equipment.

Keep these installation instructions with the product and readily available in the vehicle for future reference of other users of the product.

Additional copies of the installation instruction can be obtained from Gamber-Johnson. If you need assistance or have any questions, go to [www.gamberjohnson.com](http://www.gamberjohnson.com) or call Gamber-Johnson at **+1 800-456-6868**.

DO NOT remove any warning labels from the product under any circumstances.

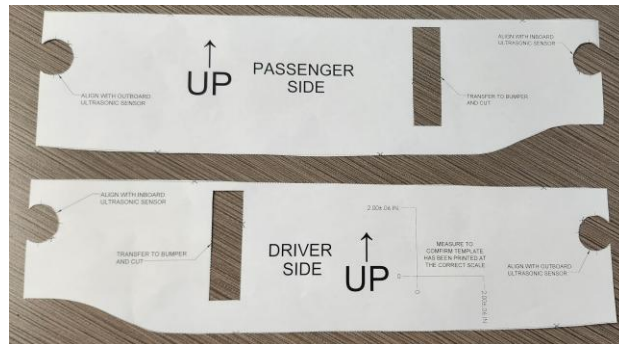
## CAUTION

Before beginning any work, read these instructions in entirety.

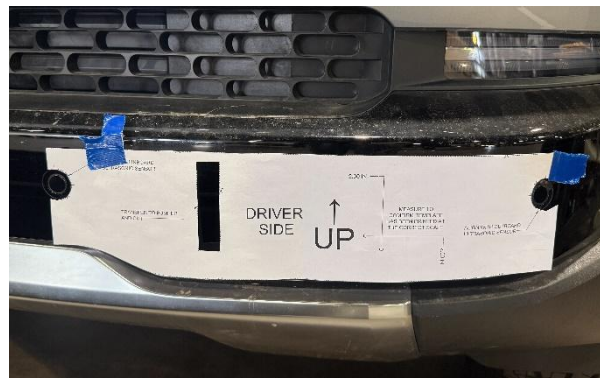
Some clips and fasteners may become damaged or may break during this process. Replace any that are broken or damaged.

## NOTICE

If your vehicle did not come with factory tow hooks follow the steps below, otherwise skip to next page.



1. Cut out the provided bumper cut template following the indicated lines.



2. Lay the templates on the bumper aligning with ultrasonic sensors, secure with tape.



3. Transfer the rectangular opening of template to the bumper.
4. Remove the templates and trim the areas transferred.



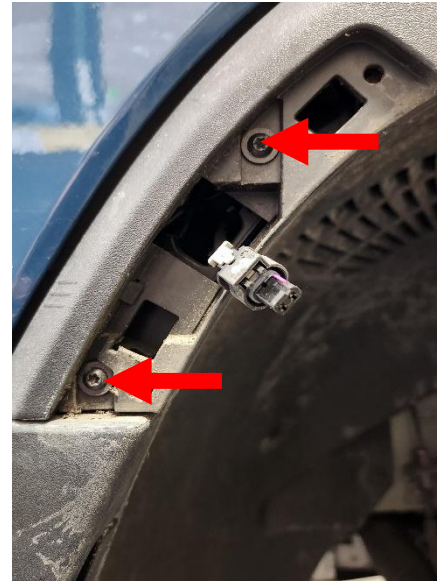
1. Set ride height to the highest setting.
2. Turn the steering wheel fully to the left from center.



**Figure 1**

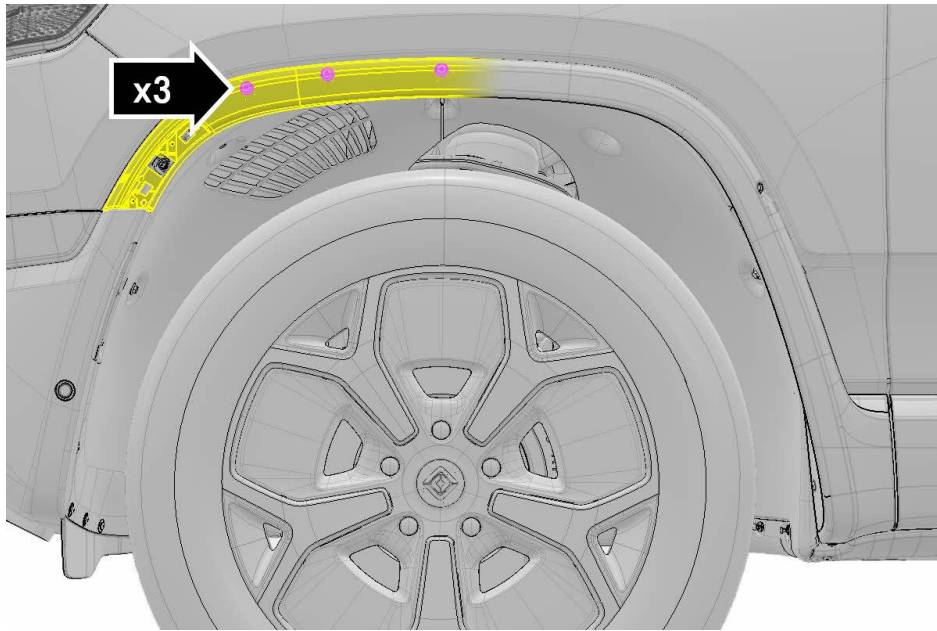


**Figure 2**



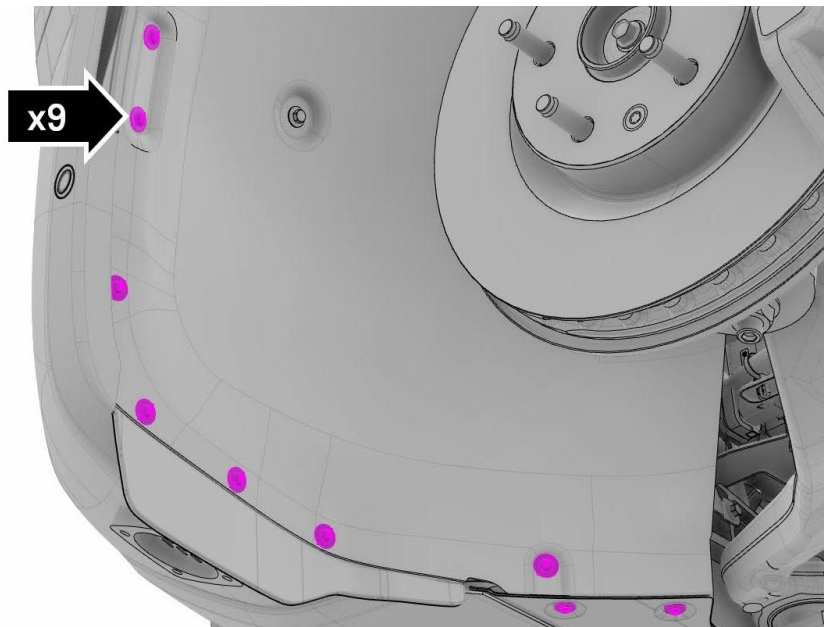
**Figure 3**

1. On the driver side of the vehicle, gently pry the front side marker from the wheel liner. (Figure 1)
2. Unplug the electrical connect from the marker light. (Figure 2)
3. Remove the 2 bolts securing the wheel liner. (Figure 3)



**Figure 4**

1. Gently pry the highlighted portion of the wheel liner from the fender. Remove the 3 bolts underneath. (Figure 4)
2. Removal of the wheel/tire is not required if on a lift or in the highest ride height setting.



**Figure 5**

1. Remove the 9 bolts from the wheel liner. (Figure 5)

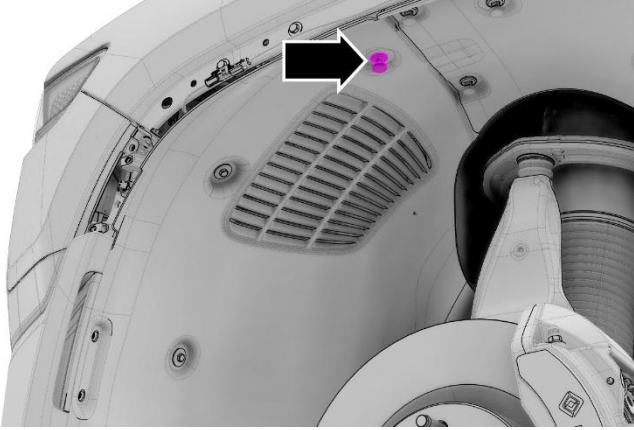


Figure 6

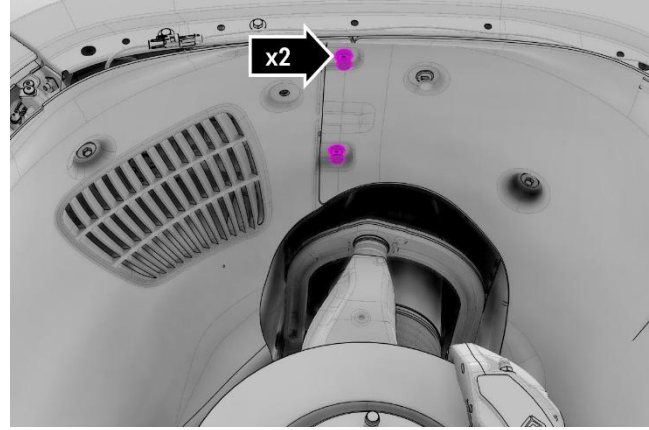


Figure 7

1. Remove the 3 push retainer clips from the wheel liner. (Figures 6 and 7)

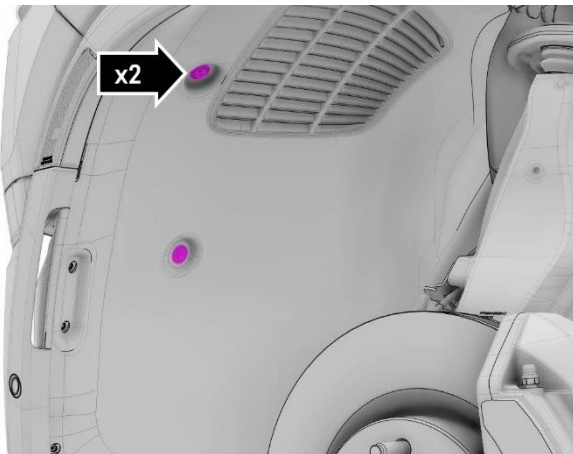


Figure 8

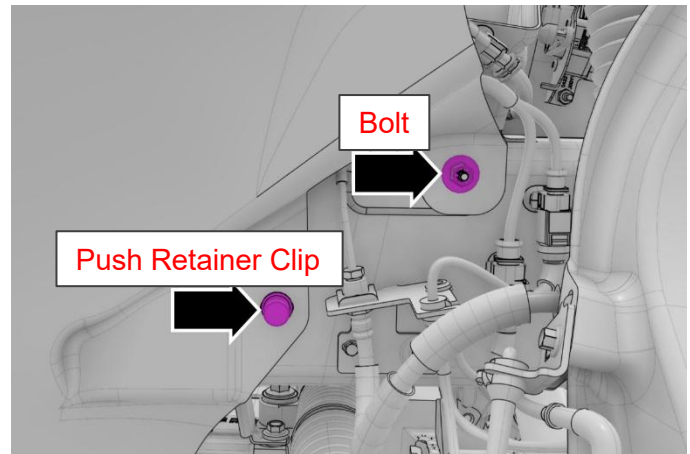


Figure 9

1. Remove the 2 bolts from the wheel liner. (Figure 8)
2. Remove the 1 push retainer clip and the 1 bolt from the wheel liner. (Figure 9)
3. Rotate the steering wheel fully to the right.
4. Perform the previous steps on the passenger side of the vehicle.

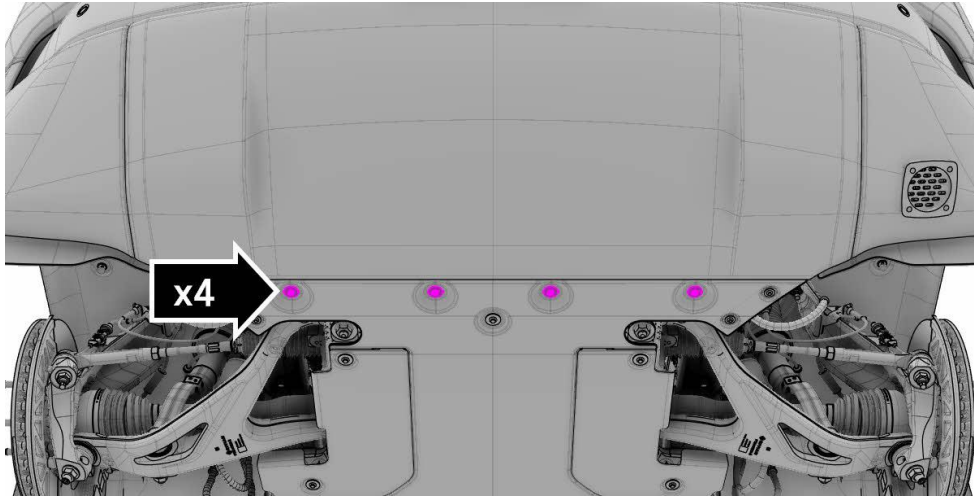


Figure 10

1. From under the front of the vehicle, remove the 4 bolts. (Figure 10)

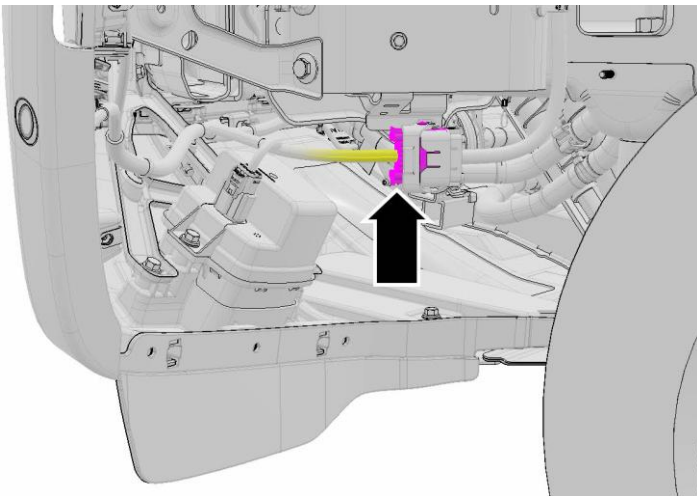


Figure 11

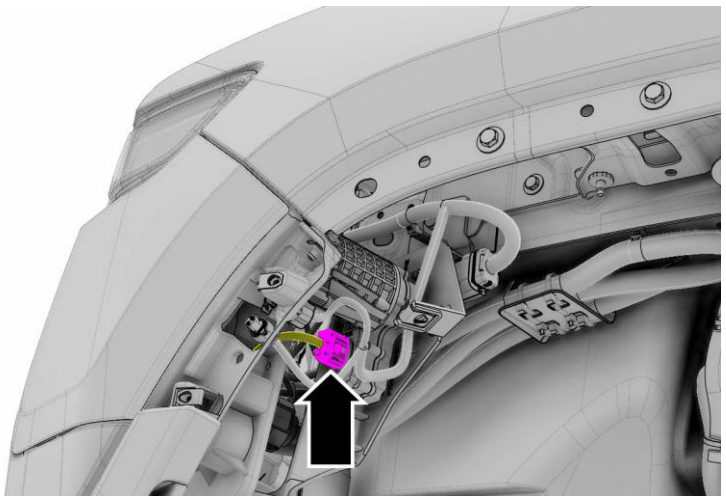
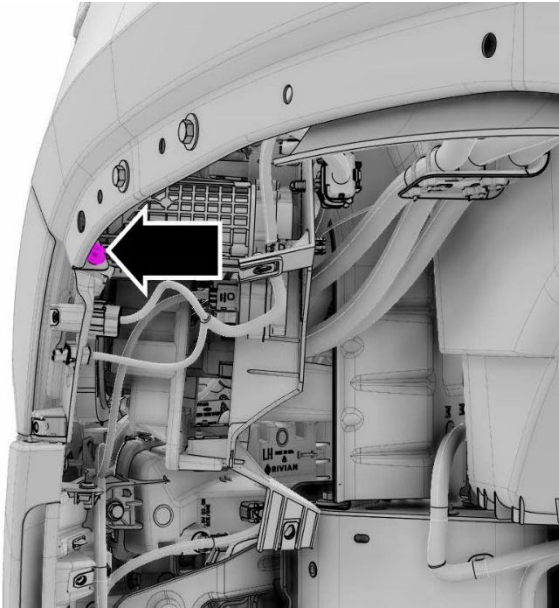
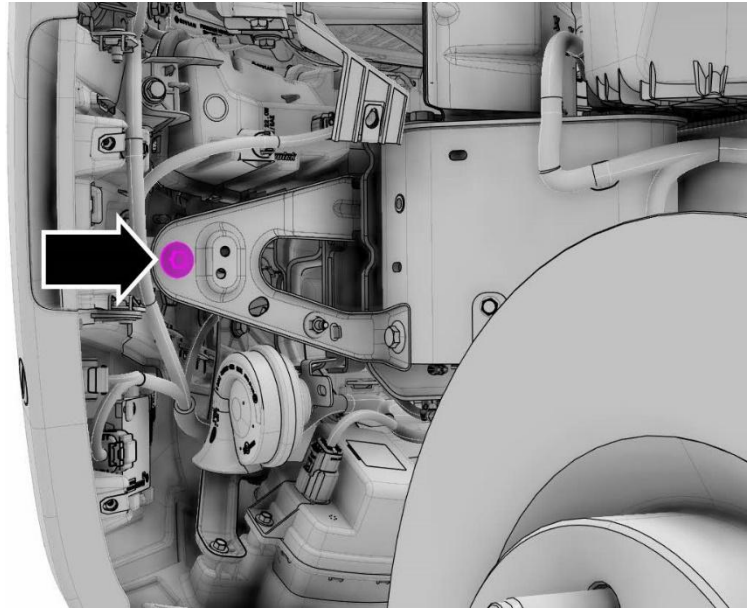


Figure 12

1. On the driver's side of vehicle disconnect the electrical connectors shown. (Figure 11 and 12)

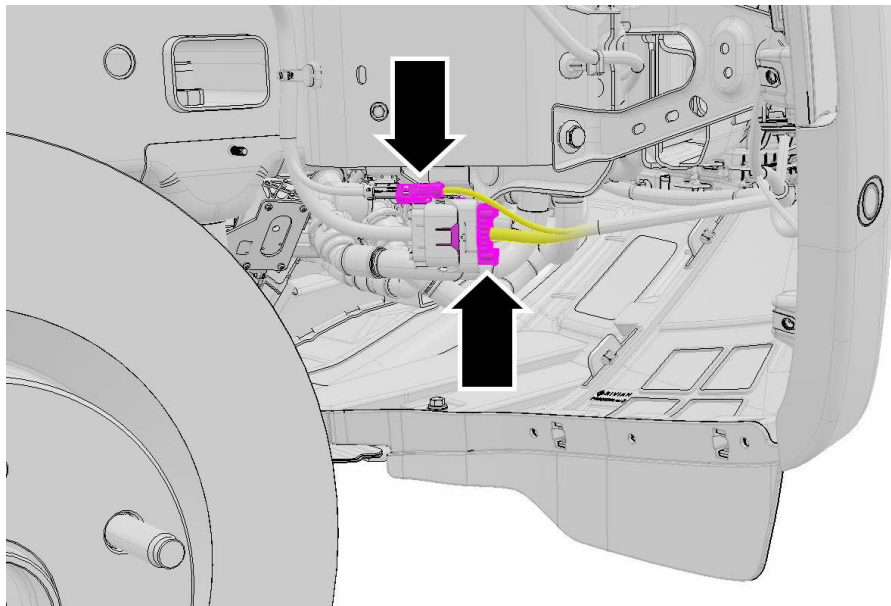


**Figure 13**



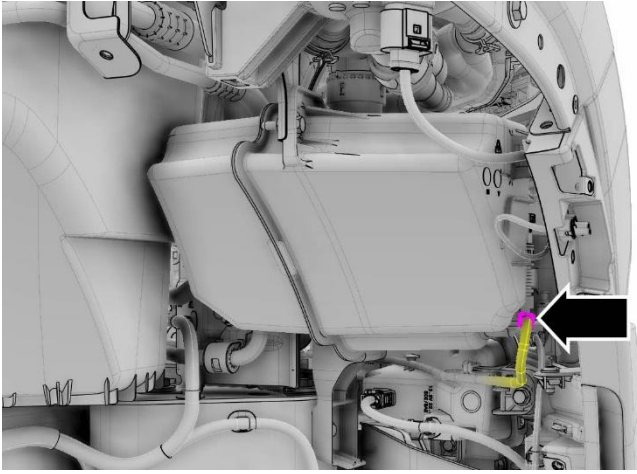
**Figure 14**

1. On both sides of the vehicle remove the bolt securing the fender to the fascia. (Figure 13)
2. On both sides of the vehicle remove the bolt securing the fascia to the support bracket. (Figure 14)

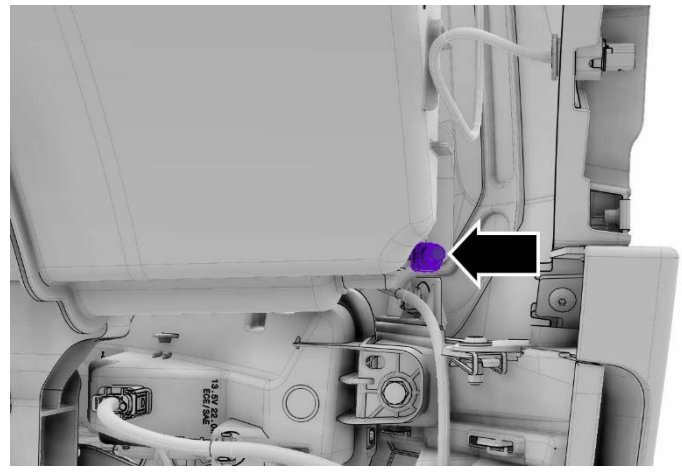


**Figure 15**

1. On the passenger side of the vehicle disconnect the 2 electrical connectors shown. (Figure 15)

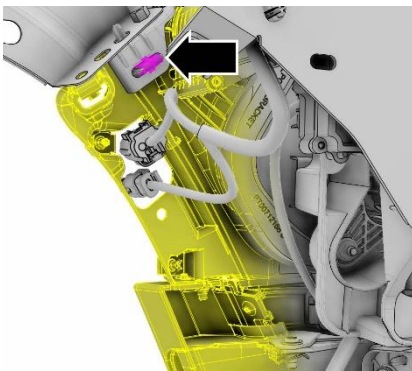


**Figure 16**

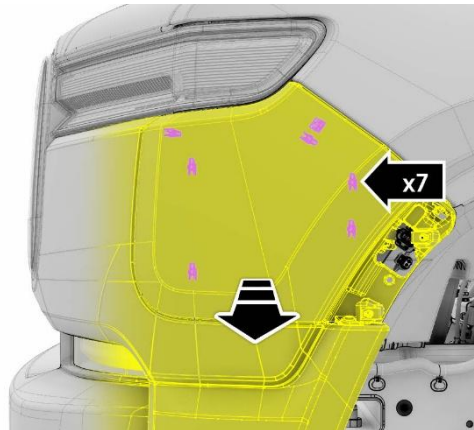


**Figure 17**

1. If equipped with Fog Lamp Washer, on the passenger side of the vehicle place a clean drain pan under the washer fluid reservoir.
2. Disconnect the highlighted washer fluid tube from the reservoir. (Figure 16)
3. If available, use plug to prevent reservoir from emptying. (Figure 17)



**Figure 18**

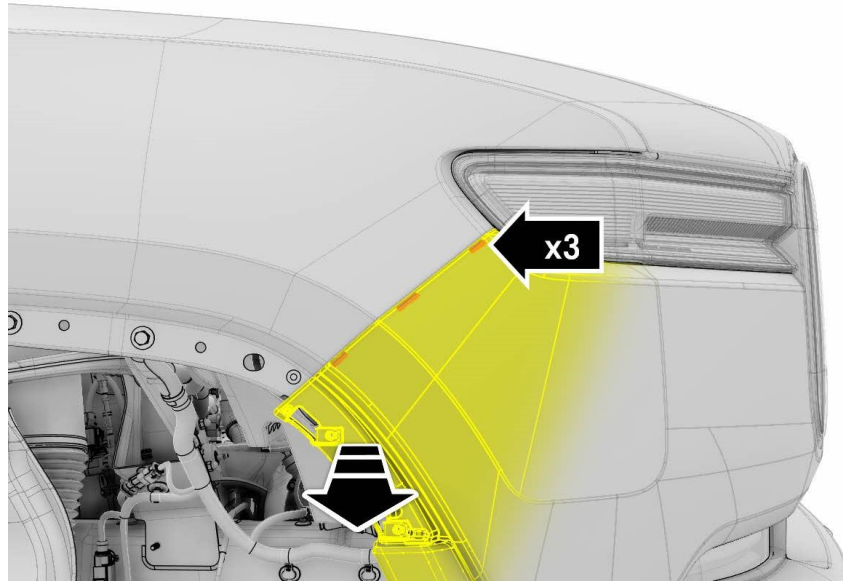


**Figure 19**



**Figure 20**

1. In the driver's side wheel well, gently pry near the highlighted clip to release the fascia from the fender. (Figure 18)
2. Open the charge port for access to release the 7 clips highlighted surrounding the charge port by gently prying them loose. (Figures 19 and 20)

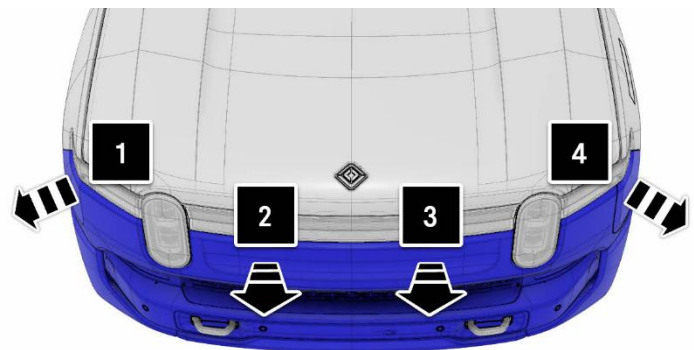


**Figure 21**

1. On the passenger side gently pry near the 3 highlighted clips to release the fascia from the fender. (Figure 21)

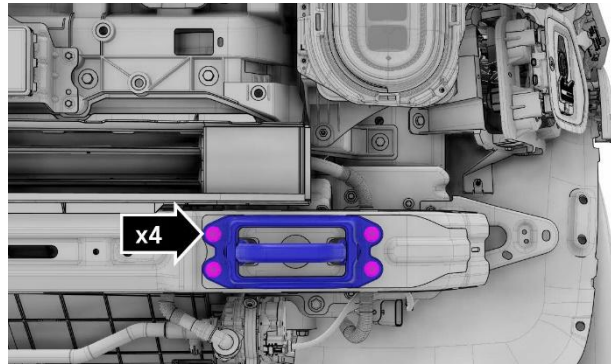


**Figure 22**



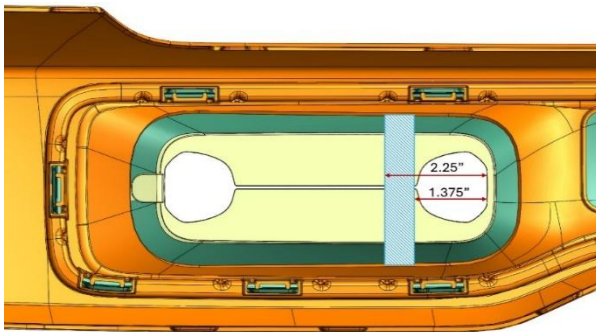
**Figure 23**

1. Starting from the outside edges and working towards the center of the vehicle, gently pry near the highlighted clips to release the fascia. (Figure 22)
2. Gently pull the fascia from the body of the vehicle in the sequence and directions shown. (Figure 23)

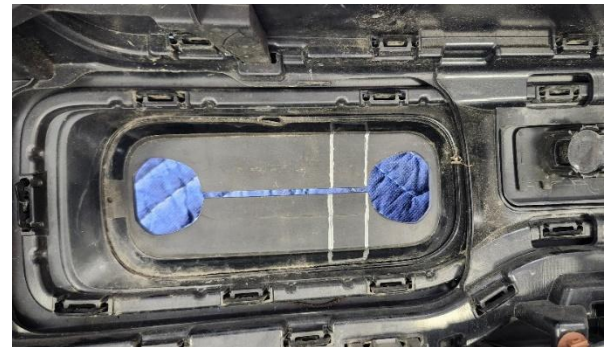


**Figure 24**

1. If equipped with factory tow hooks, remove the 4 bolts securing the tow hook on each side. (Figure 24; Drivers side shown, repeat for passenger side)
2. If not, skip to next page.



**Figure 25**



**Figure 26**

1. If equipped with factory tow hooks, lay bumper fascia facedown on soft surface to prevent damage.
2. Trace according to Figure 25 & Figure 25. (Drivers side shown. Repeat for passenger side.)



**Figure 27**



**Figure 28**

3. Cut fascia following marked lines (Figure 27 Drivers side, Figure 28 Passenger side)

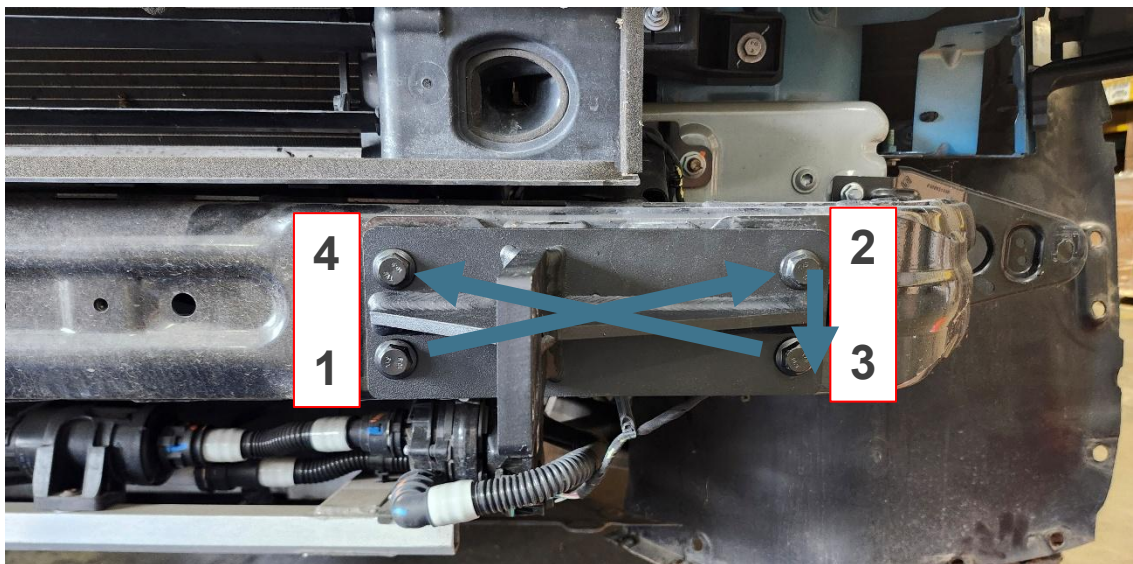


Figure 29

1. Install push bumper brackets using provided M10 hardware from 7120-1307 hardware bag. Torque bolts to 43 ft/lbs following the order above. (Figure 29; Drivers side shown, repeat for passenger side)



**Figure 30**

1. Reinstall front fascia using the steps described on pages 8-14 of instruction manual. (Figure 30)



**Figure 31**



**Figure 32**

1. Install joiner brackets using provided 3/8 flange bolts and serrated flange nuts, leave hardware loose until bumper is installed. (Figure 31)
2. If 7160-2221 tow hook accessory was purchased, install using hardware from hardware bag 7120-1313 provided with tow hooks. (Figure 32)



Figure 33

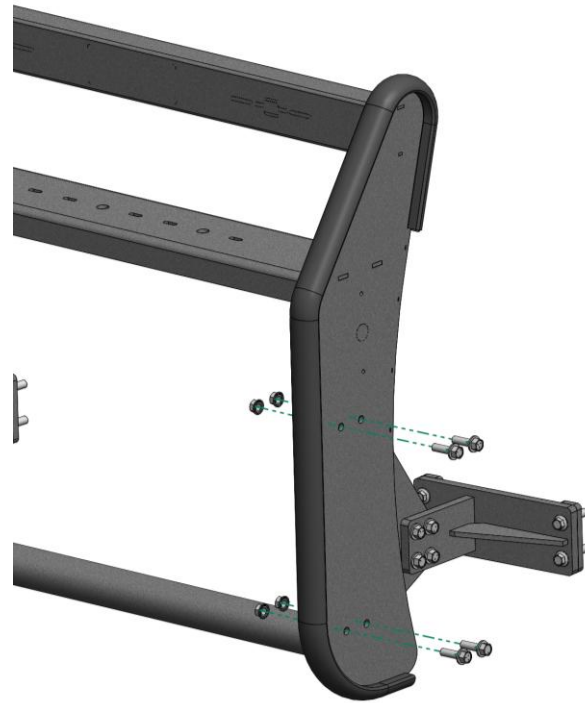


Figure 34

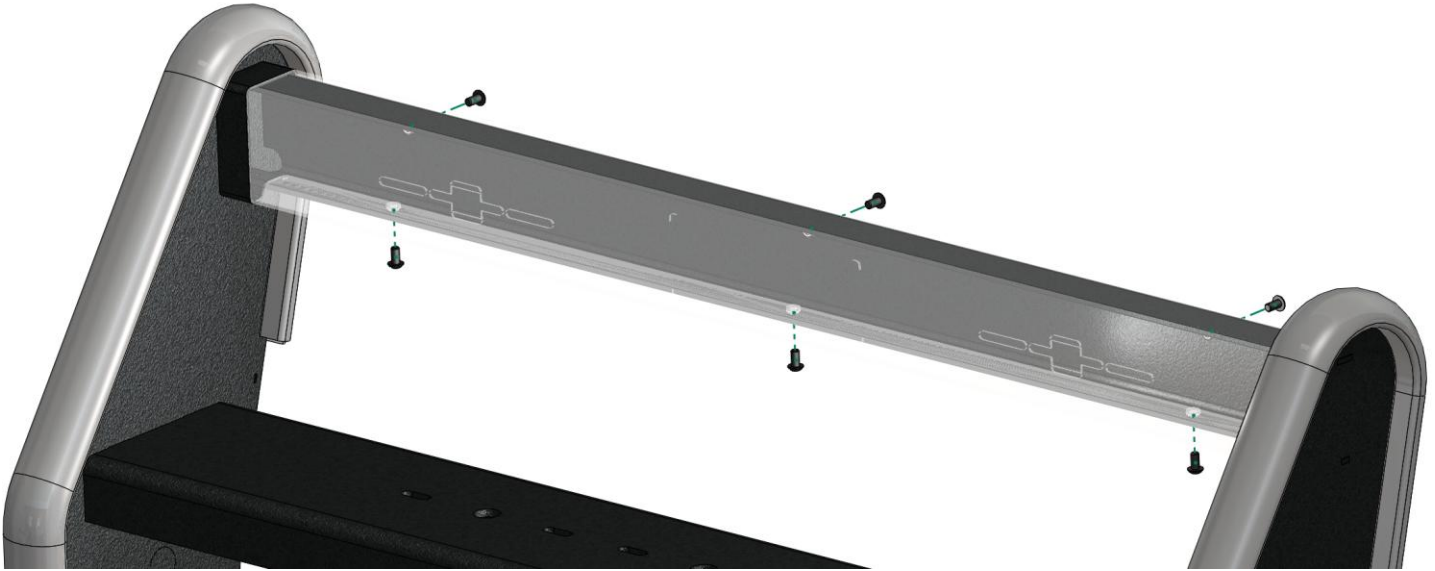
1. Install push bumper main weldment using provided 3/8 flange bolts and serrated flange nuts. (Figures 33 and 34)



Figure 35

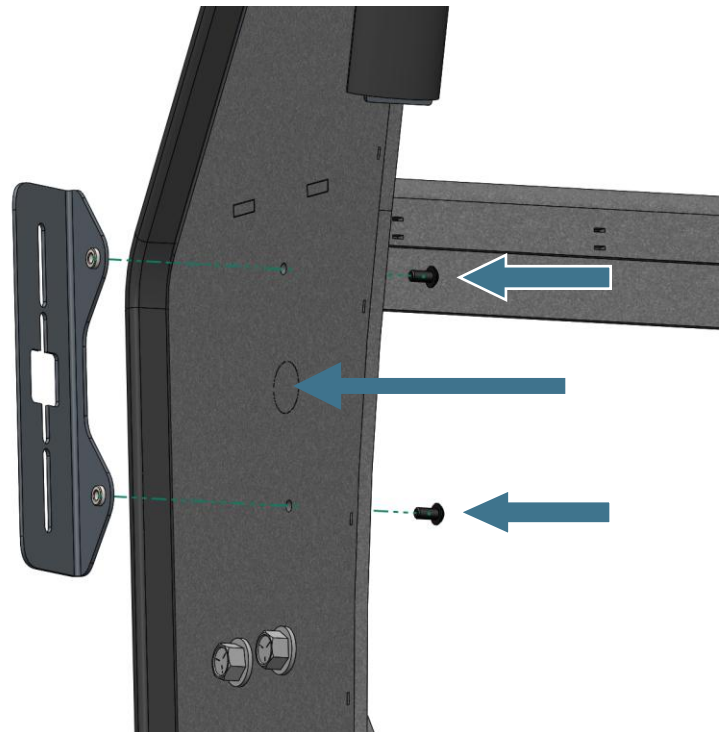
1. All 3/8 fasteners can be tightened, installation is complete. (Figure 35)

## Auxiliary Lighting Install



1. Remove top light bar cover by unfastening the (6) button head screws.
2. Using auxiliary light as a reference, knockout corresponding locations to allow for installation.
3. Reinstall the light bar.

1. If 7160-2220 light bracket accessory was purchased, install using hardware from hardware bag 7120-1314 provided with bracket.
2. If needed, knock out wire passthrough.



**WARNING** Failure to follow tow hook guidelines laid out below may results in damage to the Gamber-Johnson product or the vehicle.

## Tow Hook Connection

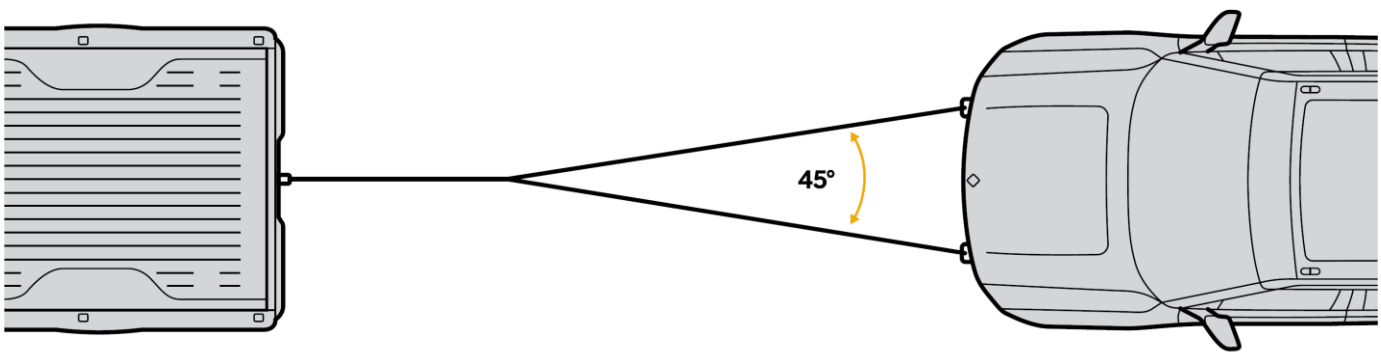
A shackle with a 7/8" pin must be used to connect straps or chains to the tow hooks,



## Tow Hook Angles

A snatch block or bridle should be used in the configuration shown below

**DANGER** A single-line should not be attempted.





**SCAN HERE TO VIEW WARRANTY INFORMATION**

[www.gamberjohnson.com/product-services/warranty-information](http://www.gamberjohnson.com/product-services/warranty-information)

#### **Product Mounting Disclaimer**

Gamber-Johnson is not liable under any theory of contract or tort law for any loss, damage, personal injury, special, incidental or consequential damages for personal injury or other damage of any nature arising directly or indirectly as a result of the improper installation or use of its products in vehicle or any other application. In order to safely install and use Gamber-Johnson products full consideration of vehicle occupants, vehicle systems (i.e., the location of fuel lines, brake lines, electrical, drive train or other systems), air-bags and other safety equipment is required. Gamber-Johnson specifically disclaims any responsibility for the improper use or installation of its products not consistent with original vehicle manufactures specifications and recommendations, Gamber-Johnson product instruction sheets, or workmanship standards as endorsed through the Gamber-Johnson Certified Installer Program.

© Copyright 2026 Gamber-Johnson, LLC

## **QUESTIONS OR NEED MORE INFORMATION?**

### **NO PROBLEM, WE'RE HERE TO HELP!**

Call us at: **+1 800.756.9198**

Email us at: [sales@gamberjohnson.com](mailto:sales@gamberjohnson.com)

Visit [www.gamberjohnson.com](http://www.gamberjohnson.com) to see our complete line of solutions and hang with us on social media at [@gamberjohnson](https://www.instagram.com/gamberjohnson)